

# Solar + LED Floodlight™ 800

Solar + Reflector LED™ 800

Solaire + Projecteur DEL<sup>MC</sup> 800



## User's Manual

We are constantly improving our products so specifications are subject to change without notice.

# Solar + LED Floodlight™ 800 by Wagan Tech®

Thank you for purchasing the Solar + LED Floodlight 800™ by Wagan Tech®. With normal care and proper treatment, it will provide years of reliable service. Please read all operating instructions carefully before use.

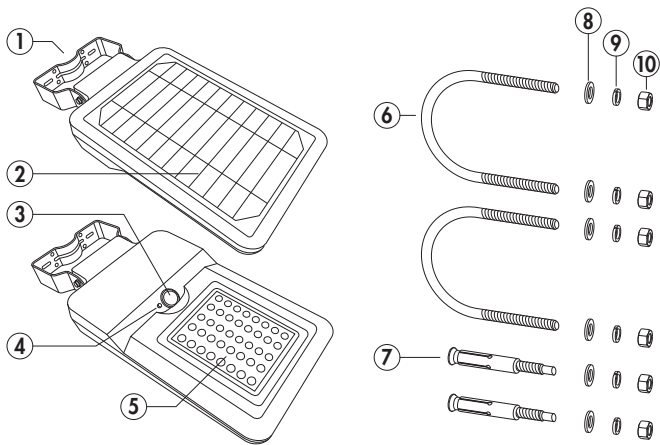

1. Mounting plate
2. Solar panel
3. PIR detector
4. Startup button
5. Light panel

6. U-bolt
7. Expansion bolt
8. M6 flat washer
9. M6 spring washer
10. M6 nut



## SPECIFICATIONS

Solar panel	7.0W, mono-crystalline silicon
Battery	3.7V, 6.0 Ah, Li-ion
LED count	40
Brightness (Lumens)	800 lm max
Recharge time	6 hours full sunlight
Lighting time	3 nights
Waterproof	IP65
Install height	8–11 ft (2.5~3.5 m)
Materials	PCB, poly-carbonate plastic, ABS plastic, glass
Size	17.0 × 7.5 × 2.0 inches (432 × 191 × 51 mm)
Working temperature	-4 °F to 122 °F (-20 °C to 50 °C)
Warranty	1 year

## FEATURES

- Flexible installation: pole or wall mounted
- Wide area lighting
- Adjustable installation angle
- Motion activating PIR sensor
- Energy saving lighting program
- Automatic On/Off

## APPLICATIONS

Suitable for outdoor wall or pole installation in plazas, parks, gardens, courtyards, streets, walkways, pathways, campuses, airfields, farms, and perimeter security.

## INITIAL ACTIVATION

Activate the light by pressing the button on the underside of the light (as shown below).

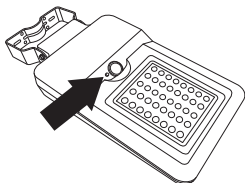

## DEVICE INSTALLATION

### Pole installation

As the below image shows: Take out the bolts and washers from the accessories bag for pole installation and attach the light to the pole with the U-bolts.

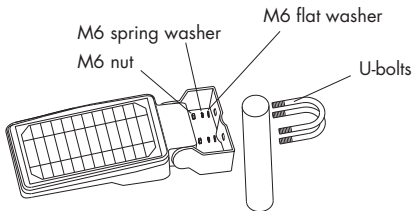

## Wall installation

First, remove the U-bolts. Make 2 holes in the wall and take out the expansion bolt and washer. Attach the light onto the wall.

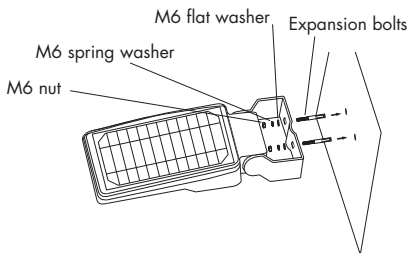

Please install the solar panel in a place without any shade and facing direct sunlight for better charging.

*After installation, the light angle can be adjusted.*

As shown in the diagram below.

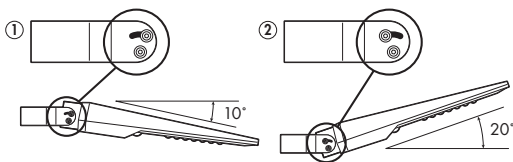

## OPERATION

### First 5 hours:

800 lumens when motion is detected; dims to 100 lumens 20 seconds after no motion.



### After 5 hours (or when battery is below 30%):

800 lumens when motion is detected; dims to 100 lumens 20 seconds after no motion; turns off after 5 minutes of no motion.

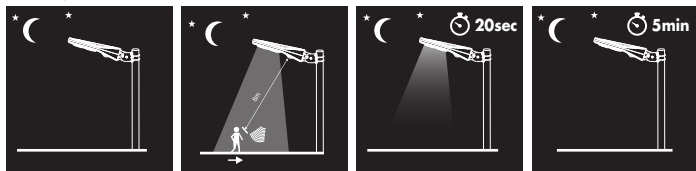

### SPECIAL NOTE

- Please allow solar panel to charge in bright sunlight for over 5 hours before first time use.
- If the sunlight is not strong enough, it may take longer to fully charge the light. This is normal for solar products.

### WARNINGS

- Keep the device away from fire and oil in order to avoid any explosion hazards.
- Avoid severe shock or impact.
- No one except professional technicians should attempt to disassemble the light in order to avoid damaging the light.

### PACKAGE INCLUDES

Floodlight

2 × U-bolts

6 × M6 flat washers

6 × M6 spring washers

6 × M6 nuts

2 × Expansion Bolts