

MTB DRAGON 5 SRS MATT



SIZE	39-39,5-40-40,5-41-41,5-42-42,5-43-43,5-44-44,5-45-45,5-46-46,5-47-48
UPPER	MICROFIBRE TECHPRO
SOLE	MTB SRS CARBON COMPOSITE SOLE

COLOUR



MATT RED | BLACK



MATT BLACK



MATT ORANGE / BLACK

TECNOLOGY

MTB SRS CARBON COMPOSITE SOLE

.. In 1999, SIDI revolutionized mountain bike shoe design with the SOLE REPLACEMENT SYSTEM (SRS), owing mountain bikers to replace the most wear-heavy part of the shoe—the sole. The MTB SRS CARBON COMPOSITE Sole consists of four inserts screwed, easily removable and replaceable. In addition an optional toe guard can be installed using the same screws as the insert. The SRS tread panels and screws are available as spare parts. It is toe spike compatible.

TECNO-3 SYSTEM

.. SIDI's TECNO-3 SYSTEM dials in fit along the entire length of the shoe, adapting the upper to the shape of the foot for a customized fit. SIDI's famously reliable and replaceable closures are improved by an all new proprietary SIDI Wire material that is completely non-binding for intuitive and effortless on-the-fly adjustments. Like most SIDI small parts, the TECNO-3 SYSTEM is serviceable and replaceable.

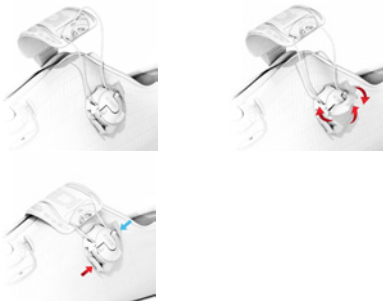

SOFT INSTEP CLOSURE SYSTEM

.. The SOFT INSTEP CLOSURE SYSTEM is a wide, anatomically curved strap combined with a soft, thermo-formed EVA pad that distributes pressure evenly over the instep area. The SOFT INSTEP CLOSURE SYSTEM is adjustable from both sides, to perfectly center the EVA pad over a high or low instep. The system eliminates the need for the High Instep Extender. The SOFT INSTEP CLOSURE SYSTEM is replaceable.

SOFT INSTEP 4



HIGH SECURITY HOOK AND LOOP FASTENER

.. HIGH SECURITY HOOK AND LOOP straps with integrated locking polymer teeth, that engage onto each other when the strap is closed. This feature makes the closure more secure and the strap becomes unmovable.



SIDI HEEL CUP

.. Reinforced cup that stabilizes and supports the heel. Anatomically shaped plastic, reduces heel slip and provides increased power transfer. Provides additional foot protection in the event of a crash.



RUBBER TOE

.. Upper part of the toe section is rubberised to resist and deflect impacts from stones or debris when cycling. It is made with anti-slip rubber.



Microfibr Microtech

Incorporates features of resistance, stability, lightness, transpirability, water-repellency and eco-friendliness. It is manufactured using the "Water-Tech" water treatment. Lower environmental impact, less noxious emissions into the air and into the work environment and the fact that not solvents, but water-based products were used, is beneficial to the environment as well as the final user.

Suola MTB SRS Carbon Composite

In 1999, SIDI revolutionized mountain bike shoe design with the SOLE REPLACEMENT SYSTEM (SRS), allowing mountain bikers to replace the most wear-heavy part of the shoe—the sole. The MTB SRS CARBON COMPOSITE Sole consists of four inserts screwed, easily removable and replaceable. In addition an optional toe guard can be installed using the same screws as the insert. The SRS tread panels and screws are available as spare parts. It is toe spike compatible.

