

ALBA 2 MEGA



SIZE	40-41-42-43--44-45-46-47-48-49-50
UPPER	POLITEX UPPER
SOLE	MILLENNIUM 4 CARBON COMPOSITE SOLE
FITTING	MEGA



COLOUR



BLACK | BLACK

TECNOLOGY

MILLENNIUM 4 CARBON SOLE

-- The MILLENNIUM 4 CARBON COMPOSITE Sole features injected carbon fiber in a matrix of Nylon, providing more rigidity than a standard nylon sole. The MILLENNIUM 4 CARBON COMPOSITE Sole is also more durable, completely non water-absorbent and mechanically stable, meaning it's less susceptible to changes in stiffness resulting from aging, prolonged usage, and changes in temperature or humidity. An anti-slip toe insert and replaceable polyurethane heel pad are incorporated into the MILLENNIUM 4 CARBON COMPOSITE Sole, for walkability. The MILLENNIUM 4 CARBON COMPOSITE Sole uses a standard 3-hole drilling pattern for compatibility with the best pedal systems available, and includes a printed 10 mm lateral and fore/aft cleat alignment scale on the sole as well as the Look Memory Eyelet for easy cleat alignment and replacement.

TECNO-3 SYSTEM

-- SIDI's TECNO-3 SYSTEM dials in fit along the entire length of the shoe, adapting the upper to the shape of the foot for a customized fit. SIDI's famously reliable and replaceable closures are improved by an all new proprietary SIDI Wire material that is completely non-binding for intuitive and effortless on-the-fly adjustments. Like most SIDI small parts, the TECNO-3 SYSTEM is serviceable and replaceable.

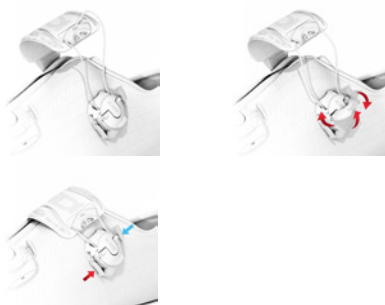

SOFT INSTEP CLOSURE SYSTEM

-- The SOFT INSTEP CLOSURE SYSTEM is a wide, anatomically curved strap combined with a soft, thermo-formed EVA pad that distributes pressure evenly over the instep area. The SOFT INSTEP CLOSURE SYSTEM is adjustable from both sides, to perfectly center the EVA pad over a high or low instep. The system eliminates the need for the High Instep Extender. The SOFT INSTEP CLOSURE SYSTEM is replaceable.

SOFT INSTEP 3



SIDI HEEL CUP

-- Reinforced cup that stabilizes and supports the heel. Anatomically shaped plastic, reduces heel slip and provides increased power transfer. Provides additional foot protection in the event of a crash.



REPLACEABLE HEEL PAD

-- For walkability, Sidi cycling shoes include a replaceable polyurethane heel pad.

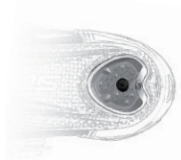

Materiale Politex

The "politex" material is constructed of several overlapping layers with different physical-mechanical properties, the compacted PVC is then coupled to two fabrics (knitted fabric + felt) that is then is film dyed for long-lasting color retention. "Politex" offers strong resistance to ripping, laceration, stretching and fading. "Politex" is made in strict compliance with European regulations and is a totally "green" product.

Tallone Sidi

The reinforced heel keeps the foot in a optimal position and avoids the shoe being deformed by extreme performance or prolonged pressure.



Suola Millennium 4 Carbon Composite

The MILLENNIUM 4 CARBON COMPOSITE SOLE features injected carbon fiber in a matrix of Nylon, providing more rigidity than a standard nylon sole. The MILLENNIUM 4 CARBON COMPOSITE SOLE is also more durable, completely non water-absorbent and mechanically stable, meaning it's less susceptible to changes in stiffness resulting from aging, prolonged usage, and changes in temperature or humidity. An anti-slip toe insert and replaceable polyurethane heel pad are incorporated into the MILLENNIUM 4 CARBON COMPOSITE SOLE, for walkability. The MILLENNIUM 4 CARBON COMPOSITE SOLE uses a standard 3-hole drilling pattern for compatibility with the best pedal systems available, and includes a printed 10 mm lateral and fore/aft cleat alignment scale on the sole as well as the Look Memory Eyelet for easy cleat alignment and replacement.



MEGA LAST

- 4 mm wider across the ball of the foot
- More volume, a high instep and a wider heel cup
- Mega lasts are EE o EEE width

