

OPTIMUS

Crux Lite™

Crux Lite Piezo™

Elektra FE Cook System™

Canister mounted stove for outdoor use

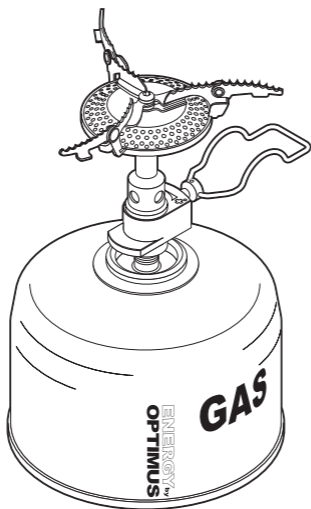

OPTIMUS | CLEVER COOKING SINCE 1899™

FIGURE [1]



FIGURE [2]

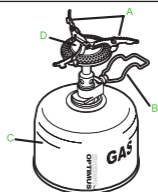

FIGURE [3]

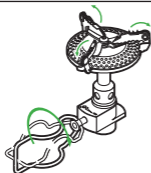

FIGURE [5]

FIGURE [4]



FIGURE [6]

FIGURE [7]



FIGURE [1]



FIGURE [2]

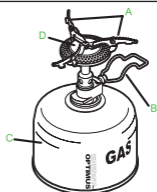

FIGURE [3]

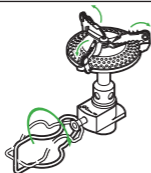

FIGURE [5]

FIGURE [4]



FIGURE [6]



FIGURE [7]

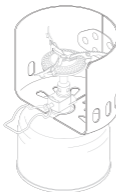
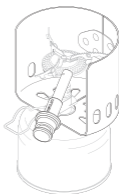

⚠ DANGER



CARBON MONOXIDE HAZARD

This appliance can produce carbon monoxide which has no odor.

Using it in an enclosed space can kill you.

Never use this appliance in an enclosed space such as a camper, tent, car or home.

⚠ WARNING CALIFORNIA PROPOSITION 65:

The fuel and byproducts of combustion of this fuel contain chemicals known to the state of California to cause cancer, birth defects, or other reproductive harm.

SAFETY FIRST



DANGER

If the stove is used incorrectly, it could cause fire, explosion or carbon monoxide poisoning.

Please keep these instructions in a safe place for future reference.



DANGER

This stove uses a liquid pressurized gas (LPG) canister that is highly flammable and explosive. Improper or unsafe use can result in accidental fire and explosions which can cause serious injury or possible death.

- For outdoor use only
- The Optimus Crux Lite is designed for Optimus gas canisters with a threaded valve certified to the EN 417 standard (max. 450g). It may be hazardous to attempt to fit other types of gas canisters.
- Listen and smell for leaking gas. LPG is invisible and may be odorless, as its strong odorant can fade over time. As a result, leaks are not always detectable by smell.
- If you suspect that there is a leak, do not use the stove or canister. To locate and stop the leakage, move stove to a well-ventilated area outdoors away from any ignition source. Check that the stove and fuel canister connection is secure and tight.

WARNING

Risk of fire and explosion when using fire to detect gas leaks.

- Only check for leaks using soapy water. Do not try to detect leaks using a flame.
- Check the seals before connecting a new fuel canister to the stove. Do not use the stove if seals are damaged or worn. **FIGURE [1]**

If you expose the fuel canister to high heat, the canister could explode or leak.

- Keep stove and fuel canister away from other heat sources.
- Follow all warnings on fuel canister regarding use and storage.
- Do not attach or remove canister near high heat, open flames, direct sunlight, other ignition sources or where temperature of canister exceeds 50°C (120°F).
- Only use fuel canisters which are intended to be used with this stove.

INSTRUCTION FOR USE

Before using your Optimus Crux Lite, read the entire manual. To minimize any risk of serious injury or possible death, follow the instructions and safety precautions in this manual. Only use the stove as described in this manual.

FIGURE [2]

A: Pot Supports

B: Control Valve

C: Gas Canister

D: Burner Head

TECHNICAL SPECIFICATIONS (STOVE ONLY):

Fuel: Butane / Propane gas canister, certified to the EN 417

standard (max. 450g) **Weight:** 72g (2.5 oz) **Measurement folded:** 71mm (2.8 in)/ Ø 57mm (2.2 in) **Rating:** 3000 W / 10200 BTU **Burn Time:** up to 90 minutes at maximum output (230g gas canister) **Boil time:** As little as 3minutes depending on climate, altitude, etc. **Injector size of stove:** 0.32 mm **EN 521:2006 Category:** direct pressure – butane / propane mix

CE CE-048BN – 0045



1 SET UP STOVE

1. Fold out the control valve handle and make sure that the valve is fully closed. **FIGURE [3]**
2. Fold out pot supports. **FIGURE [3]**
3. Check O-ring for damage before connecting it to gas canister.

2 CONNECT STOVE TO GAS CANISTER

1. Hold onto the stove and screw the correct gas canister counterclockwise tightly. **FIGURE [4]** Tighten by hand only and be careful not to damage the threads when you connect the gas canister.
2. Always keep the gas canister in an upright position while connecting it to the stove.
3. Ensure that the stove is screwed all the way to the bottom of the thread.
4. Make sure the stove is in a stable position so it will not tip over.
5. Allow plenty of free space around the stove, at least 1.25 meter (4 feet) on each side and 1.5 meters (4.5 feet) above it.
6. Keep stove area clear and free from combustible materials, gasoline and other flammable vapors and liquids.

WARNING

Risk of burning or serious injuries due to gas leakage hazard.

- Never light the stove if you detect a hissing sound or the smell of gas after tightening the canister. The gas has an additive with a foul smell. Never use a stove that smells of gas.
- Do not use stove if damaged or if it does not operate properly.
- Never over-tighten gas canister when connected to the stove. Overtightening can damage stove or canister causing gas to leak.
- Use extreme caution when using stove in temperatures below freezing. In freezing temperatures, O-rings can stiffen and leak gas.
- Always check for gas leaks before and after lighting the stove.
- Keep children more than 3+ meters (10 feet) away from stove and fuel.
- Keep highly flammable fabrics away from stove, such as outdoor clothing, sleeping bags, tents etc.
- Never leave a burning or hot stove unattended.
- When a canister change is necessary, please follow steps 1-4 of this manual carefully.

3 USE THE STOVE TO COOK

1. Open the control valve approximately one turn counter-clockwise and light the burner. **FIGURE [5]** Check that the flame ring is complete and that the flame is mostly blue and non-pulsating in normal operation.
2. Adjust the control valve to get the flame you want.
3. If the output is weak, it could mean that the gas is running out, or that the canister is too cold. Turn off the stove and let it cool down. Make sure there is no open flame nearby when changing the gas canister.
4. Accessible parts may become very hot. Keep out of reach of children, people with diminished mental capacity and pets.

WARNING

Overheating and explosion hazards

- Never add a windscreen after the stove is lit.
- Never use a windscreen which fully encloses the gas canister.
- Keep solid combustibles at least 1.25 meters (4 feet) away from the top and 1 meter (3 feet) from sides of a burning stove or a stove that you are in the process of lighting.
- Keep flammable liquids and vapors at least 8 meters (25 feet) away from the top and sides of a burning stove, or a stove that you are in process of lighting.
- Never attempt to light a stove if control valve has been left open. If control valve is left open, close it immediately and thoroughly ventilate area before lighting stove. Failure to ventilate area can result in an explosion.
- Never use cookware with a diameter larger than 220mm (8.5 in). The pan plus food must not weigh more than 2 kg (4.4 lbs) combined.
- Never place and operate 2 or more stoves together.
- Never operate stove with empty or dry cookware.
- Never use non-Optimus heat reflectors or windshields.

4 **TURN OFF, COOL AND PACK STOVE**

1. Turn off the stove by turning the control valve handle fully clockwise and double-check that the flame is completely extinguished.
2. Allow stove to cool properly.
3. Disconnect the gas canister.
4. It is normal for a small amount of gas to fizz out when you unscrew the gas canister.
5. Fold in pot supports and place stove in stuff sack.

CAUTION

Risk of burning due to incorrect handling and storage.
Storing gas canisters near any heat or ignition source, or

where temperatures exceed 50° C (120° F) can result in the canister exploding.

Never move a burning or hot stove. Allow stove to cool for at least 10 minutes before moving it.

Never transport or store the stove with the gas canister connected to it.

Always store gas canisters in a well-ventilated area away from any possible heat or ignition source such as: water heaters, stoves, pilot lights, furnaces or where temperatures exceed 50°C (120°F).

5 MAINTENANCE

Before each use, check the O-ring where the stove connects to the gas canister. **FIGURE [1]** Leakage may result if the O-ring is not in place, or if it is worn or damaged. Replace the O-ring by teasing it out with a tool such as the blunt end of a sewing needle. Never use a sharp or pointed object that can damage the seal surfaces. Fit the new O-ring with care to avoid damaging it. Only use original Optimus O-rings (Art. Nr. 8017867) for this purpose. Do not modify the stove. Only qualified individuals are allowed to do additional service. For major repairs send stove back to Optimus.

Addendum for Crux Lite Piezo (8018914) & Elektra FE Cook set (8018921)

Your Crux Lite stove is including a handheld piezo ignitor.

In order to ignite your stove, open the control valve handle and bring the piezo ignitor close to the burner head. Make sure it is pointing upwards. Push the green button to produce a spark in order to ignite the burner. **FIGURE [6]** Push several times if ignition does not happen immediately. Please note that Piezo ignitors are not reliable at altitudes above 2000 m.

WARNING

Risk of burning or serious injuries due to incorrect handling

- Never have your face above the stove when igniting it. Possible flare ups could cause serious injuries.

Addendum for Elektra FE Cook set (8018921):

Your Crux Lite stove also includes a Terra weekend HE pot and a windshield to increase the stove's performance and efficiency.

To use the clip-on windshield take both halves and bend them slightly outwards. Clip the opening at the bottom around the valve neck of the gas canister. Make sure the windshield is fixed securely. Turn the windshield into the desired direction (to best block the wind) and make sure the stoves control handle is easily accessible. **FIGURE [7]** We recommend to use this windshield only with the Optimus Crux and Crux Lite gas stoves and Optimus gas canisters.

WARNING

Risk of burning or serious injuries due to incorrect handling

- Ensure the stove is securely tightened on the gas canister before fitting the windshield.
- Always fit the windshield before lighting the stove.
- Never use a pot wider than 13cm (5 in) in conjunction with the Optimus Clip-on Windshield.
- Always leave a gap of approximately 10mm between pot and windshield to avoid overheating.
- Never use stoves on which the flames are pointing sideways in combination with this windshield.
- Never operate stove with empty or dry cookware (**This also stands for the Crux Lite Solo Cook system (8016164).**)

OPTIMUS

OPTIMUS CRUX LITE - extremely lightweight-gas canister stove

PRODUCT CHARACTERISTICS

Gas:	Butane/propane
o Burning time:	Up to 90 minutes at full output (220 g gas cartridge)
o Cooking time:	For 1 l water approx. 3 minutes
Output:	Watt: 3000 BTU: 10'200
Weight:	72 g
Dimensions:	71 x 57 x 56 mm
Guarantee:	2 years
Material:	Stainless steel, aluminum
Accessories:	stuff bag
Article No.:	8019259 Optimus Crux Lite



PRODUCT CHARACTERISTICS >

BENEFITS

- With a mere 72 g, one of the lightest stoves in the world
- Powerful and stable 3000 W burner for efficient cooking
- Large burner head for optimal heat distribution
- Precise flame control – simmering without burning
- CE certified: CE-048BN-0045

OPTIMUS

OPTIMUS CRUX LITE - extremely lightweight-gas canister stove

EXPLODED VIEW

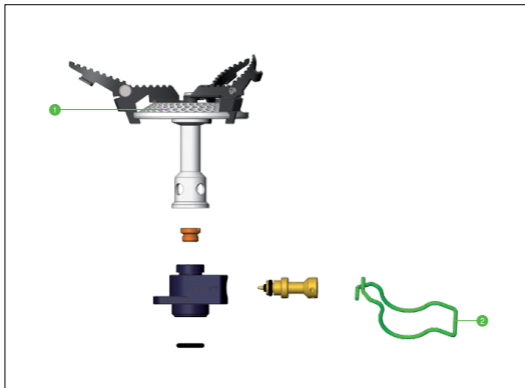

- 1 Burner head
- 2 Control handle

Katadyn reserves the right to modify product characteristics