

MAGLITE[®] SOLITAIRE[®] LED FLASHLIGHT



FL1 STANDARD



ULTRA BRIGHT™
37 LUMENS

1-CELL AAA

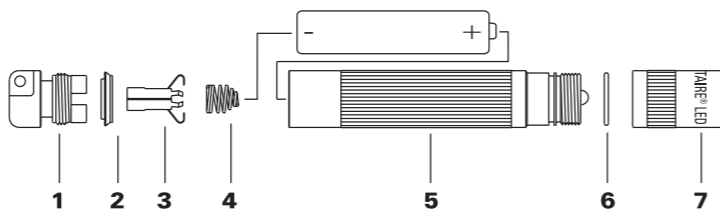

- 1 Tail cap
- 2 Lip seal, tail cap
- 3 Electrical contact
- 4 Battery spring*
- 5 Barrel/LED Switch Assembly**
- 6 O-ring, barrel
- 7 Head assembly**

*Item 4 inserts into item 1
**Do not disassemble.

OPERATION: Large end of battery spring must be snapped into tailcap. Install 1 AAA alkaline battery with the "+" end facing the head end of the flashlight. Backwards installation can damage the LED. Turn flashlight on and off by twisting the head. Rotate the head to focus the beam.

INSPECTION AND MAINTENANCE: If flashlight is used less than once a month, remove the batteries between uses. Lubricate all threads and rubber O-rings with petroleum jelly twice yearly. Inspect flashlight monthly and carefully remove any damaged batteries and clean any corrosion.

TROUBLESHOOTING: If flashlight does not turn on or stay on - 1. Replace the batteries. If the problem persists, then 2. Check the tail cap. The metal surfaces contacting the barrel, tail cap and spring assembly should be clean, shiny and free of corrosion or other obstruction. Clean as needed.

WARNINGS: • To AVOID RISK OF EYE INJURY, LOOK AWAY IMMEDIATELY IF BEAM IS SHONE DIRECTLY INTO YOUR EYES. • AVOID EXPOSING BATTERIES TO FIRE OR EXCESSIVE HEAT, as this may cause leakage or explosion. • To AVOID RISK OF INJURY TO EYES OR SKIN, AVOID CONTACT WITH ANY MATERIAL LEAKED FROM A BATTERY • THIS FLASHLIGHT IS NOT A TOY; not recommended for use by children.

Single Cell AAA Flashlight

MAGLITE[®] LED SOLITAIRE[®]

Model Number: **SJ3A016** Part Number: **160-000-017**

- Twist head to turn on/off and focus beam (spot to flood)
- Latest-generation LED for high brightness and longer battery life
- Limited Lifetime Warranty – Details inside



Our website offers you a wide variety of flashlights at affordable prices.