



# ASSEMBLY INSTRUCTIONS

## 30" EXPANSION KIT

MODEL 0125

### BEFORE ASSEMBLY:

- Assemble on a level platform
- 3+ people for setup recommended



### TOOLS REQUIRED



### TABLE OF CONTENTS

Icon Legend.....	4
Warnings & Notices.....	5
Alerts.....	6
Parts Identifier.....	7
Platform Construction.....	8
Shed Disassembly.....	9
Floor Assembly.....	14
Truss Assembly.....	17
Wall & Roof Assembly.....	22
Warranty.....	29



## ICON LEGEND



Indicates special heed should be taken when reading.



Indicates the parts to be used for a section.



Indicates no parts required for a specific section.



Indicates the hardware to be used for a section.



Indicates no hardware required for a specific page.



Indicates the tools to be used for a section.



Indicates to use/not to use an electric drill for a specific step.



## WARNINGS & NOTICES

### English:

- **Failure to follow these warnings may result in serious injury or property damage and will void warranty.**
- To ensure safety, do not attempt to assemble this product without following the instructions carefully.
- Consult all local building codes to verify if the shed requires a building permit.
- Verify the foundation is completely level before assembling the shed.
- Be aware that plastic pieces can be damaged by overtightening the screws. To avoid damage, we strongly recommend the use of a drill with a low torque setting. A #2 Phillips screwdriver may also be used.
- Three capable adults are required for assembly.
- All who participate in the assembly process should wear safety glasses throughout the assembly.
- If using a ladder during assembly, use extreme caution.
- In heavy snowfall areas, we recommend removing snow from the roof.
- Do not use or store hot objects near the product.
- Proper and complete assembly are essential to reduce the risk of accident or injury.
- We strongly recommend anchoring your shed when it is finished. The last section, Shed Anchoring, in this manual shows the hardware you will need to complete the anchoring. You can find the hardware at your local hardware store.
- **Most injuries are caused by misuse and/or not following instructions. Use caution when using this product.**



## ALERTS

### English:

#### **If you are assembling a new shed:**

- Check contents of boxes and compare to parts listed on the next page.
- Follow instructions that came with your shed, but add the parts that came with this kit at the appropriate points in the assembly, e.g., insert the Floor Panel when assembling the Floor.

#### **If you are extending an existing shed:**

- Remove any bolts or screws being used to anchor the shed to the ground.
- Remove any objects from back shelves.
- Remove any pegboard strips hanging on the last two Side Wall Panels on either side.
- Check contents of boxes and compare to parts listed on the next page.
- Follow the steps in this manual.



## PARTS IDENTIFIER



## HARDWARE BAGS

Hardware Bags

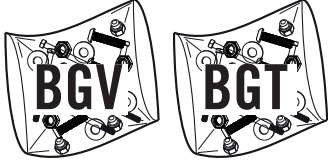

## PARTS REQUIRED

Metal Parts /

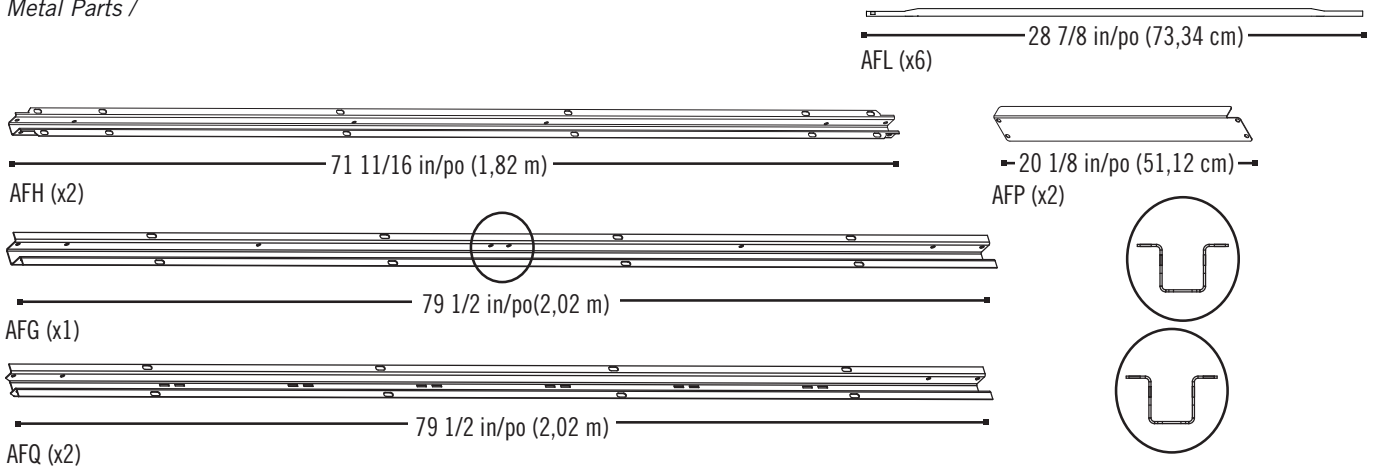

Plastic Parts

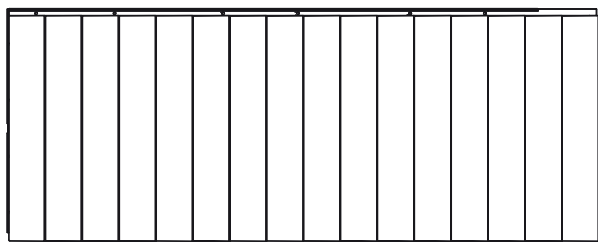

AHD (x2)

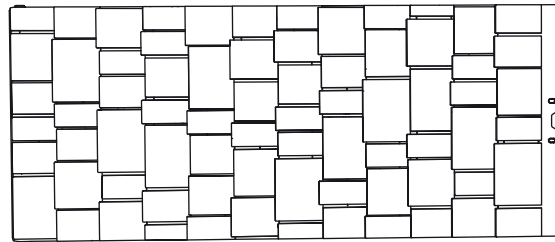

AGQ (x2)

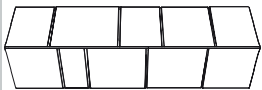

AFY (x1)



AGJ (x2)

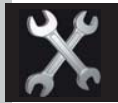

## TOOLS REQUIRED

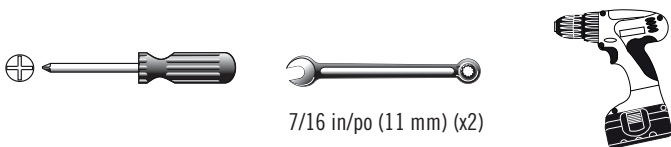

# 1

## PLATFORM CONSTRUCTION

*REFER TO YOUR CURRENT SHED PLATFORM FOR MATERIALS USED*

### 1.1

- This extension kit adds another 30" to the length of your shed. Before beginning expansion of your shed, be sure that your site can accommodate the new size. Add 30" (76,2 cm) to the length of your site's wooden platform (shown) or cement platform; the width will remain the same. **This may require the use of additional lumber or other materials.**

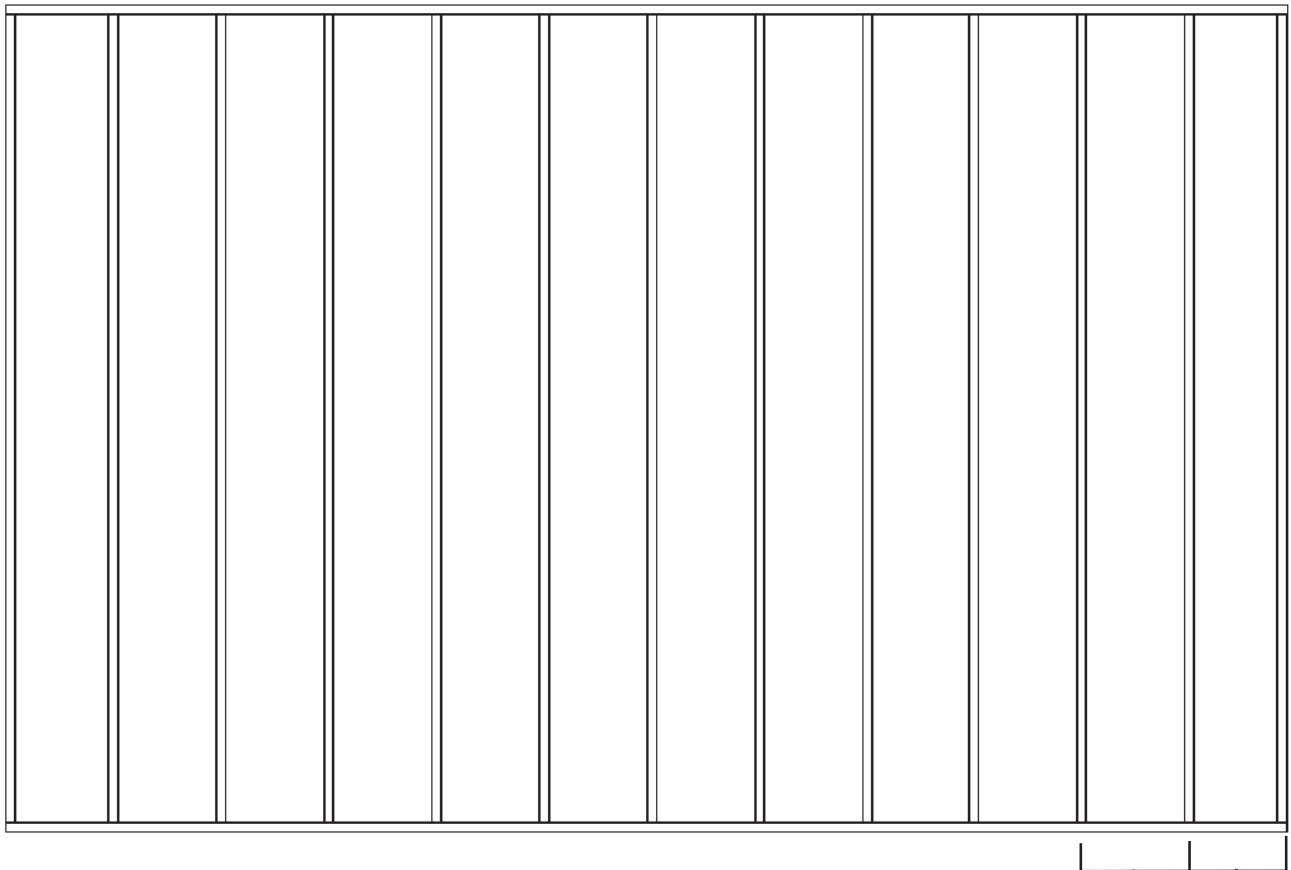

16"      14"  
(40,64 cm)    (35,56 cm)



**Note:** Floor studs are all 16" on center with the last at 14" on center. **Refer to your original Owner's Manual.**

# 2

## SHED DISASSEMBLY



### HARDWARE REQUIRED

*Hardware Bag*



### PARTS REQUIRED

*Plastic Parts*



### TOOLS REQUIRED



► SECTION 2 (CONTINUED)

TOOLS AND HARDWARE REQUIRED



2.1

- If you've anchored your shed, remove all anchoring hardware before continuing. Save all hardware removed throughout the instructions!



2.2

- Remove the Screws (x48) from the two Center Roof Caps and four Center Roof Panels.

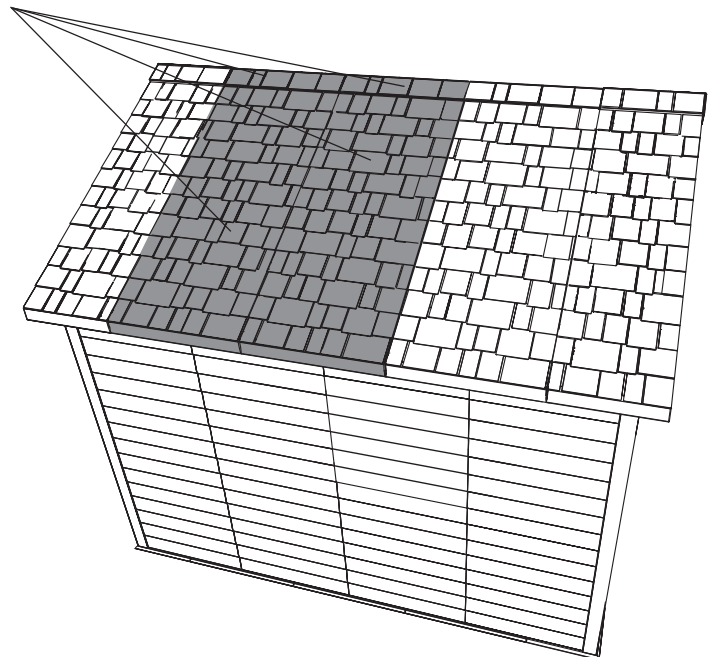
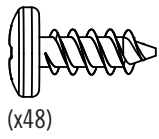

*Note: No matter the length of your shed, remove only the four Roof Panels (two on each side) and the two Roof Caps indicated.*



## ▶ SECTION 2 (CONTINUED)

TOOLS AND HARDWARE REQUIRED



### 2.3



- Remove all Screws (x40) securing the Truss to the Wall Panels and those securing these two Wall Panels together (regular Wall Panels or Window Wall Panels).

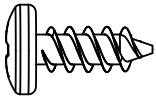
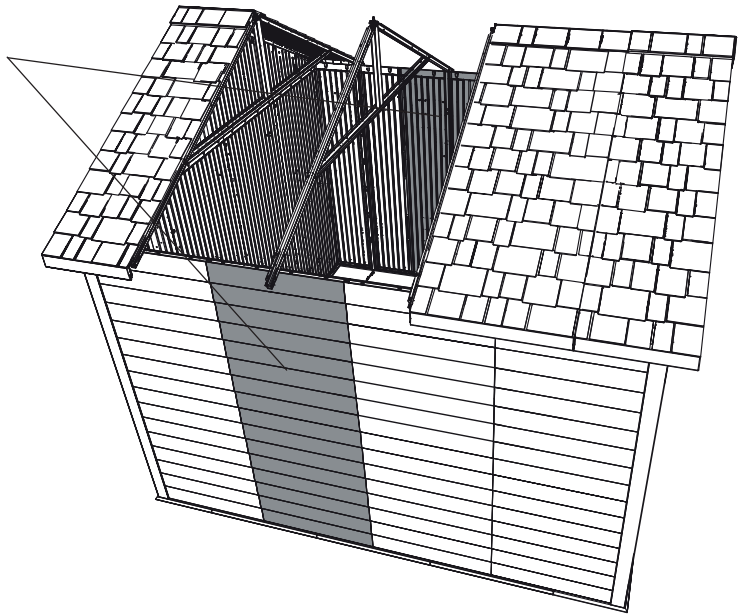

(x40)

### 2.4

- Tip the Wall Panel to be removed inward.

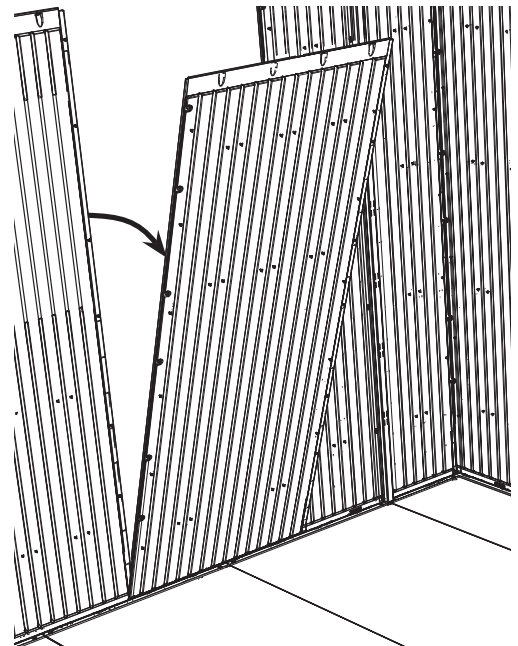

► SECTION 2 (CONTINUED)

TOOLS AND HARDWARE REQUIRED



2.5



- Gently pry the bottom corner of the Panel away from the adjacent Panel. Slide the Wall Panel to the left and remove it. **Repeat these steps for the opposite Panel.**

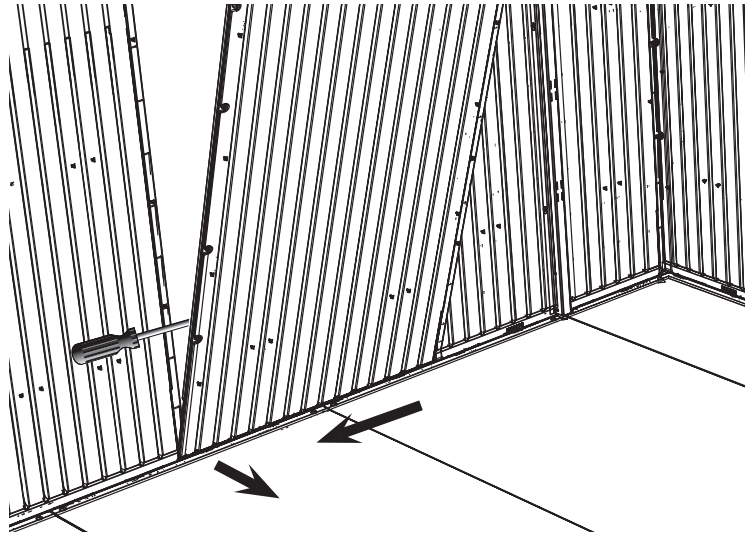

2.6



- Remove the Truss Assembly and set it aside.

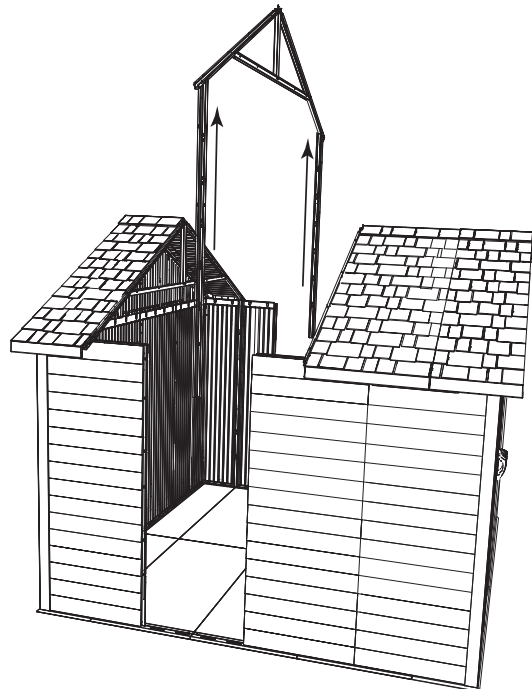

► SECTION 2 (CONTINUED)

TOOLS AND HARDWARE REQUIRED



**2.7**

- Tilt the rear of the shed upward, and slide it backwards to separate it from the front of the shed.

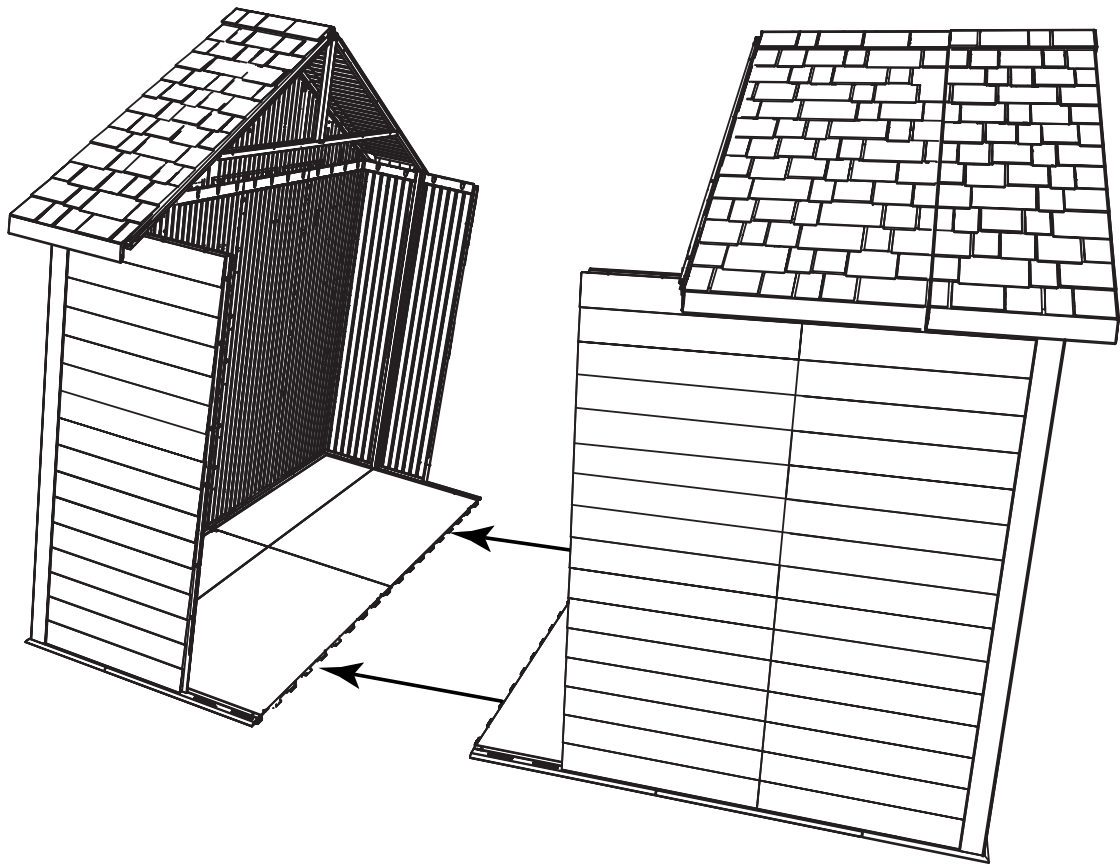

# 3

## FLOOR ASSEMBLY



### HARDWARE REQUIRED

*Hardware Bag*



### PARTS REQUIRED

*Plastic Parts*



AGJ (x2)



### TOOLS REQUIRED



## ► SECTION 3 (CONTINUED)

TOOLS AND HARDWARE REQUIRED



### 3.1

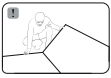

- 1—Hold a **Center Floor Panel (AGJ)** at an angle and slide the tabs along the edge underneath the other **Center Floor Panel (AGJ)**. The tabs interlock. 2—Lay Panel down flat.

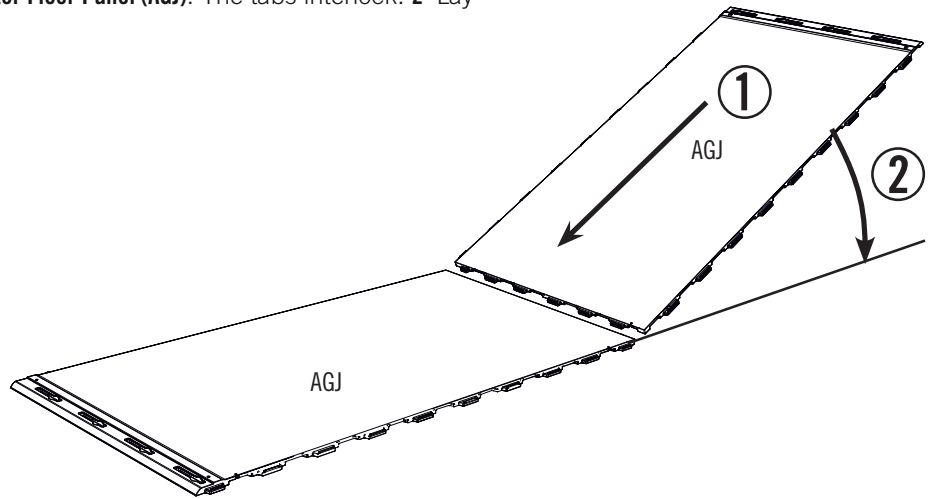

### 3.2

- Slide the tabs along the edge of the two Panels underneath those already connected to the Shed. The tabs interlock. Lay Panel down flat.

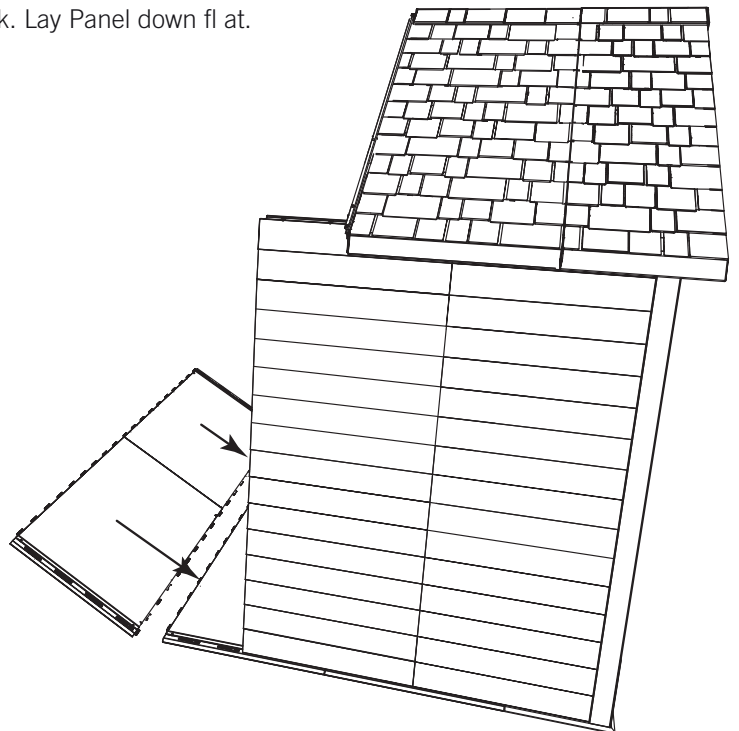

► SECTION 3 (CONTINUED)

TOOLS AND HARDWARE REQUIRED



**3.3**

- 1—Holding the rear of the shed at an angle, attach it to the new Floor Panels. 2—Lay rear of shed fl at.

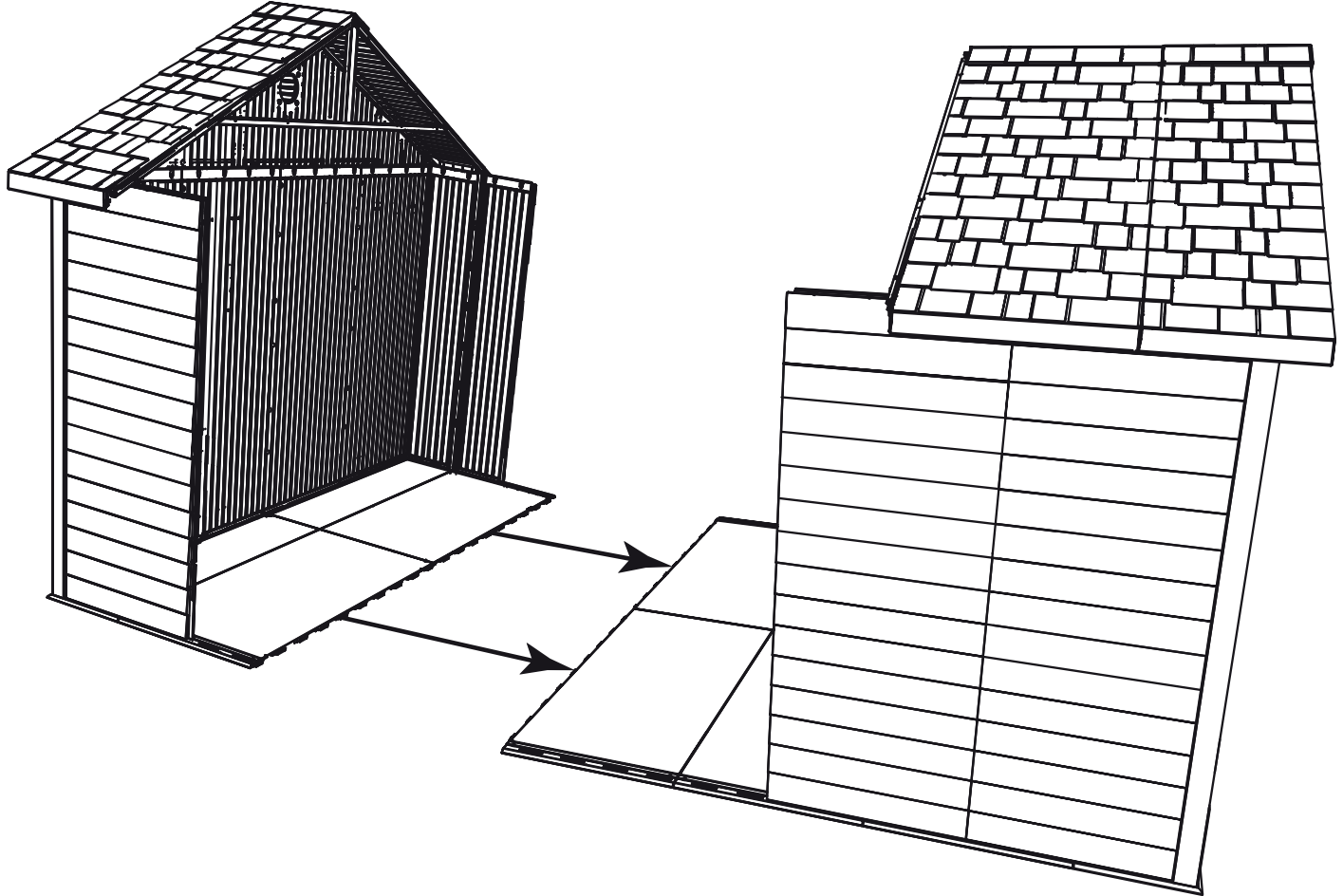

# 4

## TRUSS ASSEMBLY



### HARDWARE REQUIRED

Hardware Bag

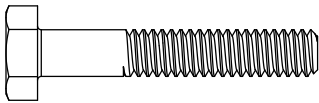

AAK (x10)



ADJ (x10)

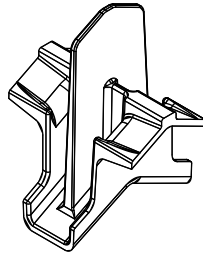

AIP (x1)



AHT (x2)



### PARTS REQUIRED

Metal Parts

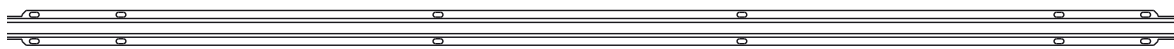

71 11/16 in/po (1,82 m)

AFH (x2)



79 1/2 in/po (2,02 m)

AFG (x1)



79 1/2 in/po (2,02 m)

AFQ (x2)

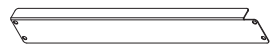
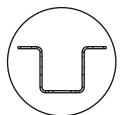

20 1/8 in/po (51 cm)

AFP (x2)



### TOOLS REQUIRED



7/16 in/po (11 mm) (x2)

► SECTION 4 (CONTINUED)

TOOLS AND HARDWARE REQUIRED

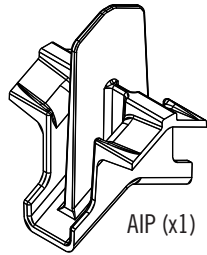

4.1

- Place a **Truss Connector (AIP)** down inside the ends of two **Truss Gutter Channels (AFH)** as shown.

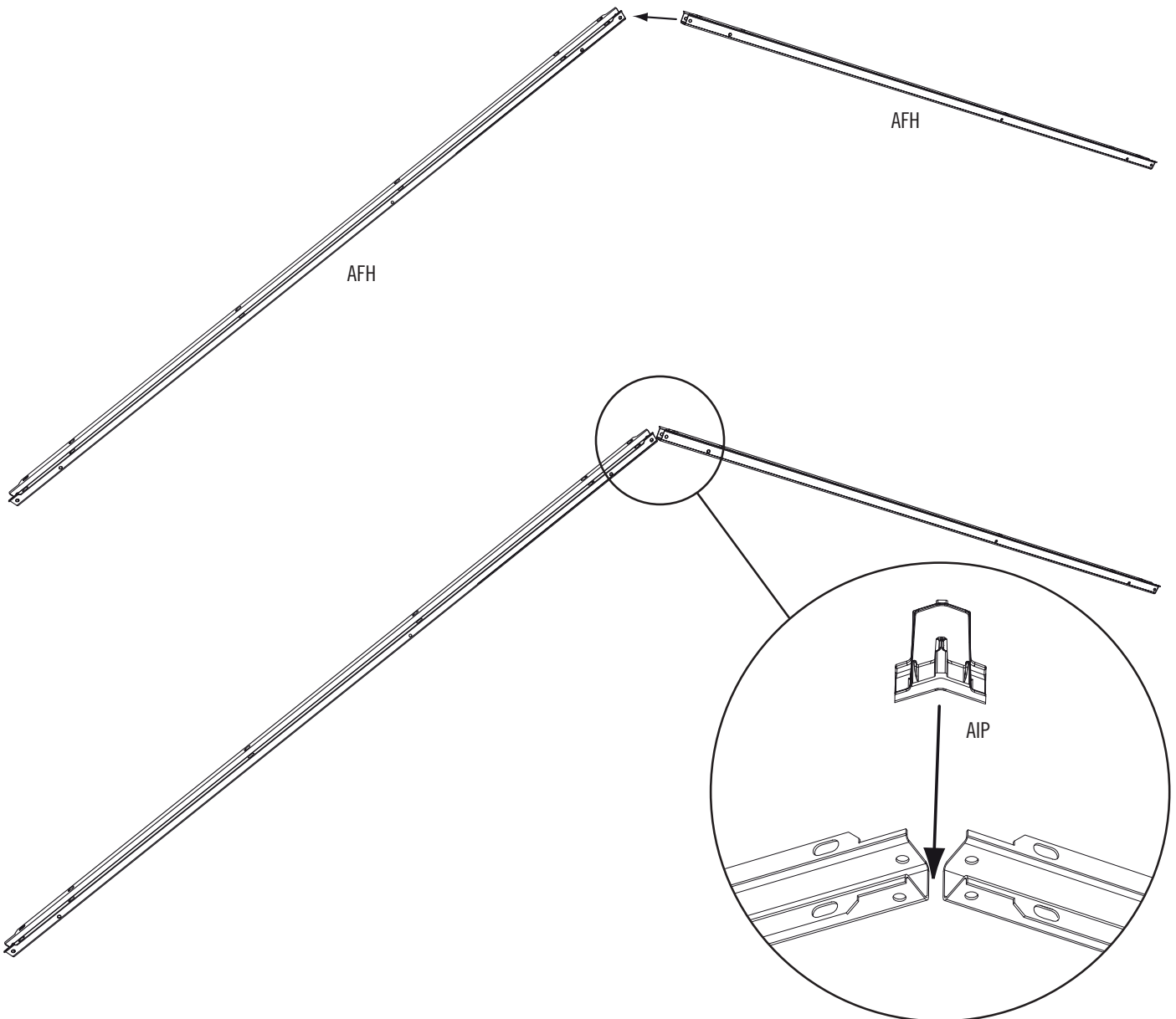



## SECTION 4 (CONTINUED)

TOOLS AND HARDWARE REQUIRED /



7/16 in/po (x2)  
(11 mm) (x2)

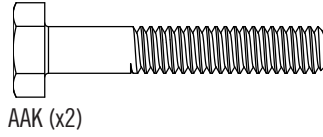

ADJ (x2)

### 4.2

- Insert two (2) **Bolts (AAK)** through the first **Vertical Truss Brace (AFP)**, the holes in the Truss Gutter Channels, over the Truss Connector, and out through the Truss Gutter Channels and second **Vertical Truss Support (AFP)**. Secure with two **Cap Nuts (ADJ)**. **Do not overtighten the Nuts.**

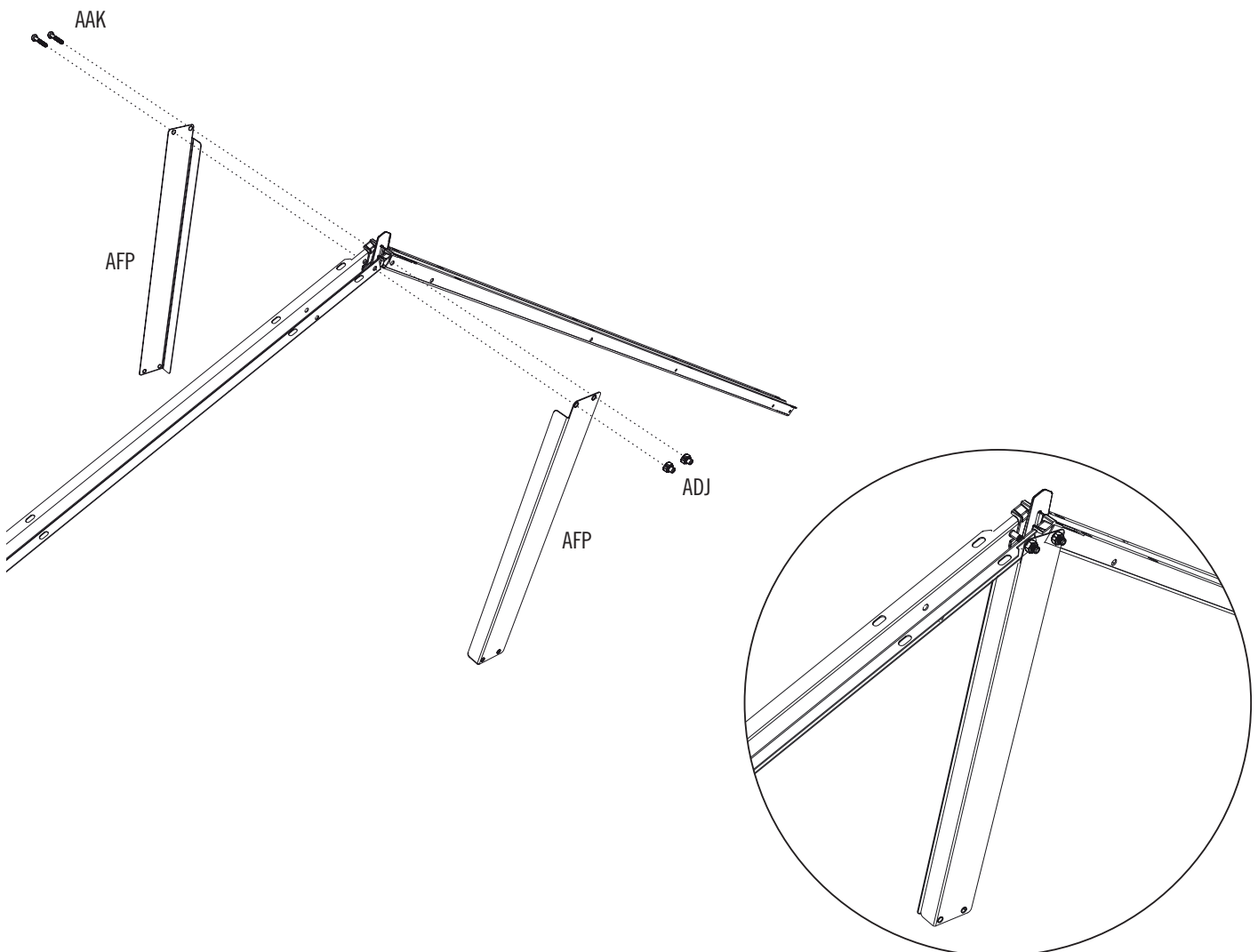

## SECTION 4 (CONTINUED)

TOOLS AND HARDWARE REQUIRED



7/16 in/po (x2)  
(11 mm) (x2)

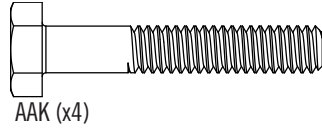

### 4.3

- Secure a **Horizontal Truss Brace (AFG)** to the Channels and the Vertical Truss Braces using four (4) **Bolts (AAK)** and **Cap Nuts (ADJ)**. Do not overtighten the Nuts.

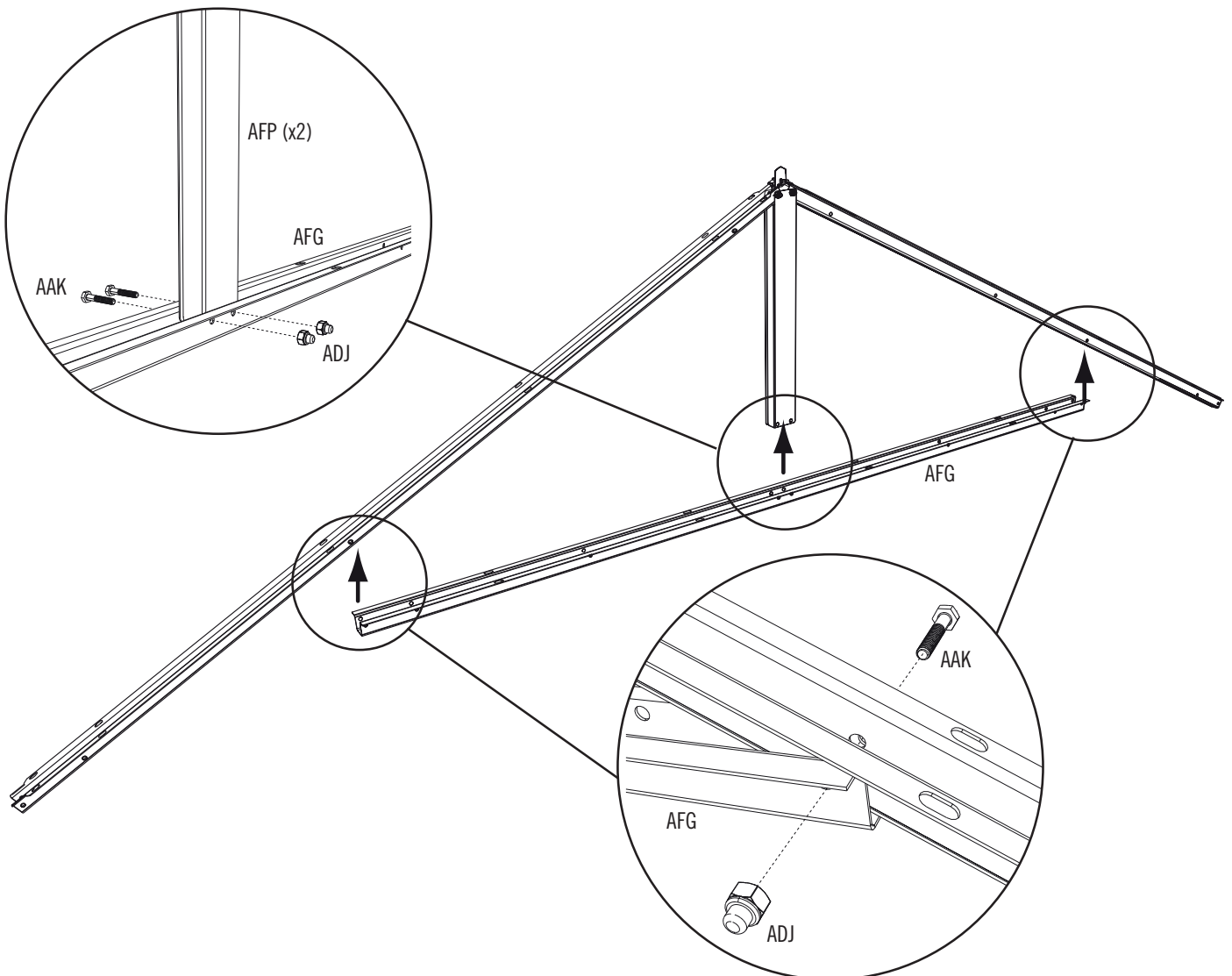

## SECTION 4 (CONTINUED)

### TOOLS AND HARDWARE REQUIRED



7/16 in/po (x2)  
(11 mm) (x2)

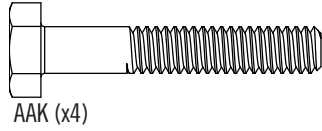

AAK (x4)



ADJ (x4)



AHT (x2)

## 4.4

- Attach a **Wall Support Channel (AFQ)** to each end of the Truss Assembly using the hardware indicated. **Do not overtighten.**

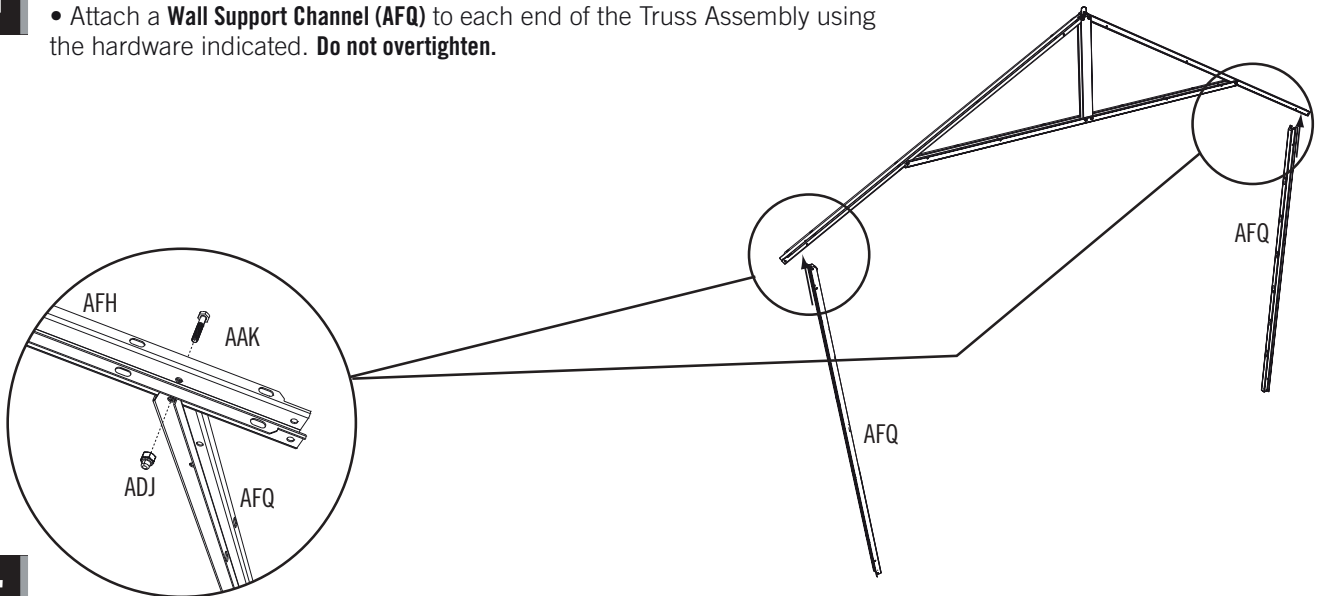

## 4.5

- Attach a **Floor Bracket (AHT)** to the bottom of each Wall Support Channel. **Do not overtighten.**

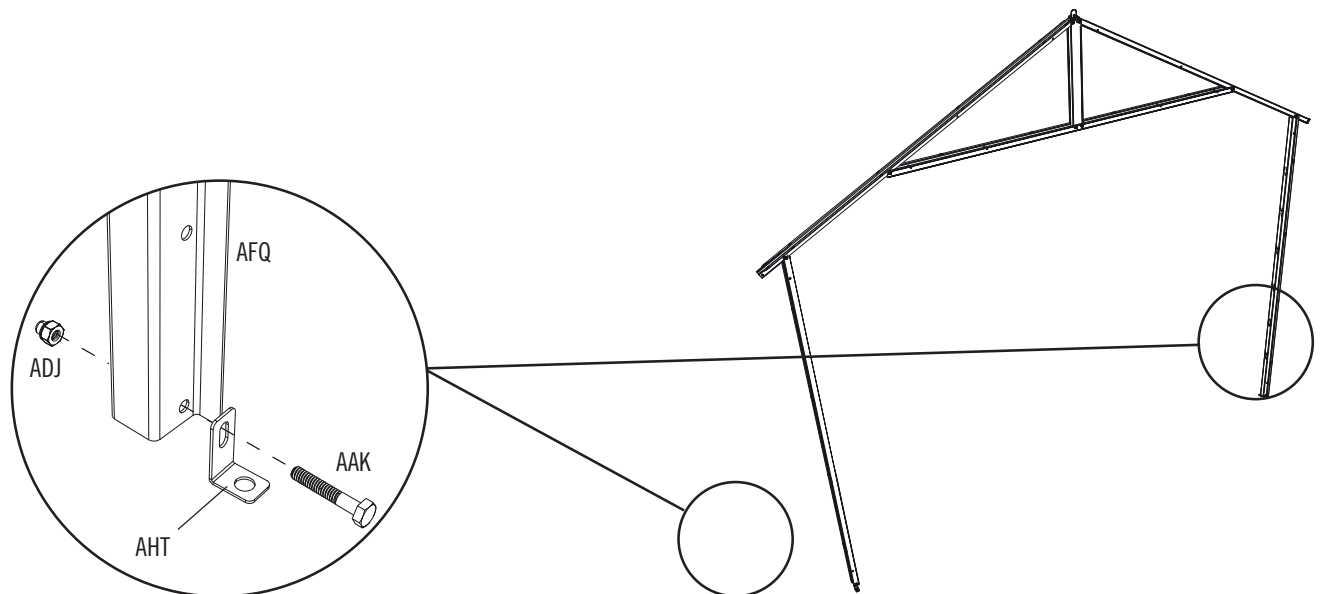

# 5

## WALL & ROOF ASSEMBLY



### HARDWARE REQUIRED

Hardware Bag / Sac de quincaillerie / Bolsa de herraje

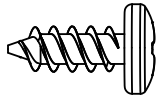

ADZ (x72)

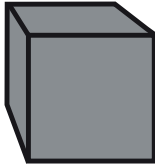

AJA (x4)

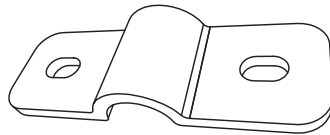

EVC (x6)



### PARTS REQUIRED

Metal Parts

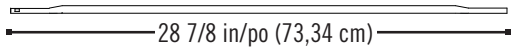

AFL (x6)

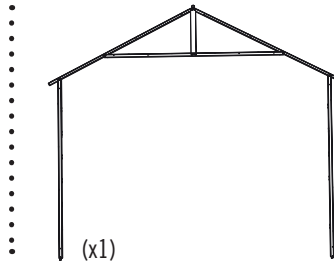

Plastic Parts /



AFY (x1)

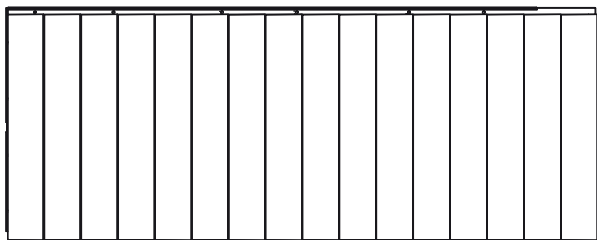

AHD (x2)

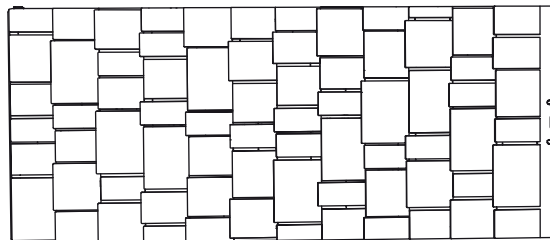

AGQ (x2)



### TOOLS REQUIRED



## ▶ SECTION 5 (CONTINUED)

TOOLS AND HARDWARE REQUIRED

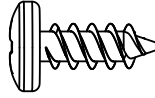

ADZ (x48)

### 5.1

- Insert a Wall Panel you removed previously as well as the **Wall Panel (AHD)** included with this kit. Use the Screws you removed previously as well as the **Screws (ADZ)** included with this kit to secure the Panels together.

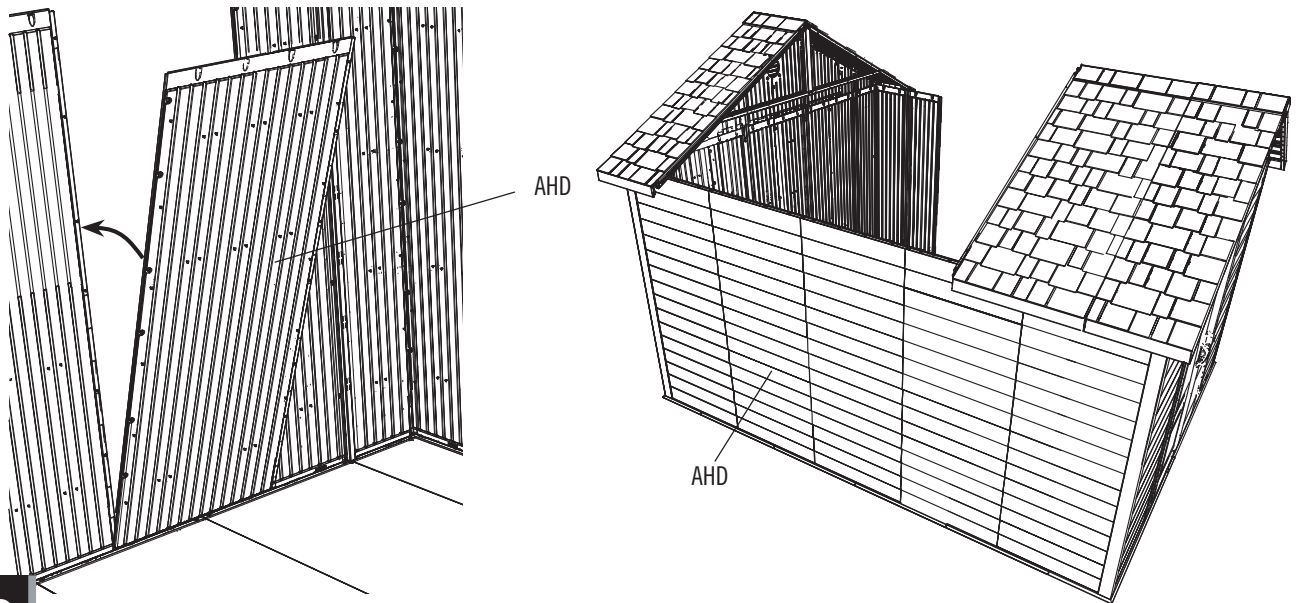

### 5.2

- Repeat the last step for the opposite side of the shed.

## ► SECTION 5 (CONTINUED)

TOOLS AND HARDWARE REQUIRED

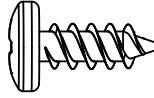

ADZ (x32)

### 5.3

- Connect the Truss Assembly you removed previously as well as the Truss Assembly you built using this kit to the center of each Wall Panel and Window Wall Panel with the **Screws (ADZ)** included and the Screws you removed previously.

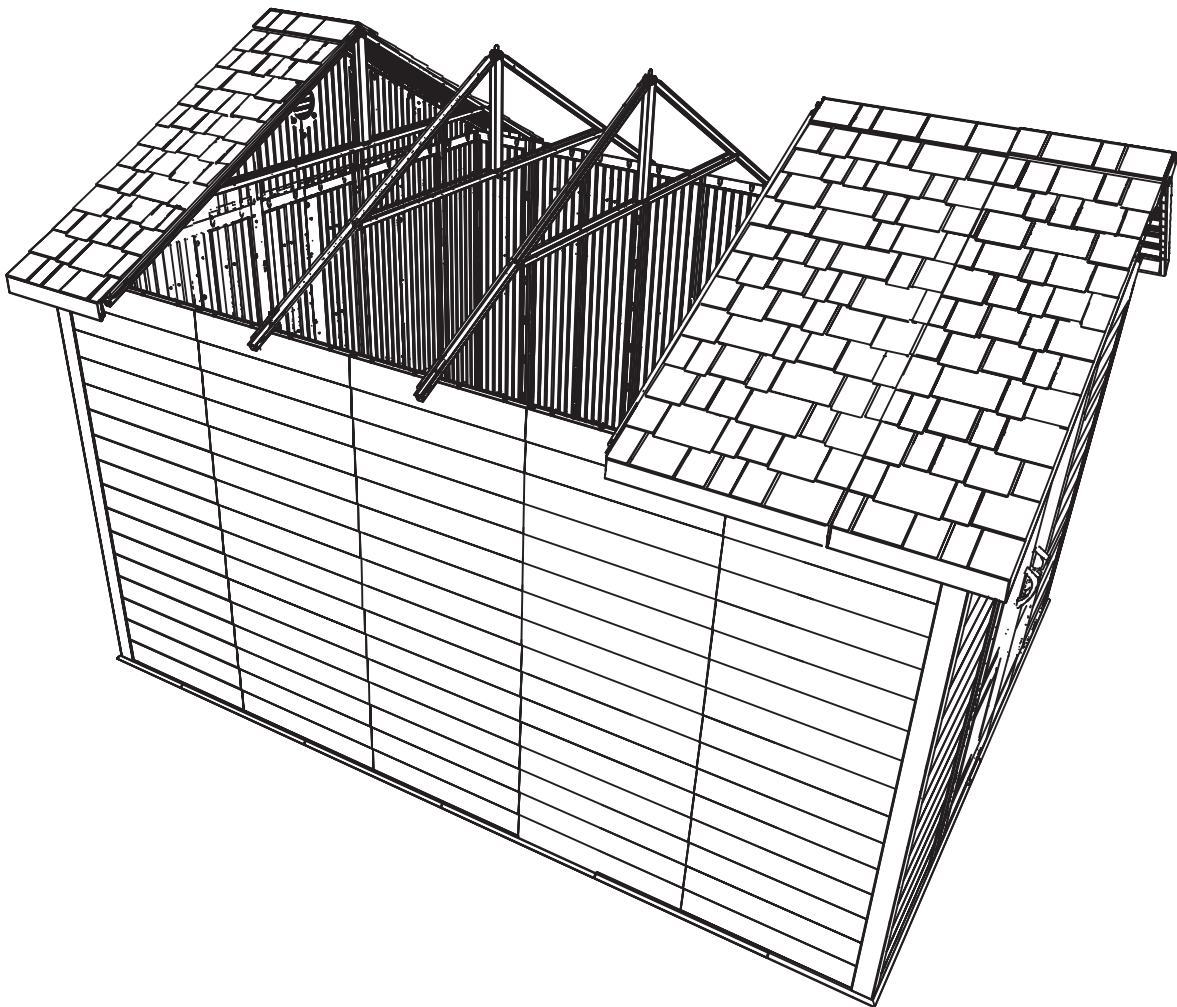

## ► SECTION 5 (CONTINUED)

TOOLS AND HARDWARE REQUIRED

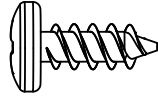

ADZ (x84)

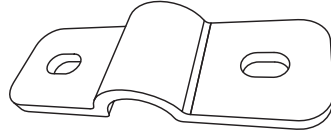

EVC (x6)

### 5.4

- Attach the Center Roof Panels and Roof Supports you removed earlier as well as the **Center Roof Panels (AGQ)** and **Roof Supports (AFL)** included with this kit using **Screws (ADZ)**, **Screws (ACJ)**, and **Washers (AED)**. As you attach the Roof Panels to the Trusses, secure the **Roof Supports (AFL)** to the center of the Roof Panels using a **Support Bracket (EVC)** and two (2) **Screws (ADZ)** as shown.

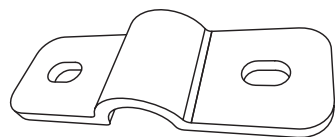
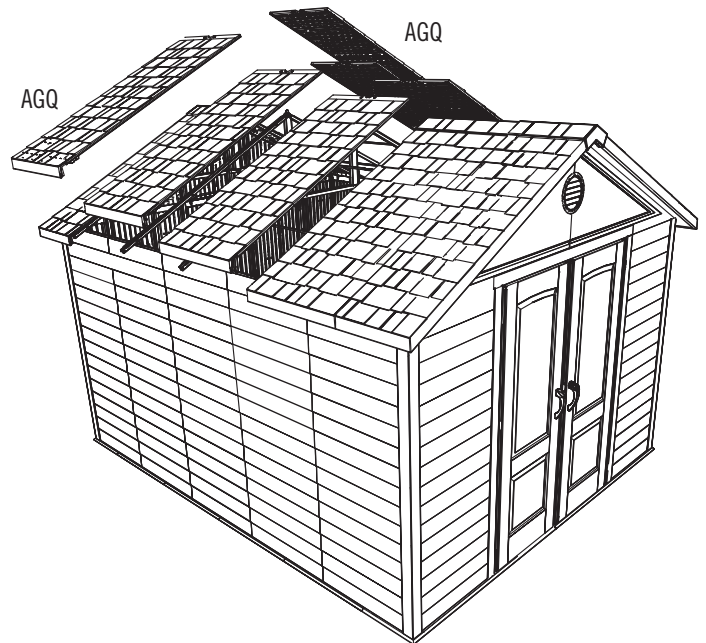

EVC

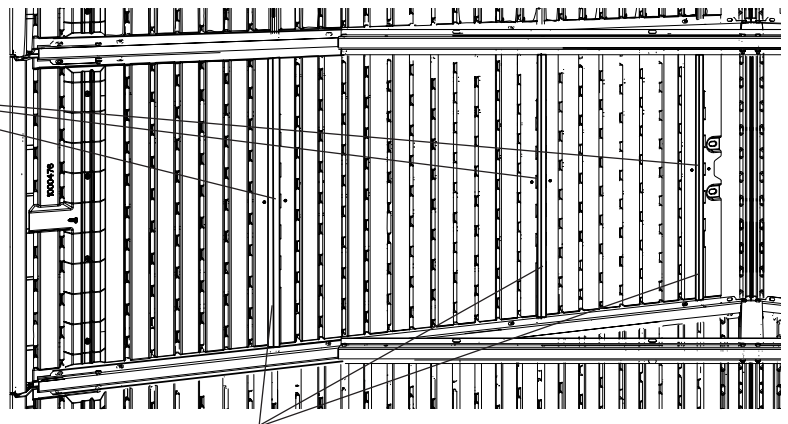

AFL (New)

► SECTION 5 (CONTINUED)

TOOLS AND HARDWARE REQUIRED

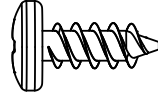

ADZ (x12)

5.5

- Attach the Center Roof Cap you removed earlier as well as the **Center Roof Cap (AFY)** included with this kit using **Screws (ADZ)**.

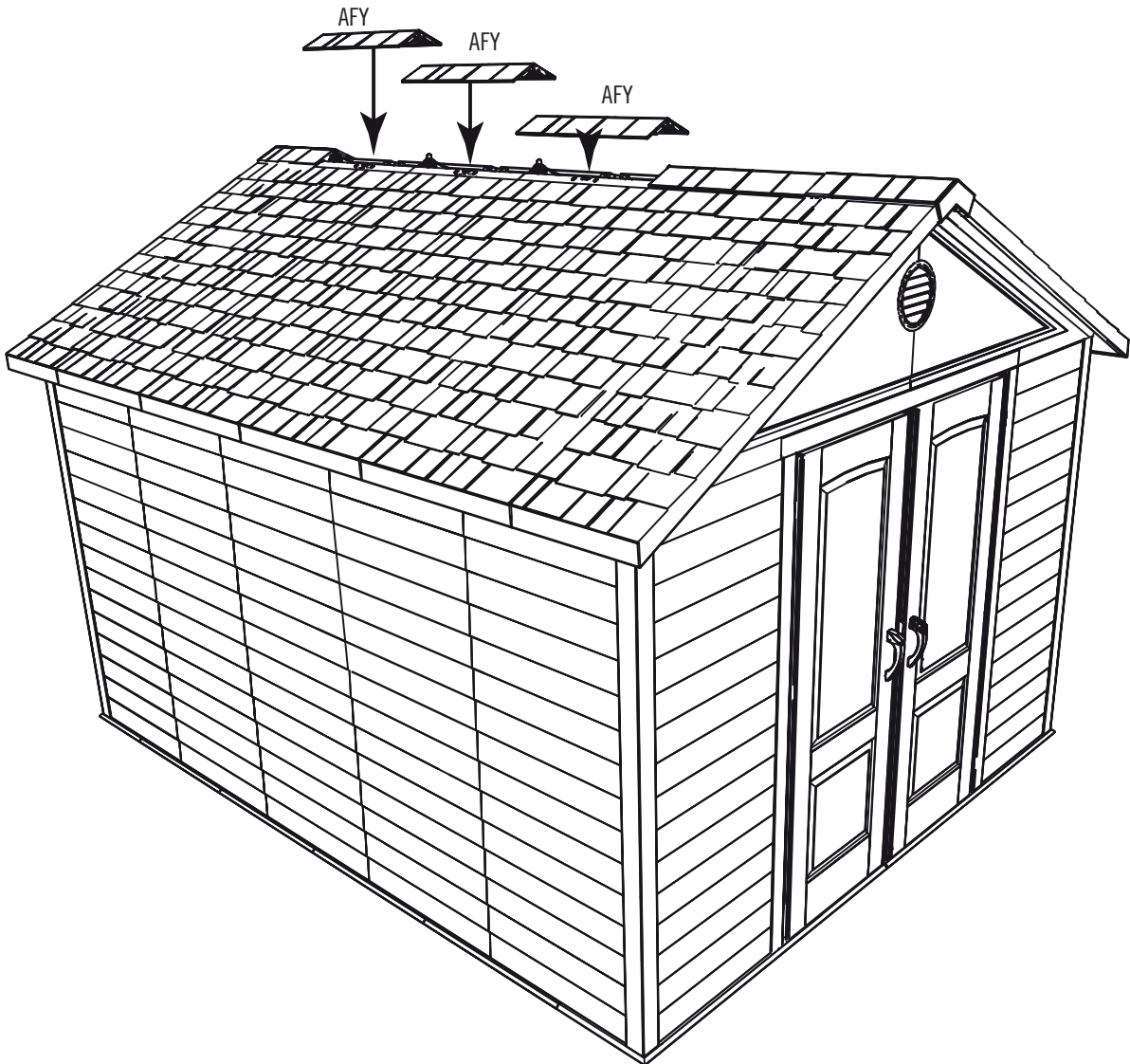



## SECTION 5 (CONTINUED)

TOOLS AND HARDWARE REQUIRED

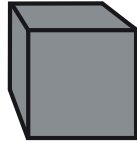

AJA (x16)

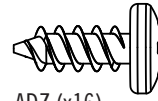

ADZ (x16)

### 5.6

- Fasten the Gutter Channels to the Roof Panels with **Screws (ADZ)** (Fig. 1). When finished, insert the **Foam Cubes (AJA)** between the Gutter Channels and Roof Panels (Fig. 2). To anchor your shed, do as you did with your existing shed or according to your original Owner's Manual. See the steps for **Anchoring the Shed** at the end of your original Owner's Manual.

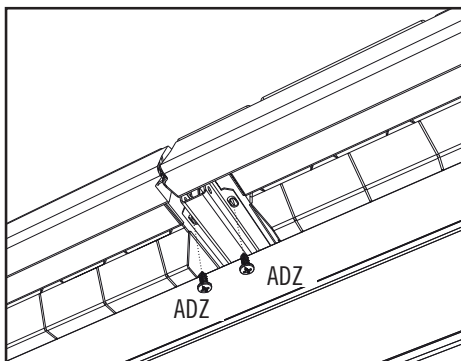
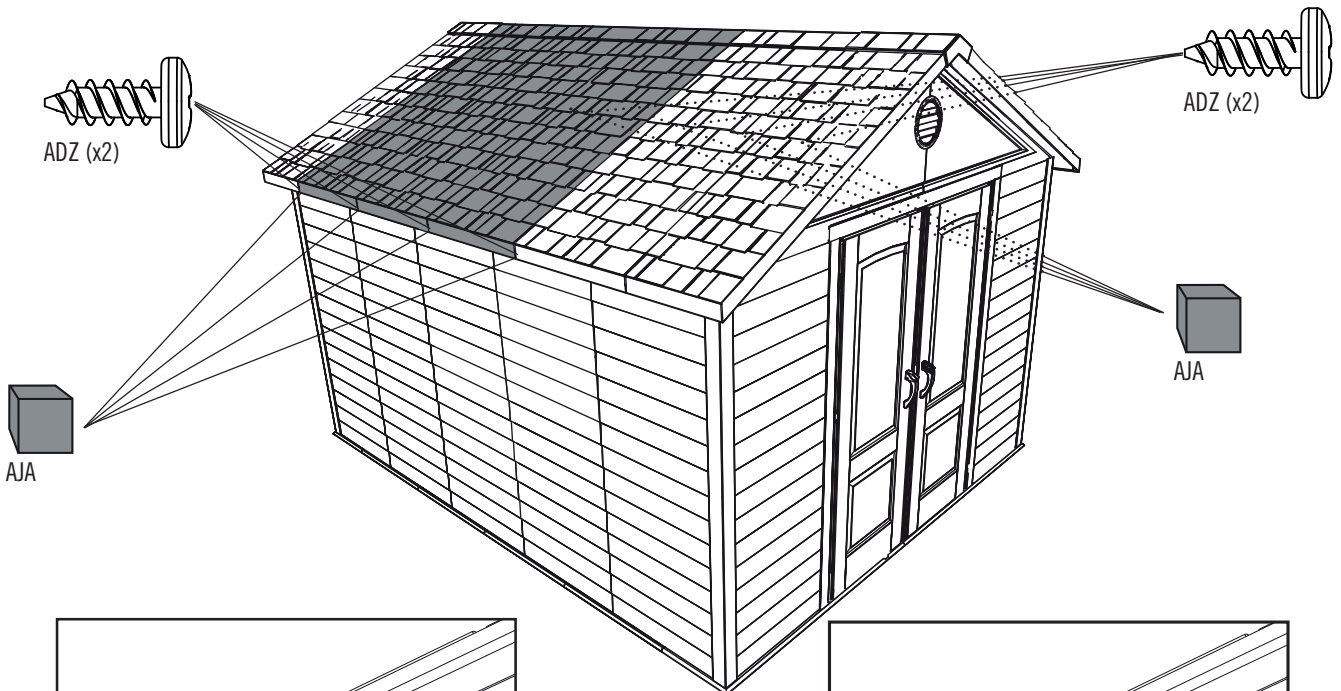

Fig. 1



AJA

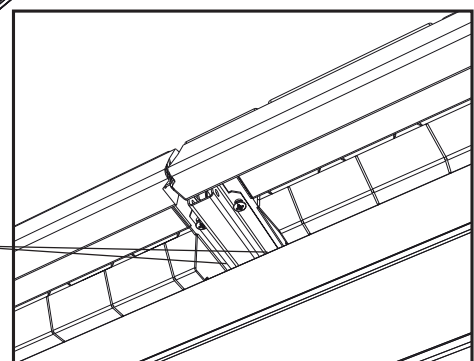

Fig. 2



## 10-YEAR LIMITED FACTORY WARRANTY

### **THE MANUFACTURER RESERVES THE RIGHT TO MAKE SUBSTITUTIONS TO WARRANTY CLAIMS IF PARTS ARE UNAVAILABLE OR OBSOLETE.**

1. Lifetime outdoor sheds are warranted to the original purchaser to be free from defects in material or workmanship for a period of ten years from the date of original retail purchase. The word “defects” is defined as imperfections that impair the use of the product. Defects resulting from misuse, abuse or negligence will void this warranty. This warranty does not cover defects due to improper installation, alteration or accident. This warranty does not cover damage caused by vandalism, rusting, “acts of nature” or any other event beyond the control of the manufacturer.
2. This warranty is nontransferable and is expressly limited to the repair or replacement of defective product. If the product is defective within the terms of this warranty, Lifetime Products, Inc. will repair or replace defective parts at no cost to the purchaser. Shipping charges to and from the factory or distribution center are not covered and are the responsibility of the purchaser. Labor charges and related expenses for removal, installation or replacement of the shed or its components are not covered under this warranty.
3. This warranty does not cover scratching or scuffing of the product that may result from normal usage. In addition, defects resulting from intentional damage, negligence, unreasonable use or hanging from the truss will void this warranty.
4. Liability for incidental or consequential damages is excluded to the extent permitted by law. While every attempt is made to embody the highest degree of safety in all equipment, freedom from injury cannot be guaranteed. The user assumes all risk of injury resulting from the use of this product. All merchandise is sold on this condition, and no representative of the company may waive or change this policy.
5. This product is not intended for institutional or commercial use; Lifetime Products, Inc. does not assume any liability for such use. Institutional or commercial use will void the warranty.
6. Our goods come with guarantees that cannot be excluded under the Australian Consumer Law. You are entitled to a replacement or refund for a major failure and for compensation for any other reasonably foreseeable loss or damage. You are also entitled to have the goods repaired or replaced if the goods fail to be of acceptable quality and the failure does not amount to a major failure.
7. This warranty is expressly in lieu of all other warranties, expressed or implied, including warranties of merchantability or fitness for use to extent permitted by Federal and state law. Neither Lifetime Products, Inc., nor any representative assumes any other liability in connection with this product. This warranty gives you specific legal rights, and you may also have other rights which vary from state to state.