

INTRODUCTION

DANGER: LASER LIGHT IS EMITTED FROM THIS SIGHT. AVOID DIRECT EYE EXPOSURE.

Laser radiation is emitted from the front aperture of the laser when the switch is depressed and the red on indicator is visible. Please read the warning labels found in this manual.

INITIAL INSPECTION

VISUAL

LaserMax products are shipped in anti-static material for protection. If the shipping carton is severely damaged, notify the carrier or dealer immediately for insurance purposes. Refer to the kit drawing on the back cover of this manual for a complete listing of included parts.

QUALITY CONTROL

All LaserMax products undergo extensive inspection and test before shipment. A final test sheet is included for your reference.

CLEANING AND STORAGE

The laser output window may become fogged by smoke during extended firing. To clean, **UNLOAD THE PISTOL AND TURN OFF THE LASER** before cleaning with lens cleaning fluid or alcohol and a soft cloth. Dry cloth is not recommended; this will scar the window surface and degrade beam quality.

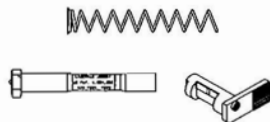

INSTALLATION

SLIDE AND SPRING GUIDE REMOVAL

UNLOADING

Press the magazine catch and remove the magazine.

Clear the chamber by pulling back the slide.

Check the chamber to ensure that there is no round in the chamber.

Push the slide catch lever up to lock the slide in the backward position.

REMOVAL OF THE SLIDE

Secure the pistol with either hand and using the thumb on the other hand, rotate the take down lever 90 degrees clockwise.

The take down lever should be in the vertical position as shown at right.

While holding the frame in one hand and the slide in the other, draw the slide backward slightly to disengage the slide catch lever. Hold the slide firmly and allow it to glide forward gently. Now slip the slide assembly forward and off the frame.

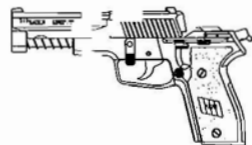

CAUTION

The recoil spring is under compression and is subject to accidental release. The spring and guide can be launched a great distance. Wear protective safety glasses and point the slide assembly in a safe direction while the spring is under compression.

REMOVAL OF THE SPRING AND GUIDE

Grasp the recoil spring and with forceful control, slide it forward about 1/2" and lift it out of the slide.

Remove the spring and guide and place in storage.

TAKE DOWN LEVER REMOVAL

While pushing the take down lever from the far side of the frame with the index finger, use the other hand to pull and rotate the take down lever counter-clockwise to completely remove it. Retain the take down lever in storage, it is not required while the pistol is operated with the LaserMax sight.

CAUTION: Do not pull the trigger or decock the hammer.

If the hammer is returned to the decocked position at this time the locking insert may fall out of the frame.

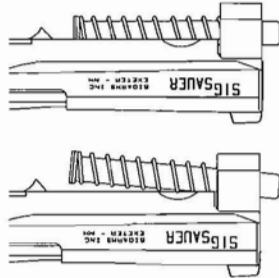

INSTALLATION OF LASER SWITCH/TAKE DOWN LEVER

Caution: Do not pull the trigger or decock the hammer.

If the hammer is returned to the decocked position the locking insert may fall out of the frame making reassembly much more complex. Start the new take down lever/laser switch in the frame hole with the lever in the upward position as shown. Rotate the take down lever counter clockwise while pushing it into the frame. Align the take down lever with the hole in the opposite side of the frame and continue to rotate it counter clockwise while pushing it completely into the frame. The take down lever must end up in the downward position. The laser switch should be centered in the frame before the slide assembly is installed.

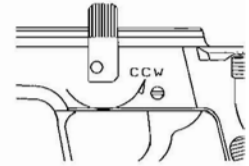

INSTALLATION OF BATTERIES

The batteries must be clean and free of finger oils. Contaminated battery contacts will cause premature failure of the battery. Never mix old batteries with new ones or different types of batteries. Service temperature range is -10°C to +50°C (+14°F to +120°F). Protect the laser sighted pistol from freezing temperatures. Batteries for sub-freezing operation are available; see spare parts list.

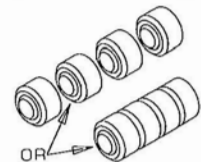

Installation or replacement of the battery set is accomplished by removal of the battery cap from the rear of the

LMS laser spring guide. Hold the laser spring guide in the left hand, and with the right hand push the cap onto the spring guide and simultaneously rotate the cap counter clockwise to remove it. Place [4] new 392 silver oxide cells, ([3] 393 silver oxide cells for a Guide Rod Light), or [1] LaserMax battery pack (see spare parts list) into the battery compartment with the rounded (-) terminal into the tube and the plus side (+) up facing out. Now replace the battery cap by aligning painted tab with painted notch on cap (only one position is possible), pressing down and rotating the cap clockwise. Note: Some resistance will be felt rotating the cap until it is locked into position.

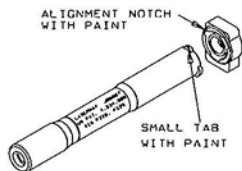
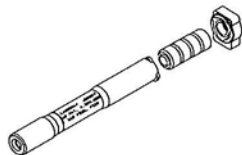

LASER SPRING GUIDE INSTALLATION

Slide the LMS Recoil Spring on the laser sight starting with the end that has the closed coil. Seat the accuracy washer firmly against the battery cap by pushing on the recoil spring.

IMPORTANT: Sig Sauer P229 is available in 9mm, .357 and .40 caliber. The LMS-2291 fits all versions of the P229, but it is essential that the correct recoil spring be used. LaserMax provides two springs for this purpose.

- Use the braided spring for 9mm.
- Use the music wire spring for .357 and .40 caliber.

FAILURE TO USE THE PROPER SPRING WILL DAMAGE THE LASER AND VOID THE WARRANTY.

Caution: The cap has two flats on it. Make sure the shorter flat is down toward the barrel when installing.

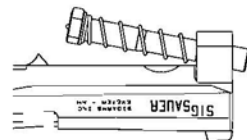

See **CAUTION** on page 5. With the longer flat of the battery cap facing up, firmly grasp the battery cap and insert the assembly into the slide while pushing forward and down. When installing the LMS laser spring guide, be sure that the short flat on the battery cap of the LMS laser spring guide rests centered and flat against the bottom of the front barrel lug as shown at right.

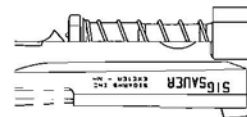

SLIDE INSTALLATION

Reassemble the slide to the frame with the laser sight installed. While pulling the slide completely to the rear, push the slide catch lever up to lock the slide in the backward position. If resistance is felt during assembly, do not force. Remove the slide and assure that the cap and short flat are positioned as required, then attempt assembly again. Rotate the take down lever to the horizontal position and release the slide catch lever.



OPERATION

TURNING LASER/LIGHT ON AND OFF

Cycle the slide fully several times to assure that the LMS sight is seated in the receiver.

Point the Pistol in a safe direction, push in the take down lever/laser switch with your trigger finger until a click is felt, the emission indicator will be visible.

The light should be on or the laser sight should be projecting a pulsing red beam that closely matches the factory open sight.

Turn the laser sight or light off by pressing the take down lever/laser switch in the opposite direction until the red on indicator is not visible.

Pressing the take down lever/laser switch further will turn the sight on again and expose the emission indicator.

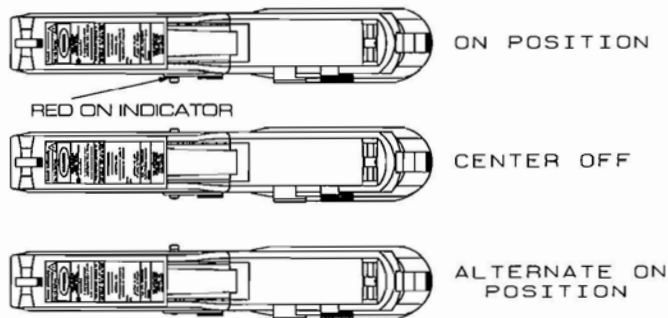

SERVICE

MAINTENANCE

LaserMax recommends purchase of a service kit (see item 3 of spare parts list) after the following number of rounds:

P225, 228, 229 9mm Models:	3,500
P229 .40 SW or .357 SIG:	2,500
P220 .45 ACP and P226 9mm:	5,000

TROUBLE SHOOTING

If the laser fails to operate, please consider the following possibilities:

1. Please review instructions. Cycle the action to assure electrical contact.
2. Are all batteries or battery pack installed with the '+' side toward the battery cap? Are the battery contacts clean?
3. If possible measure the battery voltage. Minimum of 1.5 volts for each cell or 6.0 volts for the 4 pack, 4.5 volts for the 3 pack.
4. Does the battery pin protrude from the plastic cap?
5. Is switch/take down lever installed correctly?
6. Does the frame have excess lubricant?
7. Is the battery temperature above -10°C (14°F) for the standard battery pack or above -25°C (-10°F) for the LMS-410 pack?
8. Is the washer on the laser tube?

OPERATIONAL HINTS

1. This laser sight is designed as a backup for instinctive open sight shooting.
2. This sight is optimized for close combat under low light conditions.
3. Always compare your laser sight point of aim to that of your open sights to assure accuracy before use.
4. Always observe basic firearm safety rules - point the laser in a safe direction, never at another person.
5. Keep a fresh set of batteries for carry and use older batteries for practice.
6. Battery contacts must be cleaned of finger oils before installation.
7. Batteries are available from LaserMax, an electronics, or photo specialty store.

SAFETY AND COMPLIANCE LABELING

Important: Operation of a laser product without the required safety labeling may violate Federal Law.

CAUTION: Install FDA label on the OUTSIDE of the pistol slide.



Please refer to the drawing at right for the proper placement of the label. The label includes the following features:

1. A warning logo that indicates the DANGER of a Class IIIa laser product.
2. An Aperture warning section that indicates the proximity of the aperture through which the laser beam will be emitted.
3. A Certification section states that LaserMax certifies that the product complies with the regulations set by the FDA.
4. An Identification section contains the address of LaserMax and place, month and year of manufacture.

Clean the top of the pistol slide with alcohol or nail polish remover. Install the required label in the position indicated on the top of the slide between the front sight and the ejection port.

SPARE PARTS LIST - LMS-22XX SERIES

Sig Sauer Model #	P220/ P226 (.40/.357)	P225	P226 (9mm)	P228	P229	P226S
LaserMax Model #	LMS-2201/ LMS-2263	LMS-2251	LMS-2261/ LMS-2261S	LMS-2281	LMS-2291	
Light						LMS-2261S-LW
1. Serial # and FDA Warning Label	LMS-300	LMS-300	LMS-300	LMS-300	LMS-300	
2. Recoil Spring	LMS-201	LMS-251	LMS-261	LMS-281	LMS-291	LMS-261
3. Service Kit	LMS-246	LMS-256	LMS-266	LMS-286	LMS-296	
4. Battery Pack (14°F to 120°F)	LMS-392	LMS-392	LMS-392	LMS-392	LMS-392	LMS 3x393
5. Battery Pack (-10°F to 120°F)	LMS-410	LMS-410	LMS-410	LMS-410	LMS-410	
6. Battery Cap/Shock Buffer	LMS-202	LMS-202	LMS-202	LMS-202	LMS-202	LMS-203
7. Take Down Lever/Laser Switch	LMS-200	LMS-200	LMS-200	LMS-200	LMS-200	LMS-200
8. Accuracy Washer	LMS-205	LMS-206	LMS-205	LMS-206	LMS-206	LMS-205
9. LMS-22XX Series manual	LMS-220	LMS-220	LMS-220	LMS-220	LMS-220	LMS-220

LIMITED WARRANTY

LaserMax, Inc. laser products, except expendable parts, are warranted to be free from defects in material and workmanship for a period of three years from the date of purchase, as shown on the warranty card returned to LaserMax. Expendable parts shall be defined as batteries, springs, and replaceable plastic parts. Expendable parts of some models have definite life expectancies. They should be replaced as recommended to protect the laser and preserve your warranty. This warranty shall benefit, and may be enforced only by the initial purchaser of the laser system and is not transferable. Warranty is limited solely to repairing or replacing the part(s), at the discretion of LaserMax, Inc.; which proves to be defective during the warranty period. Parts and equipment replaced under warranty will not be returned. Parts and equipment repaired under warranty will be covered for the remaining portion of the original warranty period. This warranty does not apply to equipment or parts which upon inspection by LaserMax, Inc. are determined by LaserMax, Inc. to have become defective or unworkable due to abuse, mishandling, misuse, alteration, negligence, improper installation or maintenance, damage resulting from use of springs not supplied with laser, damage resulting from repair or attempted repair by anyone other than LaserMax, Inc. or a repair facility authorized by LaserMax, Inc., or other causes beyond the control of LaserMax, Inc. All returns must have factory labeling present and legible. All returns require a return authorization number available from our Warranty Department at 1-800-LASER-03. The hours of operation are from 9 a.m. to 5 p.m. EST, Monday through Friday.

LASERMAX, INC. DISCLAIMS LIABILITY FOR INCIDENTAL AND CONSEQUENTIAL DAMAGES FOR BREACH OF ANY EXPRESS OR IMPLIED WARRANTY. ANY IMPLIED WARRANTY OF MERCHANTABILITY OR FITNESS FOR A PARTICULAR PURPOSE, WITH RESPECT TO THE LASERMAX, INC. LASER PRODUCT IS FOR A PERIOD OF THREE (3) YEARS FROM DATE OF PURCHASE. THIS WARRANTY GIVES YOU SPECIFIC LEGAL RIGHTS, AND YOU MAY ALSO HAVE OTHER RIGHTS WHICH VARY FROM STATE TO STATE.