



# JETBOIL®



## **MIGHTYMO**

**Cooking Stove  
Instructions**



**MIGHTYMO**  
Cooking Stove

**Important:** Read these warnings and instructions carefully prior to assembling or using this product. Fully familiarize yourself with this product before connecting it to a fuel canister. Keep these instructions for future reference.

**⚠ DANGER**

**ONLY USE OUTDOORS IN A WELL-VENTILATED AREA  
IN ORDER TO AVOID ENDANGERING YOUR LIFE**

**⚠ WARNING**

**FIRE OR EXPLOSION HAZARD**

**If you smell gas:**

- 1. Do not attempt to light appliance.**
- 2. Extinguish any open flame.**
- 3. Disconnect from fuel supply.**
- 4. Evacuate immediately.**
- 5. Allow gas to dissipate 5 minutes before relighting the appliance.**

**Failure to follow these instructions could result in fire or explosion, which could cause property damage, personal injury, or death.**

1



**DANGER**

**CARBON MONOXIDE HAZARD**

**This appliance can produce carbon monoxide which has no odor.**

**Using it in an enclosed space can kill you.**

**Never use this appliance in an enclosed space such as a camper, caravan, tent, car, mobile home, marine craft, or home.**

**FOR YOUR SAFETY**

**Do not store or use gasoline or other flammable vapors and liquids in the vicinity of this or any other appliance.**

**⚠ WARNING**

- Do not modify this appliance. This may be hazardous and will void the warranty.
- Burn Hazard - Accessible parts may become very hot.
- Burn Hazard - Keep away from children.
- Do not leave stove unattended while in use.

2

# TABLE OF CONTENTS

# SPECIFICATIONS



GENERAL WARNINGS .....	1
SPECIFICATIONS .....	4
LEAK CHECK PROCEDURE .....	4
FIGURES .....	5
ASSEMBLY .....	6
OPERATING INSTRUCTIONS.....	7
STORAGE AFTER USE .....	9
MAINTENANCE .....	9
TROUBLESHOOTING .....	9

**Gas category:** Direct Pressure – Butane-Propane mixture. Canister must conform to the EN417 or AS2278 standard. This appliance is only intended for use with 100g/230g/450g Jetboil Jetpower Isobutane/Propane Fuel Canisters (sold separately). It may be hazardous to attempt to fit other types of fuel containers.

**Jet Size:** 0.39mm **Gas Consumption:** 11 MJ/hr (AU) || 215 g/hr [3kW] (EU) || 10,000 BTU/hr (CA)

## LEAK CHECK PROCEDURE

1. Perform leak checks outside, in a well-ventilated area.
2. Connect fuel canister (3.1) to valve (3.2) by threading in the orientation shown in Fig 4.
3. Put soapy water on the gas connection between fuel canister and the valve. Formation of bubbles indicate a gas leakage.

**⚠ WARNING** Do not check for leaks using a flame.

**⚠ WARNING** If a leak is detected, do not attempt ignition. Remove fuel canister immediately and contact Customer Service.

4. If no leak is found, detach fuel canister. Leak check is complete.

# FIGURES

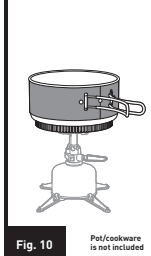
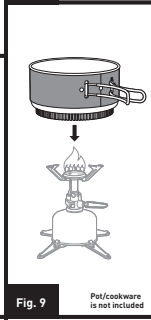
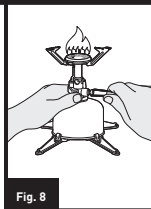
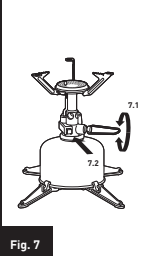
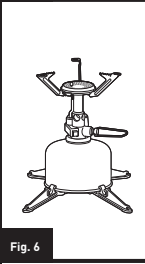
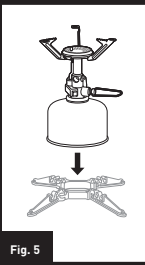
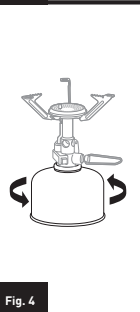
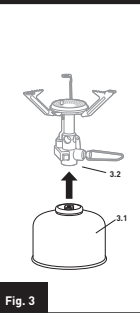
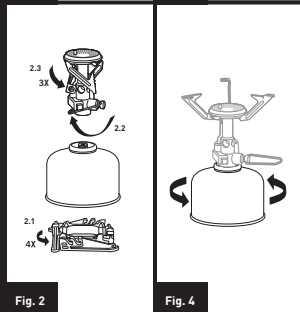
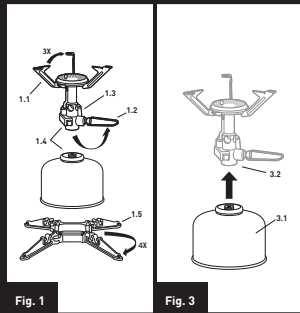

# ASSEMBLY

## ⚠ WARNING

- Perform Leak Checks outside, in a well-ventilated area.
- Operate at least 1m/3.3ft away from combustible materials and ignition sources.
- Before each use: Keep stove area clear and free from combustible materials, gasoline, and other flammable vapors and liquids.
- Do not obstruct the flow of combustion and ventilation air to the stove.
- Do not use windscreen or outback oven; this can overheat the fuel canister, resulting in explosion.
- Do not use an appliance which is leaking, damaged or which does not operate properly.
- Always change gas canisters in a well ventilated location away from any sources of ignition, such as naked flames, pilot, electric heaters/equipment and away from other people.

1. Remove packed contents from pack bag (not shown).
2. Deploy pot support arms (3x) to fully open position (1.1).
3. Unfold the bail (1.2) from the valve body (1.3).
4. Close the control valve (7.1) (turn clockwise).
5. Check for debris in the valve connection (1.4), and that the O-Ring is in place and in good condition before connecting to the stove.

⚠ **WARNING** Do not use the appliance if it has a damaged or worn seal, this may result in gas leakage.

⚠ **WARNING** In temperatures below freezing, O-Rings may not seal fully, resulting in a fuel leak.

6. Perform LEAK CHECK PROCEDURE (See Page 4).
7. To check that the fuel canister is not empty, liquid fuel may be heard and/or felt inside when the canister is shaken.
8. Connect fuel canister (3.1) to valve (3.2) by threading in the orientation shown in Fig 4.  
**⚠ WARNING** Hand tighten only, do not over-tighten or cross-thread. May damage seals resulting in fuel leak.
9. Unfold stabilizer legs (1.5) and securely attach stabilizer to fuel canister (Figs 5-6).
10. Place assembled stove on a flat, level surface, at least 1m/3.3ft away from any combustible materials or ignition sources.

## OPERATING INSTRUCTIONS

### **⚠ WARNING**

- Keep burner at arm's length, away from face, during ignition. Flame can flare during ignition.
- Do not attempt to light with cookware on the burner. Gas build-up can occur, resulting in increased flame eruption.
- Never expose stove to flammable vapors or liquids while lighting the burner. It can cause an explosion or fire.
- Do not move, lift, or tilt stove with lit burner. Product damage or injury can occur due to flaring.
- Always check that the burner is extinguished before disconnecting the fuel canister.

7

### **Preparation:**

**1.** Add contents to cookware, but do not put the cookware on the stove yet. Now you are ready to light the burner.

**⚠ WARNING** Never use cookware larger than 1.5L capacity or 8in [20cm] diameter.

**2.** Test igniter by depressing igniter button (7.2) until click is heard. If it does not spark, refer to Maintenance and Troubleshooting sections.

**NOTICE** Performance may be suboptimal if used in extreme conditions (cold, hot, wind, altitude).

**⚠ WARNING** Do not use stove to warm fuel canister. Can result in explosion.

### **Lighting the Burner:**

**⚠ CAUTION** Ensure burner base is free of any cookware prior to lighting. Gas build-up can occur, resulting in increased flame eruption.

- 1.** Open control valve (7.1) counterclockwise until fully opened and gas flow can be heard.
- 2.** To light, depress Igniter Button (7.2) until click is heard. Repeat as necessary until ignition (Fig 8).
- 3.** If ignition does not occur within 5 seconds, close control valves and wait 5 minutes before repeating the procedure.

### **Usage:**

**1.** If necessary, rotate control valve (7.1) clockwise to decrease flame setting. **2.** Once the burner is lit, carefully place the cookware with its contents on the pot support legs (Figs 9-10).

### **After Use:**

**1.** Turn off control valve (7.1) (tighten clockwise) to extinguish flame.

**⚠ WARNING** Exposed metal parts will be hot and may cause injury if touched.

**2.** Always disconnect fuel canister after use. Unscrew fuel canister from burner base (Fig 4), and replace plastic fuel cap.

**⚠ WARNING** Always check that the burner is extinguished before disconnecting the fuel canister. Fuel vapors can ignite and cause serious injury.

8

## Packing:

**1.** Allow stove to fully cool before packing. **2.** Remove stabilizer from canister and fold for storage [2.1]. **3.** Fold valve bail under valve body [2.2]. **4.** Fold pot support legs into closed position [2.3]

## STORAGE AFTER USE

**1.** Always disconnect fuel canister before storing the stove. **2.** Ensure stove is clean and dry before storing. **3.** Store the stove in a cool, dry location, indoors.

## MAINTENANCE

**1. Flame Check (Every use):** The height of the flame should increase from low to high with counter-clockwise rotation of the control valve. Flame should be blue with no yellow tipping at full output. Flame should not flash back into burner or lift off of burner top. If flame abnormalities are found, see your dealer or contact Jetboil for service.

## TROUBLESHOOTING

**1. Flame does not extinguish:** Tighten valve as much as possible, blow out flame, and immediately detach fuel source. See your dealer or contact Jetboil for service.

**2. Igniter fails to spark:** If igniter will not spark, check positioning of electrode in relation to burner. Approximately 1/8" (3mm) length of igniter wire should protrude from the igniter ceramic. Wire should point toward center of burner with a 1/8" (3mm) gap between the end of the wire and the top surface of the burner. If not positioned as described, re-position the electrode accordingly or pull igniter wire through ceramic and cut wire 1/4" above top of ceramic. Bend wire towards center of burner head and position as described above. If stove is wet, igniter may fail to spark. If igniter fails to spark, use matches or a lighter, following instructions detailed in OPERATING INSTRUCTIONS – Lighting the Burners.

See your dealer or contact Jetboil for service if igniter fails to spark for any other reason.

**3.** If an issue cannot be corrected using these instructions, see Limited Warranty on back page.



Accept no compromises, choose only quality camp kitchen.