

FISHER RESEARCH
LABS

GOLD BUG®

OWNER'S MANUAL

If you do not have prior experience with a metal detector, we strongly recommend that you:

- 1) **Adjust the Gain to a low setting in the event of false signals.** Always begin use at a reduced Gain level; increase Gain only after you have become familiar with the detector.
- 2) **Do not use indoors.** This detector is for outdoor use only. Many household appliances emit electromagnetic energy, which can interfere with the detector. If conducting an indoor demonstration, turn the Gain down and keep the searchcoil away from appliances such as computers, televisions and microwave ovens. If your detector beeps erratically, turn off appliances and lights.

Also keep the searchcoil away from objects containing metal, such as floors and walls.

- 3) Use a 9-volt **ALKALINE** battery.
Do not use Heavy Duty Batteries.

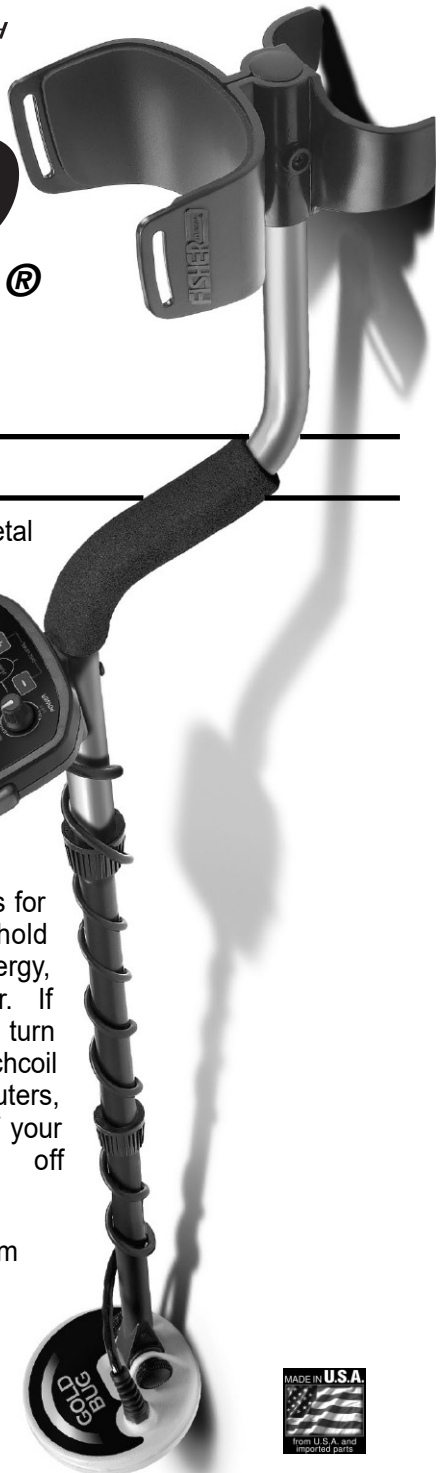

TABLE OF CONTENTS

Introduction	4
Terminology	5
Assembly	6-7
Batteries	8
Quick-Start Demo	9-10
Headphones	10
Basics Of Metal Detecting	11-12
Ground Minerals	11
Trash	12
Identifying Buried Objects	12
Size and Depth of Buried Objects	12
electromagnetic Interference (eMI)	12
Operation and Controls	13
Control Panel	13
<u>Control Knobs</u>	
Off / On / Gain	14
Disc / All Metal / Threshold	15
<u>Touchpad Controls</u>	
Ground Grab® Computerized Ground Balancing / Pinpoint	15
+ and -	15
Operating in All Metal Mode	
Ground Grab® Computerized Ground Balancing	16
Setting the Controls	16
Unwanted Noise	16
Sweeping the Searchcoil	16
reading the Display	17
Target Scale	17
Operating in Discrimination Mode	
Ground Grab® Computerized Ground Balancing	18
Setting the Controls	18
Gain	18
Mode	18
Disc Level	18
Unwanted Noise	18
Sweeping the Searchcoil	18
Using Pinpoint	19
reading the Display	19-21
Ground Balancing	22-24
Ground Balancing Technical Info	25
Target Display & Audio	26
Gold Prospecting	27-28
Hot rocks	29
electromagnetic Interference (eMI)	30-31
Search Techniques	32
Target Pinpointing	33
Optional 11"DD Searchcoil	34
Treasure Hunter's Code of ethics	35
Device Specifications	35
Warranty	36
Accessories	Back Cover

Congratulations!

Congratulations on your purchase of the new Gold Bug® metal detector. The newly designed Gold Bug® has been custom designed to find the smallest gold nuggets, but unlike other specialized gold prospecting detectors, it can also be used for relic-hunting and coin-shooting.

Whether you use your Detector in the backyard, at the shoreline, in the mountains or fields afar, your investment will let you experience the excitement of searching for yet uncovered treasures and give you hours and years of outdoor enjoyment. Out on your own or with a group, places to use your Gold Bug® are unlimited as buried treasures can be as near as your doorstep or as far as you wish to travel.

This manual has been written to help you get optimal use of your detector, so we hope you will read it thoroughly before your first outing and will also refer back to this manual from time to time to reinforce features and methods as you become more proficient in the field.

Happy Hunting from Fisher Research Labs!

Introduction to the Gold Bug®

The new Gold Bug® is unique among gold prospecting metal detectors for its combination of high sensitivity to small gold nuggets and its versatile function as an all-purpose treasure detector.

The controls and features are tailored to gold prospecting, including an advanced ground balancing system, separate control over signal gain and threshold, and a unique discrimination control system. These features also make for a great relic-hunting detector, especially when the Gold Bug® is outfitted with the optional 11" DD searchcoil. While the Gold Bug® makes for a highly competent coin-shooting detector, its user interface and features are not specifically designed for this purpose. As a coin-shooter, you will notice that the Gold Bug® exhibits slightly lower sensitivity to high-conductivity coins, like a U.S. quarter; this is a result of its specialized design to emphasize sensitivity to small, low conductivity metals like gold nuggets.

The Gold Bug® is outfitted with a small 5" searchcoil as standard equipment since this searchcoil construction is best-suited to finding gold nuggets. You may be familiar with other metal detectors which have larger searchcoils, generally in the range of 8 to 10 inches in diameter. Large coils are designed to cover the maximum amount of ground efficiently and for the deepest ground penetration. Small searchcoils, intended for gold prospecting, are designed for precision. The Gold Bug's small DD searchcoil makes pinpointing easier, fits into small spaces where gold is often hidden, is better suited to penetrate highly mineralized soils where gold is frequently found, and has the highest possible sensitivity to tiny gold nuggets.

TERMINOLOGY

The following terms are used throughout the manual, and are standard terminology among treasure hunters.

ELIMINATION

Reference to a metal being "eliminated" means that the detector will not emit a tone, nor light up an indicator, when a specified object passes through the searchcoil's detection field.

DISCRIMINATION

When the detector emits different tones for different types of metals, and when the detector "eliminates" certain metals, we refer to this as the detector "discriminating" among different types of metals.

Discrimination is an essential feature of professional metal detectors. Discrimination allows the user to ignore trash and other undesirable objects.

RELIC

A relic is an object of interest by reason of its age or its association with the past. Many relics are made of iron, but can also be made of bronze or precious metals.

IRON

Iron is a common, low-grade metal that is an undesirable target in certain metal detecting applications. Examples of undesirable iron objects are old cans, pipes, bolts and nails.

Sometimes, the desired target is made of iron. Property markers, for instance, contain iron. Valuable relics can also be composed of iron; cannon balls, old armaments, and parts of old structures and vehicles can also be composed of iron.

FERROUS

Metals which are made of, or contain, iron.

PINPOINTING

Pinpointing is the process of finding the exact location of a buried object. Long-buried metals can appear to the eye exactly like the surrounding soil, and can therefore be very hard to isolate from the soil.

V.C.O.

Meaning "voltage controlled oscillator", the v.C.O. audio method causes both the *audio pitch* and the *volume* to rise as signal strength increases. v.C.O. improves the user's ability to interpret a target's size and depth. Very weak signals (for small or very deeply buried objects) have the faintest volume and the lowest pitch. Larger objects, and those closer to the searchcoil, will induce a higher volume and higher pitch sound.

GROUND BALANCE

Ground Balancing is the ability of the detector to ignore, or "see through" the earth's naturally occurring minerals, and only sound a tone when a metal object is detected. The Gold Bug® incorporates proprietary circuitry and programming to eliminate false signals from severe ground conditions.

ASSEMBLY

Adjusting the Armrest

The armrest may be moved forward or backward by removing the single screw and nut, and then repositioning the 2-piece armrest. Users with shorter arms may find the armrest more comfortable in the forward position. In order to move the armrest backward, the plastic plug must be removed from the aluminum tube.

Armrest Strap

(Optional accessory)

The armrest Strap accessory can be purchased separately. Some users prefer to use the strap when swinging the detector vigorously, in order to hold the detector securely against the arm.

The detector can always be used without the strap, with no compromise to detector balance and stability under most conditions.

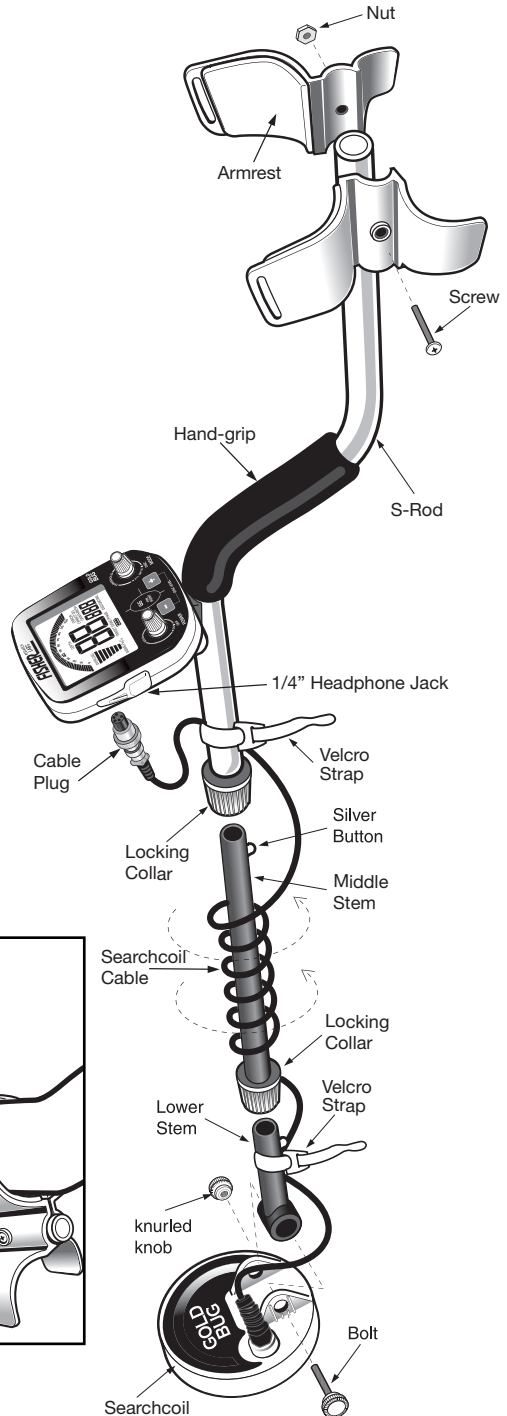
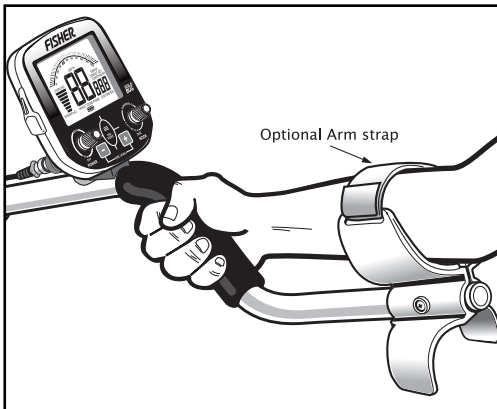

ASSEMBLY

Caution: Forcing in MIDDLE STEM with CAM LOCK raised may form a burr on camlock. If this happens, remove burr with knife to allow insertion.

Assembly is easy and requires no tools.

- 1 Position S-rod upright.
- 2 Rotate the LOCKING COLLAR fully in the counterclockwise direction.
- 3 Insert your finger inside the tube and make sure the INTERNAL CAM LOCK is flush with the inside of the tube.
- 4 Insert the MIDDLE STEM into the S-rod OD, with the SILVER BUTTON pointed upward.
- 5 Rotate the MIDDLE STEM until the SILVER BUTTON locates in the hole.
- 6 Twist the LOCKING COLLAR fully in the clockwise direction until it locks.
- 7 Repeat this process on the LOWER STEM.
- 8 Using the BOLT and KNURL LeD KNOB, attach the SeAr CHCOIL to the LOWER STEM.
- 9 Adjust the LOWER STEM to a length that lets you maintain a comfortable upright posture, with your arm relaxed at your side, and the SeAr CHCOIL parallel to the ground in front of you.
- 10 Wind the CABLE securely around the STEMs, leaving slack at the bottom.
- 11 Connect CABLE PLUG to housing. Do not twist the Cable or Plug. Turn Locking ring only. Use minimal finger pressure to start the threads. Do not cross-thread. When the Locking ring is fully engaged over the threaded connector, give it a firm turn to make sure that it is very tight. When the Locking ring is fully engaged over the threaded connector, it may not cover all of the threads.
- 12 Tighten both LOCKING COLLARs.

* Note: very tall users can purchase the optional extended Lower Stem (TUBe5X), for extended reach.

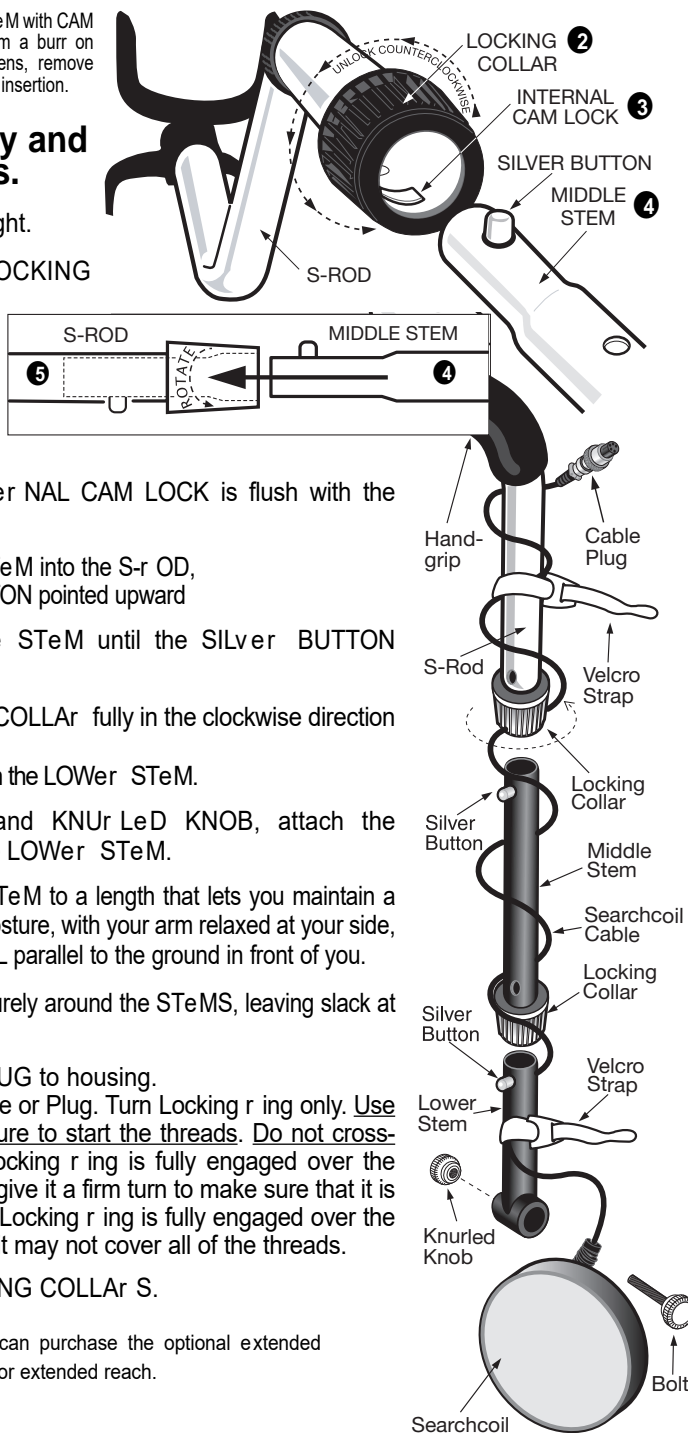

BATTERIES

A 3-segment battery indicator at the bottom of the display indicates the battery condition.

The detector requires a single 9-volt **ALKALINE** battery.

Do not use ordinary zinc carbon batteries.

Do not use “Heavy Duty” batteries.

rechargeable batteries can also be used.

If you wish to use rechargeable batteries, we recommend using a Nickel Metal Hydride rechargeable battery.

The battery compartment is located on the back side of the housing. Slide the battery door to the side and remove it to expose the battery compartment.

BATTERY LIFE

expect about 15 to 20 hours of life from a 9-volt alkaline battery.

rechargeable batteries can provide up to 8 hours of usage per charge.

SPEAKER VOLUME AND BATTERY CHARGE

You may notice the speaker volume drop when only one battery segment is illuminated.

With one segment flashing, low speaker volume will be very apparent.

BATTERY INDICATOR

The 3-segment battery indicator has 4 stages of indication.

These indications are accurate for a 9-volt alkaline battery.

<u>Segments Illuminated</u>	<u>Battery Voltage</u>
3 -segments	more than 8.4 volts
2 -segments	more than 7.5 volts
1 -segment	more than 6.8 volts
1 -segment flashing	less than 6.8 volts

After the 1st segment begins flashing, expect the detector to shut off within 10 minutes.

A rechargeable battery will usually illuminate two to three segments throughout most of its useful charge. But as soon as it drains to the 1-segment level, it will then lose its charge very rapidly.

BATTERY DISPOSAL & RECYCLING

Alkaline batteries may be disposed of in a normal waste receptacle or recycled. Non-Alkaline batteries should be recycled. In the state of California all battery types must be recycled. Please refer to local municipalities for detailed disposal and recycling requirements.

QUICK-START DEMONSTRATION

I. Supplies Needed

- a Nail
- a Zinc Penny (dated after 1982)
- a Nickel
- a Quarter

II. Position the Detector

a. Place the detector on a table, with the searchcoil hanging over the edge.

Or better, have a friend hold the detector, with the searchcoil off the ground.

b. Keep the searchcoil away from walls, floors and metal objects.

c. Remove watches, rings and jewelry.

d. Turn off lights or appliances, whose electromagnetic emissions may cause interference.

e. Pivot the searchcoil back.

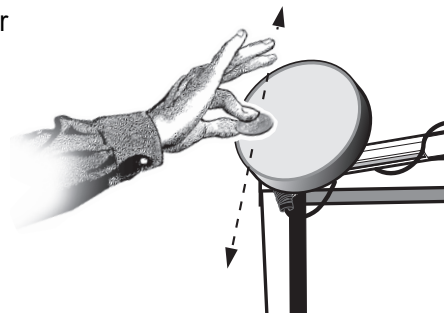

III. Click on detector with the left knob. Set the Gain at the 12:00 position for this demonstration.



IV. Click the right knob to the left to the DISC setting.



V. a. Wave the nail over the searchcoil.

b. Press **+** repeatedly, while continuing to wave the nail.

- Notice the change in sound.

- Sound changes from a HIGH tone to a LOW tone.

VI. Wave each object over the searchcoil

Sweep coin flat and parallel to the searchcoil. This is how you will usually find them buried.

a. Notice the tones and 2-digit Target-IDs for each object.

b. Motion is required.

Objects must be in motion over the searchcoil to be detected in this mode.

VII. Press the **+** button several more times until the Disc value on the display = 60.

VIII. Wave the nail over the searchcoil

a. The nail will not be detected

b. The nail has been “discriminated out.”

Quick-Start Demo continued on next page

QUICK-START DEMONSTRATION

- IX. **Press-and-hold**  and hold the nickel over the searchcoil
- Notice that motion is not required.
A motionless object induces a hum.
 - Notice the variable pitch & volume hum.
 - Move the nickel closer to and farther away from the searchcoil.
Notice the changing “depth” values.

X. **Click the MODE knob to the right**

The detector is now in the All Metal Mode

- Keep GAIN set at the 12:00 position
- rotate the THRESHOLD knob **slowly** from the far counterclockwise position to the full clockwise position.
Notice these attributes of the THRESHOLD control, with no metal over the searchcoil.
 - at low settings you will hear no sound
 - at mid-scale, there will be a transition point from no sound to a barely audible, choppy sound.
 - at full scale you will hear a loud, constant tone. It may also have an irregular or choppy sound, as a result of electromagnetic Interference (eMI) emitted from other electrical devices.

Use with headphones (not included)

The Gold Bug® is equipped with a 1/4” headphone jack. Any headphones with a stereo plug will work; headphones with a mono plug will not work. Using headphones extends battery life, and also prevents the sounds from bothering bystanders. It also allows you to hear subtle changes in the sound more clearly, particularly if searching in a noisy location. Gold nuggets are often very small, so closely monitoring changes in sound using headphones will improve your gold prospecting results. For safety reasons, do not use headphones near traffic or where other dangers, like rattlesnakes, are present. This device is to be used with interconnecting cables/headphone cables shorter than three meters.

THE BASICS OF METAL DETECTING

A hobby metal detector is intended for locating buried metal objects. When searching for metals, underground or on the surface, you have the following challenges and objectives:

1. Ignoring signals caused by ground minerals.
2. Ignoring signals caused by metal objects that you do not want to find, like pull-tabs.
3. Identifying a buried metal object before you dig it up.
4. estimating the size and depth of objects to facilitate digging them up.
5. eliminating the effects of electromagnetic Interference (eMI) from other electronic devices.

Your Gold Bug® metal detector is designed with these things in mind.

1. Ground Minerals

All soils contain minerals. Signals from ground minerals can interfere with the signals from metal objects you want to find. All soils differ, and can differ greatly, in the type and amount of ground minerals present. You therefore want to *calibrate* the detector to the specific ground conditions where you are hunting. The detector incorporates automated ground balancing which will eliminate false signals from most types of soils. To maximize the detector's Target Identification accuracy and depth of detection, use the Gr OUND Gr AB® Computerized Ground Balancing function to calibrate the detector to the ground where you are searching. See the section on Gr OUND BALANCING for details.

The Basics continued on next page

2. Trash

If searching for coins, you want to ignore items like aluminum foil, nails and pull-tabs. These undesirable items are generally identified toward the lower end of the 0-100 scale. You can listen to the sounds of all objects detected, and decide on what you want to dig up. Or you can eliminate unwanted metals from detection by using the DISCr IMINATION feature.

3. Identifying Buried Objects

Different types of metals are classified along the arc at the top of the screen on a 0-100 scale from left to right. A 2-digit numerical reading is also provided in the middle of the display for more precise Target Identification in Discrimination Mode.

4. Size and Depth of Buried Objects

When using the detector in the motion DISC Mode, the relative depth of an object is displayed to the left of the display over the SIGNAL strength indicator. A more accurate depth reading is available using PINPOINT. Pinpoint displays target depth, in inches. The Pinpoint Mode does not require the searchcoil to be in motion to detect metals. The ability to hold the searchcoil motionless over the target also aids in tracing an outline of the buried object, or in pinpointing the exact location of the object using techniques described in the pinpointing section of this manual.

5. Electromagnetic Interference (EMI)

electromagnetic interference (eMI), can cause a metal detector to chatter spontaneously, to lose sensitivity for no apparent reason, or to cause a periodic wobbly audio sound. Common sources of eMI include power lines, electronic communication equipment such as cellphones, fluorescent lamps, military electronics such as radar, other metal detectors and computer equipment.

Your first line of defense against eMI is to reduce the Gain and/or Threshold. In areas with heavy eMI, operating at reduced sensitivity levels will result in the loss of some depth, but at least the metal detector will be usable.

See the 2-page section on eLeCTr OMAGNeTIC INTer Fer eNCe (eMI) for a more thorough explanation of eMI and how to manage it.

OPERATION & CONTROLS

POWERING UP

NOTE: Immediately after powering on, your detector's unique 10-digit serial number is displayed once on the LCD. Two digits are displayed at a time; five 2-digit numbers are displayed in sequence. This 10-digit serial number is the same serial number imprinted on the label inside the battery compartment.

- Click the left knob to turn the detector ON.
- After clicking the knob on, continued clockwise rotation will increase the “sensitivity” in DISC Mode or the “GAIN” in ALL MeTAL Mode.
- We suggest keeping the GAIN below 70 until you become familiar with the detector’s operation.

HOW TO WORK THE CONTROLS

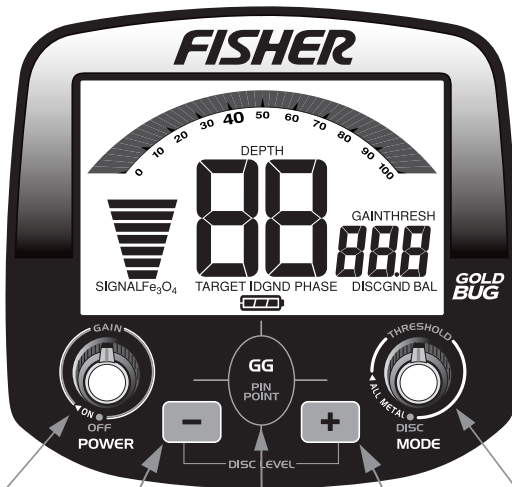

ON/OFF/GAIN:

- Click ON/OFF
- In DISC Mode rotate to change GAIN (sensitivity) from 1 to 100
- In ALL METAL Mode rotate to change GAIN from 5 to 100 in steps of 5

- In DISC Mode press-and-hold to enter no-motion PINPOINT Mode
- In ALL METAL Mode press-and-hold while bobbing coil, to set ground balance

MODE SELECTION and THRESHOLD CONTROL

- Click left to operate in Discrimination Mode
- Click to right to operate in ALL METAL Mode.
- Rotate knob in ALL METAL Mode to change THRESHOLD from -40 to 40

In DISC Mode:

Change discrimination level from 0 to 80

CONTROL PANEL

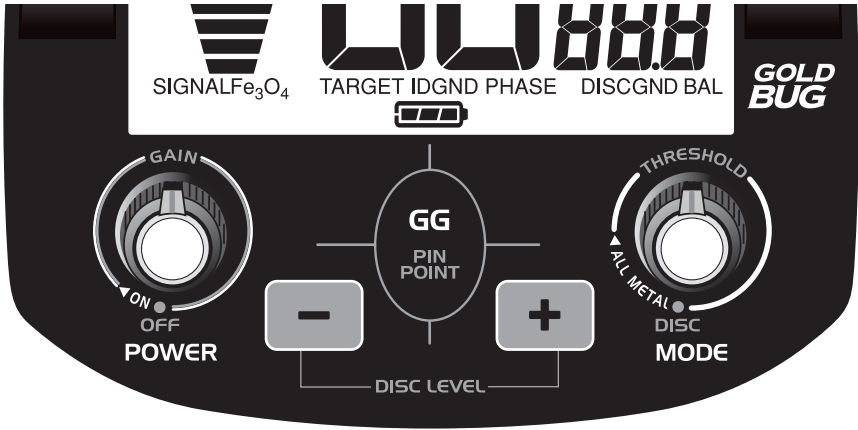

CONTROL KNOBS:

1. OFF/ON/GAIN

- Click right to turn on. Click left to turn off.
- Turning the knob clockwise increases the detector's sensitivity; the higher the sensitivity, the deeper targets will be detected, and the more likely the detector will be to detect very small targets.
- As you turn the knob, notice that the GAIN value at the bottom-right of the screen displays your current sensitivity setting.

Sensitivity in DISC Mode

The left knob is labeled "GAIN" and in DISC_r IMINATION Mode it alone controls the sensitivity of the detector.

GAIN in ALL METAL Mode

In All Metal Mode, GAIN increases as you rotate the knob clockwise. The THRESHOLD is controlled independently using the right knob.

2. DISC / ALL METAL / THRESHOLD

- Click knob to the far-left "DISC" position and the detector enters DISC_r IMINATION Mode.
- Click on clockwise to operate in ALL MeTAL Mode.
- In ALL MeTAL Mode, rotate knob to increase the threshold. Threshold values range from -40 to +40. In ALL MeTAL Mode, the Threshold control can be used in two ways.

Control knobs continued on next page

CONTROL PANEL

GAIN versus THRESHOLD

“Gain” increases, or multiplies, the strength of signals from buried metal objects. For maximum detection of the smallest or most deeply buried objects, increase the Gain. To minimize the weakest signals, reduce the Gain.

“Threshold” controls the detector’s audio level. Positive threshold values amplify the audio response of weak target signals. Negative threshold values suppress sensitivity.

For searching at maximum sensitivity, first set the gain at a low level. Then set threshold into the positive region, with a comfortable background-hum volume level. Then increase Gain to a comfortable level, free of chatter.

For silent searching, set threshold to a negative number, and also reduce Gain if necessary. Silent searching will result in the loss of some sensitivity.

TOUCHPAD CONTROLS

1. GROUND GRAB® COMPUTERIZED GROUND BALANCING / PINPOINT

This button has a dual function, depending on the detection mode.

- a. In DISC Mode, press-and-hold the button to activate PINPOINT.

Pinpoint temporarily engages a no-motion detection mode. Searchcoil motion is not necessary to detect metal. Any metal within the searchcoil’s detection field will induce a sound. Pinpoint is generally used to verify a target previously detected in Discrimination Mode.

- b. In ALL MeTAL Mode, press-and-hold the button to activate Gr OUND Gr AB® Computerized Ground Balancing.

Ground Grab® Computerized Ground Balancing allows you to set the detector’s internal ground setting equal to the phase of the ground you are searching over. See the section on Ground Balancing for a more thorough explanation of this feature and the reason for using it.

2. + and -

In Discrimination Mode, + and - change the level of discrimination (target rejection)

OPERATING IN ALL METAL MODE

The All Metal Mode is more sensitive than the Discrimination Mode, and is used to find all types of metal objects in the ground. The searchcoil must be in motion for objects to be detected.

Ground Grab® Computerized Ground Balancing

Naturally occurring minerals in soil look like metal to a metal detector, so you want to *cancel out* this mineral signal coming from the ground, and only detect the signal from metal objects in the ground.

So before using your detector, set it in All Metal Mode and perform the automatic ground balancing procedure. Press-and-hold the **Ground Grab® Computerized Ground Balancing** button while pumping the searchcoil up and down over the ground. Release the button when the sound *evens out*. The GND BAL number on the bottom right of the screen is the detector's internal setting which cancels out the minerals in the ground. Different soils in different areas will require different GND BAL settings, so balance to ground before you search.

Refer to the Ground Balancing section of this manual for a more in-depth explanation.

Setting the Controls

As you adjust any of the controls, notice that the values on the bottom-right of the display indicate the settings of the value you are changing.

If you are new to metal detecting, start with the GAIN and THRESHOLD controls at a low enough setting that you do not hear too many unwanted sounds, like warble or a loud hum. Set the GAIN at the 12:00 position, or less. Then set the THRESHOLD to a position where you hear a very slight background hum, or if you prefer, dial the control just left of that position to a setting where the detector is silent.

Unwanted Noise

Read the section on electromagnetic Interference (EMI).

The Gold Bug® is a highly sensitive device.

It is intended for use outdoors. Indoor operation will subject it to interference from a wide variety of devices in the home or office.

Sweeping the Searchcoil

As you sweep the searchcoil over the ground, try to keep the searchcoil parallel to the ground.

Avoid lifting the searchcoil at the end of your sweeps.

Operating in All Metal Mode continued on next page

Reading the Display

Most gold prospecting and relic hunting is done by ear. Listen for the louder sounds, riding on top of the constant background hum.

As you sweep the searchcoil, notice the Fe_3O_4 (iron oxide) scale to the left of the display.

This indicates the *amount* of ground mineralization.

Most black sand is made of magnetite.

Gold nuggets are often found in concentrated black sand deposits.

For the best depth detection in highly mineralized soils, use the All Metal Mode.

For the most accurate Fe_3O_4 reading, pump the searchcoil over the ground.

While sweeping the searchcoil, also notice the **GND PHASE** value in the middle of the screen.

GND PHASE is the ground phase; this indicates the *type* of minerals in the soil.

Within an area, the ground phase may change.

After ground balancing, periodically compare GND PHASE to GND BAL. If these two numbers differ by a great deal, you may want to ground balance the detector again.

When not adjusting the knobs, the **GND BAL** setting will always appear on the bottom-right of the display.

GND BAL is the detector's internal ground balance setting. The detector's default ground balance setting is 82.9, which is the best starting point for achieving the correct setting.

After you perform the Ground Grab[®] procedure, the GND BAL number will change to match your soil.

Target Scale

The arc across the top classifies metal objects.

each time a target is detected, three segments will illuminate above the arc.

The segments will remain illuminated for three seconds.

This indication shows the approximate classification of the buried metal object.

See the section on Target Display for a more detailed explanation.

Iron is on the left. U.S. dimes and quarters are to the far right.

In an air test, gold indicates right of center – the larger the gold piece, the farther to the right.

In the ground, the ID of gold may jump around with each pass of the searchcoil.

If searching in All Metal Mode, you may want to switch back into Discrimination Mode, after finding a target, to see a more accurate Target Identification, viewing the 2-digit Target-ID.

OPERATING IN DISCRIMINATION MODE

Discrimination is used to eliminate trash metal objects (e.g. nails, foil, pull-tabs) from detection. The searchcoil must be in motion to detect metal. The Discrimination Mode is less sensitive to small and deep objects than the All Metal Mode.

Ground Grab® Computerized Ground Balancing

This feature is not available in Discrimination Mode.

Your best results will be achieved by first performing the Ground Grab® Computerized Ground Balancing procedure in All Metal Mode.

The ground balance setting achieved using Ground Grab® Computerized Ground Balancing will carry over into this mode.

Setting the Controls

As you adjust any of the controls, notice that the values on the bottom-right of the display indicate the settings of the value you are changing.

GAIN

If you are new to metal detecting, start with the GAIN at a low enough setting that you do not hear any sounds when the searchcoil is sweeping across the ground, with no metal present. Start with GAIN at the 12:00 position, or less.

In this mode, Gain refers to the detector's sensitivity. The higher the setting, the deeper objects can be found, and the more sensitive the detector is to very small metal objects.

MODE

The right knob is not used in the Discrimination Mode.

Click the right knob 100% counterclockwise.

If you turn the knob to the right, you will leave Discrimination Mode, entering All Metal Mode.

DISC LEVEL

Press **+** to eliminate unwanted metals from detection.

each time you press **+** the Disc value at the bottom-right of the display will increment by one.

Press-and-hold **+** to increase the Discrimination level rapidly.

See the Target Identification section of the manual for a detailed description of this function.

Sections of the arc with no indication represent metals completely eliminated from detection.

Sections of the arc with a lightly shaded indication represent metals detected with a low tone.

Press **-** to detect metals which were previously eliminated from detection

Unwanted Noise

read the section on electromagnetic Interference (eMI).

This is a highly sensitive device.

It is intended for use outdoors. Indoor operation will subject it to electrical interference from a wide variety of devices in the home or office.

In Discrimination Mode, when you sweep the coil over the ground it will usually be quieter than when holding the detector still.

Sweeping the Searchcoil

As you sweep the searchcoil over the ground, try to keep the coil parallel to the ground.

Avoid lifting the searchcoil at the end of your sweeps.

Operating in Discrimination Mode continued on next page

OPERATING IN DISCRIMINATION MODE

Using PINPOINT

Press-and-Hold the Pinpoint button to narrow down the location of a buried metal object. Pinpoint is a mode of detection which does not require the searchcoil to be in motion.

A motionless searchcoil held over a metal object will induce a hum; volume and pitch of the hum increase with target strength.

The approximate target depth, in inches, will be indicated in the center of the screen.

The depth scale is calibrated to coin-sized objects.

Relative depth is indicated for larger or smaller objects.

Upon releasing the button, you will return to the motion Discrimination detection mode.

If you keep the Pinpoint button depressed for a long time, the audio tone may begin to drift.

If you plan to search like this, release and re-press the button periodically to avoid drift. Drift may result in a loudening sound or a reduced sensitivity with no sound.

See the manual section on Target Pinpointing for how to *narrow down* a target's location.

This technique is indispensable as long-buried metals can look exactly like the surrounding soil to the naked eye. If you are not adept at pinpointing, digging up a small metal object can be very frustrating. So learn how to *narrow-it-down*.

READING THE DISPLAY

TARGET-ID

Each time you pass the searchcoil over a metal object, a 2-digit value will appear in the center of the display. See the manual section on Target Identification for a better understanding of these values.

Three segments will simultaneously appear above the arc at the top of the screen.

This represents the same Target Identification, but displayed graphically within the scale.

TARGET SCALE

This display works as in the All Metal Mode.

The arc across the top classifies metal objects.

Each time a target is detected three segments will illuminate above the arc.

The segments will remain illuminated for three seconds.

This indication shows the approximate classification of the buried metal object.

See the section on Target Display for a more detailed explanation.

Iron is on the left. U.S. dimes and quarters are to the far right.

In an air test, gold indicates right of center – the larger the gold piece, the farther to the right.

In the ground, the ID of gold may jump around with each pass of the coil.

SIGNAL

Each time a target is detected, bars will illuminate on the bottom left showing the strength of the target's signal.

If all 7 bars illuminate, the target signal is strong.

This may be a large metal object.

Or it may be a coin-sized metal object close to the surface.

If only a few bars illuminate, the target signal is weak.

This may be a deeply buried object, even a big one.

Or it may be a very, very small metal object, close to the surface.

The depth of a coin-sized object can be confirmed using Pinpoint.

OPERATING IN DISCRIMINATION MODE

In Discrimination Mode, pressing **+** or **-** will change two detection parameters:

1. Tone Identification
2. Target elimination

As the level of discrimination changes, the target segments along the arc on the screen will be displayed in one of three states:

1. Blank (no segments displayed)
2. Grey (segments displayed in a shaded color)
3. Black (segments are solid black)

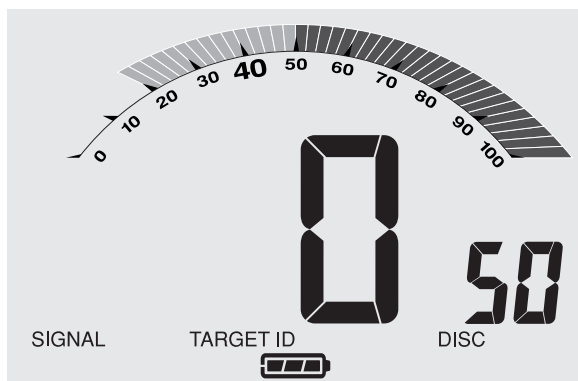

The segments along the arc will remain illuminated in this state as you are pressing **+** or **-**.

This displays your chosen target discrimination parameters.

At any time during operation, you can view the discrimination settings in one of two ways:

1. On the bottom-right of the screen the DISC value is always illuminated.
 - a. This value is the division between the LOW tones and HIGH tones.
 - b. This value is the lowest target value which will be detected with a HIGH tone.
2. Whenever you press **+** or **-**, the arc will illuminate and show your current detection parameters.

The first press of **+** or **-** will change the discriminate level by one value.

When a target is detected, the rectangular segments representing the target category are illuminated.

Discrimination Control continued on next page

OPERATING IN DISCRIMINATION MODE

Notice the segment status along the arc, and the discrimination parameters they represent, vary as you adjust the discrimination level with + or -.

For DISC values (at bottom right-hand corner of screen) up to 40:

- Operation is **tone discrimination** only
 - No targets are eliminated from detection
- Target-IDs less than the DISC value induce a LOW tone
 - r epresented by *shaded* segments
- Target-IDs greater than the DISC value induce v.C.O. audio
 - r epresented by *solid* segments

for DISC values between 41 and 79:

- Targets in the *blank* segment region are not detected.
- Target-IDs less than the DISC value induce a LOW tone
 - r epresented by *shaded* segments
- Target-IDs greater than or equal to the DISC value induce v.C.O. audio
 - r epresented by *solid* segments

at DISC value = 80:

- All detected targets induce HIGH tones.
 - r epresented by *solid* segments
 - There are no LOW tones
- No targets under 80 are detected.

Suggestion: Try changing the settings, watch the screen, and pass objects over the searchcoil at each setting. It will quickly become obvious how these controls work.

Here is an example of one possible setting:

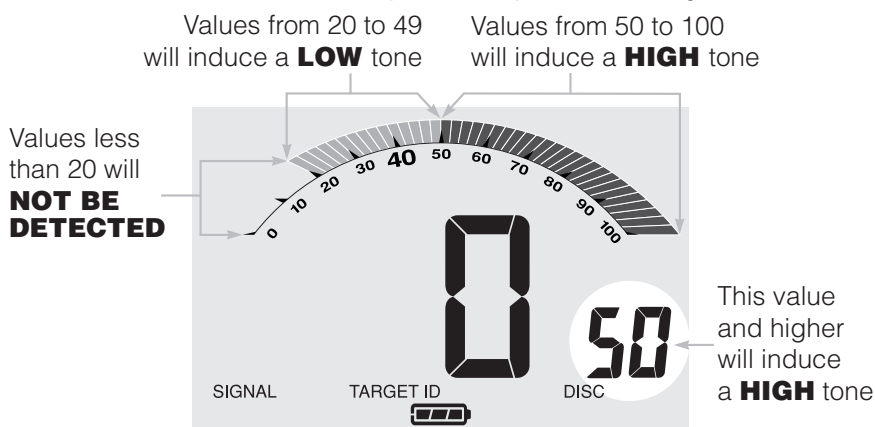

This discrimination interface for the Gold Bug® was designed especially for relic-hunting. Relic hunters want control over what sizes of iron are detected, and also control over which targets are detected with a low-tone. Target values of 40 or less are ferrous.

GROUND BALANCING

What is Ground Balancing? Why do I need to Ground Balance?

All soils contain minerals. Signals from ground minerals are often tens or hundreds of times stronger than a buried metal object. The magnetism of iron minerals, found in nearly all soils, causes one type of interfering signal. Dissolved mineral salts, found in some soils, are electrically conductive, causing another type of interfering signal.

Ground Balancing is the process by which the metal detector cancels the unwanted signals coming from the ground minerals while still detecting the signals from buried metal objects. This is accomplished by matching the detector's ground balance setting to the phase of the ground signal.

When the detector is calibrated to the soil, the result will be deeper target detection, quieter operation, and more accurate Target Identification.

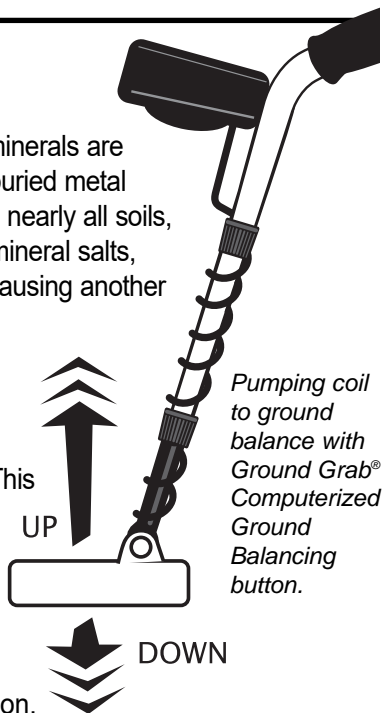

How to Ground Balance your detector:

Ground Balancing procedure with the Ground Grab® Computerized Ground Balancing touchpad.

1. Turn the detector on and set GAIN at the 12:00 position.
2. Click on the right knob to the ALL MeTAL Mode.
3. r o t a t e the THR eSHOLD control knob to the point where you hear a slight background hum.
4. Sweep searchcoil across the ground to find a clear patch of ground with no metal present.
5. Press and hold the Gr OUND Gr AB® Computerized Ground Balancing touch pad, and pump searchcoil over the clean ground. *See illustration above.*
Pump searchcoil from within 1" of ground to 6"- 8" above ground.
6. When the GND PHASe *settles down* to only 1 or 2 numbers in variation, release the GND Gr AB button while still pumping the searchcoil. Note that the audio response to the ground changed and "evened Out" when you released the button. Also note that the GND BAL value changed. After balancing, you can hunt in ALL MeTAL... or return to Disc Mode.

The most accurate GND PHASe value is the value displayed when "pumping" the searchcoil over the ground in an area free of metal.

Ground Balancing continued on next page

GROUND BALANCING

Understanding ground conditions assists the user in setting up the machine, knowing when to readjust ground balance, and in understanding the responses of the machine while searching.

This detector displays two kinds of ground data:

1. The *type* of mineralization (which affects where the ground phase should be set). This is **GND PHASE**
2. The *amount* of mineralization (the greater the amount of mineralization, the greater the loss of detection depth & ID accuracy; this loss is more pronounced in Discrimination Mode). This is **Fe₃O₄**.

The goal of ground balancing is to equate the GND BAL number to the PHASe number.

PHASe is the measurement of the ground.

GND BAL is the detector's internal setting which calibrates the detector to the ground's phase.

Notice that the GND BAL number is three digits, with a decimal point. PHASe has only two digits.

GND BAL is a higher resolution number, so may differ a bit from PHASe in a perfectly balanced scenario.

After pumping and releasing Ground Grab® Computerized Ground Balancing, the exact measurement of the ground will be transferred to the GND BAL setting.

The two-digit PHASe number displayed on the screen indicates the *type* of ground mineralization.

Some typical ground mineralization types are:

- 0 – 10 Wet salt and alkali
- 5 – 25 Metallic iron. very few soils in this range. You are probably over metal.
- 26–39 very few soils in this range -- occasionally some saltwater beaches
- 40–75 red, yellow and brown iron-bearing clay minerals
- 75–95 Magnetite and other black iron minerals

GROUND BALANCING

The goal of the Ground Balancing procedure is to eliminate the sound as the searchcoil is being pumped over the ground. In some soils, the sound is not completely eliminated.

If the ground balance adjustment is incorrect, there will be a difference in the sound as the searchcoil is either moving toward or away from the ground. It sounds like you are either ***pulling the sound out of the ground***, or ***pushing the sound into the ground***. If either of these conditions exists, repeat the ground balancing procedure.

POSITIVE AND NEGATIVE RESPONSE

The purpose of ground balancing is to adjust the metal detector to ignore ground minerals. If the setting is incorrect, ground minerals will give either a *positive* or a *negative* response, depending on which direction the adjustment is off.

Positive Response

If the GND BAL setting is too high a number, the response of minerals will be *positive*. This means that when the searchcoil is lowered to the ground in PinPoint or All Metal Mode, the sound will get louder as the searchcoil approaches the ground. The sound will grow quieter as the searchcoil is raised. What, if anything, you will hear in Discrimination Mode depends on the discrimination setting.

When searching in an All Metal Mode, if ground balance is properly set to cancel the ground, and you sweep over a *positive hot rock*, the rock will give a “zip” sound similar to that of a metal object.

Negative Response

If the GND BAL setting is too low a number, the response of minerals will be *negative*. When the searchcoil is lowered to the ground in PinPoint or All Metal Mode, the machine will be silent. The machine will sound off as the searchcoil is lifted away from the ground. What, if anything, you hear in Discrimination Mode depends on the Discrimination setting.

When searching in All Metal Mode a *negative hot rock* will produce a “boing” sound after passing over it, making it difficult to know where it is located. It will not have the sound and “feel” of a metal object.

GROUND BALANCING -Technical Info

Fe₃O₄ BARGRAPH

The Fe₃O₄ 7-segment bar graph indicates the *amount* of ground mineralization, independent of type, expressed as an equivalent volume concentration of magnetite (Fe₃O₄). It updates every second. It is sensitive to motion and will give the most accurate readings if you *pump* the searchcoil up and down several times over the ground. The presence of metal or "hot rocks" will cause the readings to be inaccurate. If you stop moving the searchcoil, the bar graph will go blank.

INDICATION	RELATIVE MINERALIZATION	% Fe₃O₄	SUSCEPTIBILITY
7 Bars	High	over 1	over 2500
2 to 6 Bars	Medium	.026 - 1.0	61 - 2,500
1 Bar	very Low	0.006 - .025	15 - 60
none	--	less than .006	less than 15

Magnetic susceptibility is expressed in micro-cgs units. In a saltwater environment in the absence of iron minerals, the bar graph indicates relative electrical conductivity.

In soils with greater than 10,000 micro-cgs units magnetic susceptibility, the signal from the soil may saturate, or overload, the circuitry. This will not harm the detector but the machine will not be usable in that condition. The solution is to hold the searchcoil several inches above the soil surface so it is not "seeing as much dirt." By listening and watching you will know how high you need to hold the searchcoil in order to avoid overload.

The highest magnetic susceptibilities are usually found in soils developed over igneous rocks, in alluvial black sand streaks on beaches, and in red clay soils of humid climates.

The lowest magnetic susceptibilities are usually found in white beach sands of tropical and subtropical regions, and soils developed over limestone.

TARGET DISPLAY and AUDIO

SIGNAL Indicator

The lower-left bargraph designates SIGNAL strength only when operating in Discrimination Mode.

The signal strength indicator at the bottom-left of the screen indicates how large or close the buried metal target is.

If all bars are illuminated, the target is large or close to the searchcoil.

If one or two bars are illuminated, the target is far away or small, or both.

DEPTH Indicator

When operating in Discrimination Mode, a target's location and size can be verified using the PINPOINT control.

Press PinPoint to temporarily detect metal without searchcoil motion, and a monotone hum.

While holding the PinPoint button, the DePTH indicator will appear. The number beneath DePTH represents the distance of the object, in inches, from the searchcoil. The Depth scale is calibrated to coin-sized objects. For objects other than a coin, the numeric value is a relative measure of the target's depth.

AUDIO FEEDBACK

When a target is detected, the Gold Bug® will respond with two types of sound:

1. v.C.O. (voltage Controlled Oscillator) is an audio response with variable pitch and volume.
2. LOW or HIGH tone beeps.

In Discrimination Mode, targets which fall into the zone along the arc whose segments are *shaded* will be identified with a LOW tone beep and *solid* segments with a HIGH tone.

As the user sets the discrimination level with the + and - buttons, he is determining which targets will induce the low tone, and which will be eliminated.

All targets' audio responses in All Metal Mode will be v.C.O.

V.C.O. (voltage Controlled Oscillator) is an audio response which provides a good feel for the target.

The stronger the target signal, the higher the volume and the higher the audio pitch. very weak signals will have the faintest volume and lowest pitch.

For this reason, the use of headphones is always recommended for detecting the smaller and deeper targets.

2-DIGIT TARGET INDICATOR

In Discrimination Mode the 2-digit target indicator, in the middle of the screen, provides a specific target value to help identify buried targets more accurately. With practice in the field, you will learn to associate target values with the probable identification of buried objects. The target value can vary each time the searchcoil passes over the target, depending upon the orientation of the object and its distance from the searchcoil.

As a starting point, refer to the table below.

TARGET Readout

The table below lists some common approximate target values. With experience in the field, you will recognize many types of metal objects by their numeric value.

OBJECT	TARGET-ID
foil from gum wrapper	47 - 48
U.S. nickel (5¢ coin)	typically 58
aluminum pull-tab	60 - 75
aluminum screw cap	70 - 80
zinc penny (dated after 1982)	typically 78
aluminum soda pop can	75 - 85
copper penny, clad dime	typically 83
U.S. quarter (25¢ coin), clad	typically 85
50¢ coin, modern clad	typically 87
old silver dollar coin	typically 89
US silver eagle \$1 coin	typically 91

Caution: The target indications are visual references. Many other types of metal can also be represented by a given Target-ID

GOLD PROSPECTING

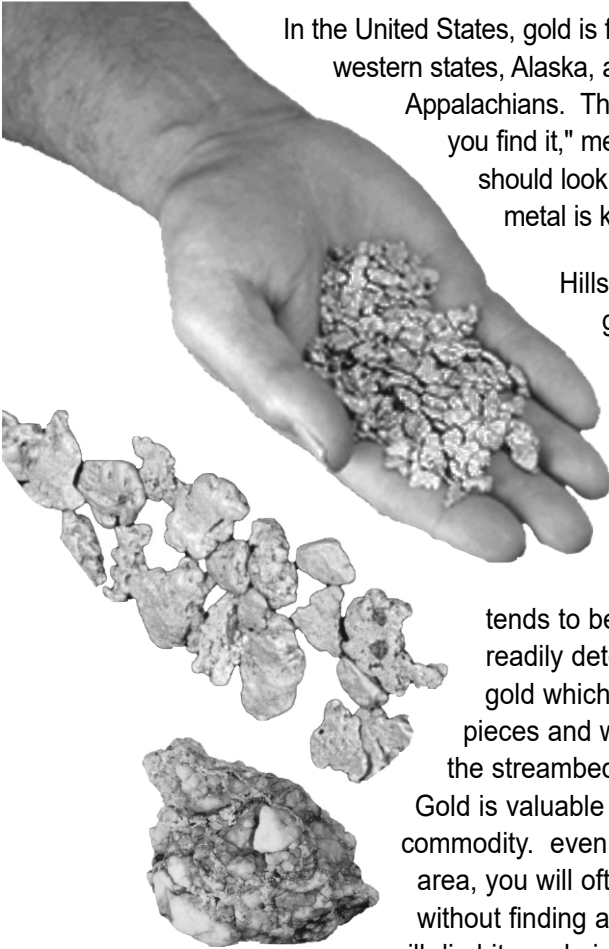

In the United States, gold is found in many places in the western states, Alaska, and in a few localities in the Appalachians. The old saying "Gold is where you find it," means that to find gold, you should look in areas where the yellow metal is known to be present.

Hillsides are the best areas for gold prospecting using a metal detector, because hillsides cannot be cleaned out by panning and dredging the way streams can. Also, gold on hillsides, not far from its source vein,

tends to be larger, and hence more readily detected, than alluvial (placer) gold which tends to get pounded to pieces and worn away as it rolls along the streambed with gravel during floods.

Gold is valuable because it is a scarce commodity. even in a good gold producing area, you will often spend an entire day without finding any gold. Meanwhile you will dig bits and pieces of other metal--

birdshot, shells and bullets from hunting and target practice, bits of rusted barbed wire, chips off shovels and other mining tools, rusted tin cans, etc. Hot rocks -- rocks containing concentrations of iron oxides that sound like metal when you pass over them -- are also a nuisance in many gold areas. Discrimination is usually ineffective because the loss of sensitivity resulting from discrimination is enough to cause those little nuggets to vanish. If you have gone many hours without finding gold and are wondering if there is something wrong with your metal detector or how you are using it, the most important clue is this: if you are digging *tiny* pieces of trash metal, then if gold were present you would have found small gold pieces too!

Gold Prospecting continued on next page

GOLD PROSPECTING

Because most gold nuggets are tiny, and are usually found in soil which is high in iron oxide minerals, serious gold prospecting requires a detector with high sensitivity and true ground balanced All Metal operation. run the machine with the sensitivity high enough to hear some noise from ground minerals, and *learn the language* of the sounds you hear. Headphones are recommended unless consideration for safety (for instance rattlesnakes) rules them out. Move the searchcoil slowly and deliberately, carefully controlling its height above the ground to minimize noise from iron minerals in the soil. If you hear ground noise, your GND BAL setting could be a bit off, so perform the ground balancing procedure again. As you walk even a very short distance, ground conditions can change. The ground geology typically associated with gold will tend to change over very short distances.

The Fe_3O_4 bar graph indicates the amount of iron mineralization in the soil. In most gold fields, especially alluvial (placer) deposits, gold tends to be associated with iron minerals, especially magnetite *black sand*. If you know this to be the case in the area you're working, you can maximize your gold recovery by concentrating your effort on areas where the bar graph indicates higher amounts of iron mineralization.

Gold prospectors are mostly a friendly bunch, and willing to spend some time showing a beginner how to increase his odds of finding the yellow stuff. Many will invite you to search on their claims (if they have any) once they get to know you. In some gold areas, a lot of the terrain is under claim, so you need to learn how to recognize posted claims and stay off of them unless you have the claim owner's permission. Prospecting clubs such as the Gold Prospector Association of America (GPAA) often own claims which are open to its members and sponsor group outings to productive gold prospecting areas.

It's a thrilling experience to dig into the ground and pull out a precious piece of yellow metal that you are the first person on earth to see. If you love being outdoors, have patience, and can stay motivated by the prospect of finding that next nugget, then *beeping for gold* may be the hobby for you. While only a few get rich prospecting, if you are not among them, think of it as outdoor recreation where your finds defray the expense of having fun!

HOT ROCKS

A *hot rock* is a rock which causes the metal detector to sound off because the rock contains iron minerals. They come in two basic types.

Negative hot rocks (also called cold rocks) are usually magnetite or contain magnetite, and give a negative response because their ground balance value is a higher number than the soil they are found in. They tend to be dark in color, usually black, and usually heavy. In some cases they will have rust stains. They are usually attracted to a magnet, and for this reason gold prospectors always carry a magnet -- the ultimate ferrous/nonferrous discriminator. In All Metal Mode, negative hot rocks produce a *boing* sound rather than the *zip* sound of a metallic target; recognize the difference and you will learn to ignore them. As the searchcoil passes over a hot rock, this *boing* sound, or negative response, is quite distinctive. To hear this response, you must be properly Ground Balanced and in All Metal Mode with an audible threshold hum. First, as the center of the searchcoil passes over the negative hot rock, the detector will go quite; the threshold hum momentarily silences. Then, passing beyond the negative hot rock, you hear the *boing* sound. As you pass the searchcoil back and forth over a negative hot rock, it will be impossible to pinpoint and will seem as if it *moves around*.

Positive hot rocks are iron-bearing rocks which have been oxidized by natural weathering processes so that their GND BAL value is a number lower than the soil they are found in. They are often small, right on the surface, sound just like a gold nugget, and are common in many gold prospecting areas. They are usually, but not always, drawn to a magnet. They are most often reddish in color but are often black, brown, or yellow. On relic hunting sites, red clay bricks and rocks which have lined a fireplace or a campfire will often be *hot rocks*. The discriminator will usually eliminate them without difficulty if widely scattered, but if there is a large concentration of them, the discriminator may not quiet them all. In that case, you can revert to the rule of thumb -- "don't dig non-repeatable signals."

remember to always carry a magnet to help discriminate gold from hot rocks and iron.

- Gold will not be attracted to a magnet.
- Pieces of iron will always be attracted to a magnet.
- Negative hot rocks will almost always be attracted to a magnet.
- Positive hot rocks will usually be attracted to a magnet.

ELECTROMAGNETIC INTERFERENCE (EMI)

You are likely to encounter electromagnetic Interference (eMI) when using your Gold Bug® metal detector. It is important that you recognize eMI and take appropriate measures to deal with it. This will prevent you from giving up on a worthwhile search site, or from returning a properly functioning detector for repair.

Symptoms of Electromagnetic Interference (EMI)

eMI can cause a metal detector to *chatter* spontaneously, to lose sensitivity for no apparent reason, or to cause a periodic *wobbly* audio sound. What you hear will depend on what operating mode you are using, the detector's settings, and the source of the electrical interference. The most common manifestation is spontaneous chatter.

All metal detectors are susceptible to eMI, but they vary in what kinds of interference affect them. In a given environment some metal detectors may be affected by eMI whereas others may not.

Common sources of Electromagnetic Interference (EMI)

Common sources of eMI include: overhead electric power lines, underground power lines, other metal detectors, telephone lines carrying electronic data, computer systems, electric fences, old Cr T-based televisions, **cell phones**, CB and emergency communication radios, thunderstorms, fluorescent lights, metal vapor lamps, military aircraft with electronic warfare countermeasures turned on, electric motors, vLF military communications systems and automobile ignition systems. At home, in a store, or in an urban environment, there may be several different sources of interference present simultaneously.

All metal detectors generate a certain amount of internal electronic noise. The Gold Bug® is specifically designed to enable you to *work into the noise*. Experienced users, striving for maximum depth, often adjust the machine to search with a constant audible background sound, and then listen through that noise for the sound of real targets.

Stricter regulations in recent years have cut down on interference from electric light dimmers and auto ignition systems. However there has also been a proliferation of vLF-UHF wireless communication systems (cell phones, Bluetooth, wi-fi, etc.), which often affect metal detectors. Overall, the potential for electromagnetic Interference (eMI) is greater than it was just a few years ago.

Modern high-end metal detectors are a lot more sensitive than older units; this also increases your detector's vulnerability to eMI beyond what you may be accustomed to with an older detector. Metal detectors are by their nature designed to detect magnetic fields, and electric current always produces magnetic fields.

Coping with Electromagnetic Interference (EMI)

*The primary reason metal detectors provide a sensitivity (gain and/or threshold) control, is so that users can reduce sensitivity in order to eliminate response to electrical interference. Some users are reluctant to reduce sensitivity out of fear of losing depth. At reduced sensitivity settings, you may lose some depth, but at least you can still search. **The Gain and Threshold knobs control the sensitivity and are your first line of defense against EMI.** The Threshold control only applies to the All Metal Mode.*

ELECTRICAL INTERFERENCE (EMI)

eMI is usually easier to control in the All Metal Mode than in the Discrimination Mode.

On the Gold Bug®, setting the discrimination level between 60 and 70 will usually reduce interference. In the Discrimination Mode, the detector may chatter if the searchcoil is not in motion, but once you start sweeping it over the ground, the signal from the ground will usually suppress the eMI chatter, except for an occasional pop or click which will not sound like a real target.

If you are conducting an indoor demonstration, you may find that changing the orientation of the searchcoil will reduce the pickup of eMI.

If you carry a cell phone or other high-tech electronic equipment while metal detecting and you encounter eMI, try turning the device off and see if that solves the problem. Turn such devices completely off, not just into standby mode.

When working near overhead power lines, you may get the best results right under the power line and the worst results when standing at a 30° to 45° angle to the power line.

Many sources of eMI are intermittent. You may find that an area which is difficult to search at one time of day may be easier after 5 PM, or on weekends. Power lines are usually quietest late at night, and on weekend mornings.

Small searchcoils usually pick up less eMI than larger searchcoils. On a site with severe electrical interference, a small searchcoil is often a better choice than a large one.

Distinguishing Electromagnetic Interference (EMI) from other problems

eMI will often vary as you walk around from place to place, and it will also vary with changes in the orientation of the searchcoil. This is almost never the case if there is a functional problem with the metal detector itself.

The most common cause of a noisy metal detector, where the problem is not eMI, is a defective searchcoil. If striking the searchcoil with your hand causes the noise to start or stop, the problem could be a defective searchcoil. Also, a defective searchcoil often causes noise of a more intermittent nature than electrical interference.

The second most common cause is a loose searchcoil connector. The noise from a loose connector will usually be very erratic or intermittent in nature. Try unplugging the searchcoil and then reconnecting it to ensure the connector is firmly installed.

If you use a searchcoil cover, dirt or water can accumulate inside it, and movement of those materials can cause false signals while sweeping the searchcoil. Searchcoil covers must be periodically removed and cleaned.

SEARCH TECHNIQUES

Target Verification

After detecting a target, do the following:

1. Walk around the target in a circle.
2. While circling the target, continue sweeping the searchcoil across the target.
3. Sweep once every 30° or 40° of the circle.

If the tone does not change and the Target-ID value is consistent as you circle the target, you can be highly confident of the target's identification.

If the tone or Target-ID changes as you circle the target, you may have multiple targets or an irregularly shaped object.

If the tone completely disappears at different angles, the target may be trash or a low-value metal.

If you are new to the hobby, dig all targets. With practice in the field, you will soon be able to correlate audible and visual target feedback with certain types of metal objects.

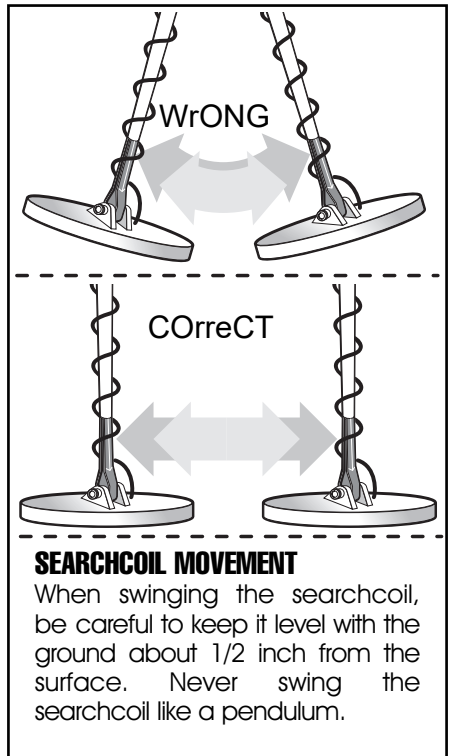

Pinpointing in Discrimination Mode:

1. Sweep over target in narrowing side-to-side pattern.
2. Take visual note of spot on ground where “beep” occurs.
3. Step 90° to the side of the target.
4. Sweep searchcoil over same area, at 90° to 1st sweep pattern.
5. This pinpoints the target location with an “X.”

TARGET PINPOINTING

After you have identified a target using Discrimination Mode, press-and-hold the PINPOINT button to identify the target's exact location. This technique can yield more information about the target's shape and size and also find its exact location to facilitate extraction.

Pinpoint as follows:

1. Position the searchcoil just barely off the ground, and to the side of the target.
2. Now move the searchcoil slowly across the target; you can locate it by the sound. The target is located directly under where the sound is loudest.

Narrow It Down:

1. To narrow the response further, position the center of the searchcoil near the center of the response pattern, but not directly over the center.
2. release the PINPOINT button.
3. Press-and-hold PINPOINT button again.
4. repeat this narrowing procedure to narrow the field of detection further.

Note: Depth indication is less accurate after narrowing.

SeArCHCOIL DrIFT

If you plan to use the PINPOINT Mode for continuous searching, realize that drift will occur over time, causing the detector to gain or lose sensitivity. Periodic retuning of the detector is required to minimize drift; release and press PINPOINT again to retune.

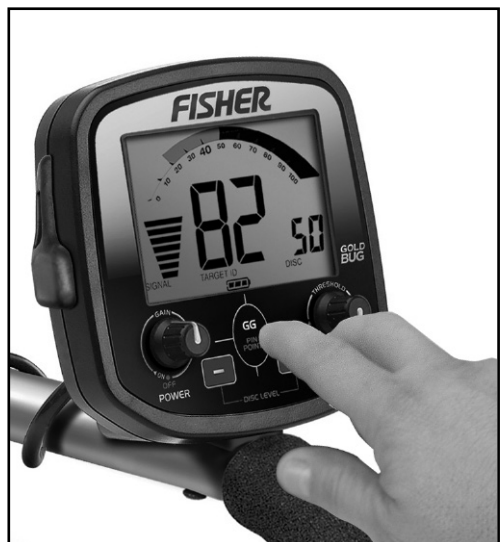

Relic-Hunting and Coin-Shooting with the Optional 11" DD Searchcoil

While the Gold Bug® is a high performance, specialized gold prospecting metal detector, it is also a good multi-purpose detector. With the purchase of an 11" DD searchcoil, you can bring more power to your coin-shooting and relic-hunting searches.

The standard 5" Gold Bug® searchcoil is engineered for precision and is best at finding the smallest gold nuggets that most other gold prospecting detectors would miss.

If you want a larger sweep area and deeper detection, the 11" DD should be considered.

Advantages of the 11" DD searchcoil are:

1. Deeper detection
2. Broader sweep (cover more area in less time)



DEVICE SPECIFICATIONS

Mechanical: S-rod with electronics housing on rod, 3-piece breakdown construction, nonmetallic telescoping lower rod, adjustable position arm rest

Weight: 2 lbs, 8 oz with battery installed

Standard searchcoil: 5 inch (12.7 cm) closed-frame round biaxial, waterproof

Batteries: Single 9 volt rectangular alkaline

Operating principle: vLF induction balance

Operating frequency: 19 kHz, crystal controlled

Reactive overload: 10,000 micro-cgs (with standard searchcoil)

Resistive overload: 1,200 micro-cgs (with standard searchcoil)

Ground balance range: From ferrite to salt water inclusive

Discrimination ground suppression: Combination of 2nd and 3rd order methods

Target-ID ground suppression: 3rd order

Battery life: 15+ hours on good quality alkaline

Operating temp range: 14 to 122 degrees F (-10 to +50 C)

Operating humidity range: 0 - 90% noncondensing

TREASURE HUNTER'S CODE OF ETHICS

- Always check Federal, State, County and local laws before searching.
- Respect private property and do not enter private property without the owner's permission.
- Take care to refill all holes and leave no damage.
- Remove and dispose of any and all trash and litter found.
- Appreciate and protect our inheritance of natural resources, wildlife and private property.
- Act as an ambassador for the hobby; use thoughtfulness, consideration and courtesy at all times.
- Never destroy historical or archaeological treasures.
- All treasure hunters may be judged by the example you set; always conduct yourself with courtesy and consideration of others.

ACCESSORIES

Fisher® Padded Carry Bag

Rugged double stitched construction. Includes handy exterior pocket for extra batteries or small accessories. – 103693000C

Fisher® Camo Backpack

Large camouflage and black with Fisher® logo. – FCBACKPACK

Fisher® Camo Pouch

Camo pouch with two inside pockets, belt included. – PCH-F

Fisher® Stereo Deluxe Headphones

Adjustable single-volume control, 1/4 jack™ jack, aluminum cones and coiled cord. 9720971000

Stereo Headphones

Use with Fisher® metal detectors. Lightweight and adjustable with true stereo sound, adjustable volume, 1/4 jack with 1/8 adaptor, 4' cable. – 9720950000

Metal Sand Scoop

Large galvanized metal scoop with filtering holes. Strong Rubberized grip. – SAND SCOOP

Gold Pick

Tempered steel head is 10" long, edge is 3-1/4" wide, overall length 19". Durable fiberglass handle, rubberized grip and super magnet attached to the head. – GOLDPICK

Lesche Knife

Made from high quality heat-treated tempered steel. The ultimate digging tool. Comes with a durable sheath. 12" in length with a 7" serrated blade. – LESCHE KNIFE

Fisher® Baseball Cap

One-size-fits-all. – FCAP

Fisher® Camo Baseball Cap

One-size-fits-all. Velcro closure, camouflage with Fisher® logo. – FCCAP

Fisher® Coffee Mug

16oz, stainless steel and plastic – FMUG

Fisher® T-Shirt

100% cotton with Fisher® Logo. Sizes: S, M, LG, XL & XXL – FTSHIRT

Replacement/Accessory Searchcoils

11" DD Elliptical, Open Accessory Coil – 11COIL-GB
 10" DD Elliptical, Closed Accessory Coil – 10COILDD-GB
 5" DD Round, Closed Replacement Coil – 5COIL-GBUG

Coil Covers*

Specially made to protect your coil from abrasion and damage.
 11" DD Coil Cover – COVER-11DD
 10" Biaxial Accessory Coil Cover – 202319000
 5" DD Coil Cover – 5COVER-BLK

Rain Cover

Specially designed to protect your detector from dirt and water – RAINCOV-GB

Gold Prospecting Kits

Items Included:

	Gold Kit PART NUMBER: GOLDKIT1	Deluxe Kit PART NUMBER: GOLDKIT2	Hardrock Kit PART NUMBER: GOLDKIT3
10 1/2" Gold Pan	x	x	x
14" Gold Pan	x	x	x
Classifier		x	x
2 – Shatterproof Vials	x	x	x
Snuffer Bottle	x	x	x
Black Sand Magnet		x	x
Treasure Scoop		x	x
Tweezers			x
Magnifier			x
Crevice Tool			x
Rock Pick			x
Instruction Booklet	x	x	x
Backpack		x	x

