

- 1** Identify all tent components (see list below).

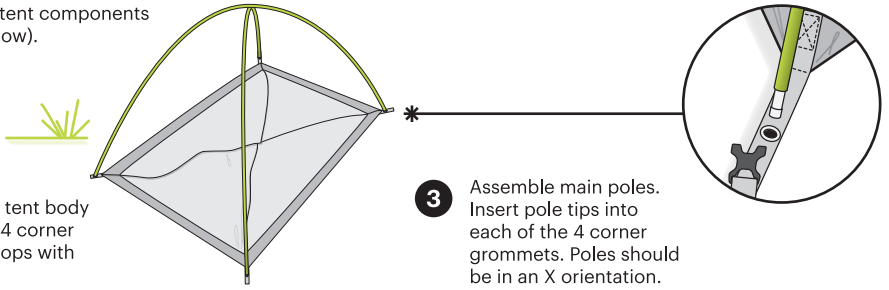

- 2** Spread out tent body and locate 4 corner webbing loops with grommets.

- 3** Assemble main poles. Insert pole tips into each of the 4 corner grommets. Poles should be in an X orientation.

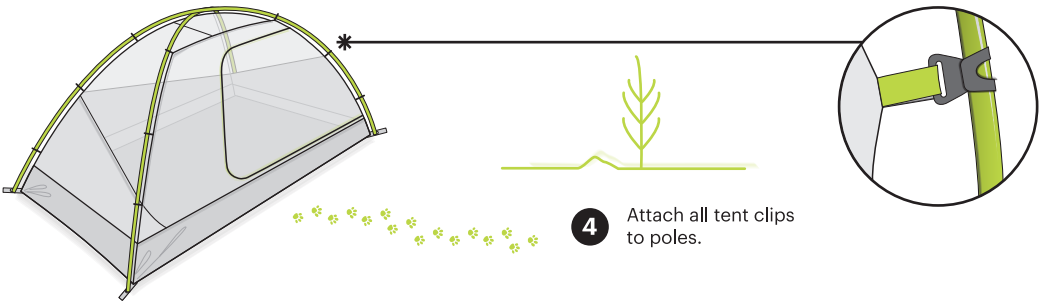

- 4** Attach all tent clips to poles.

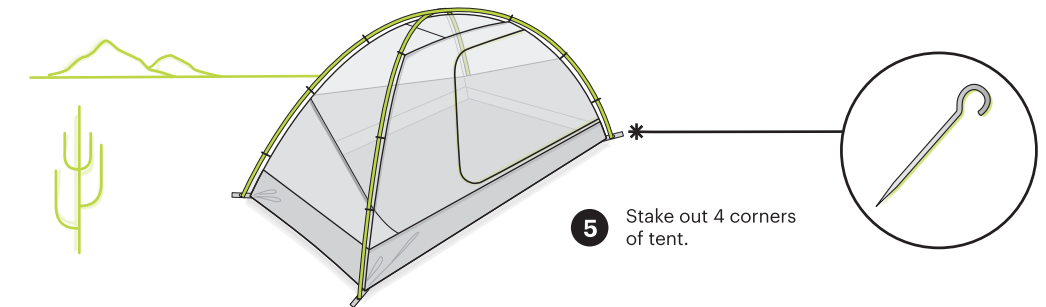

- 5** Stake out 4 corners of tent.

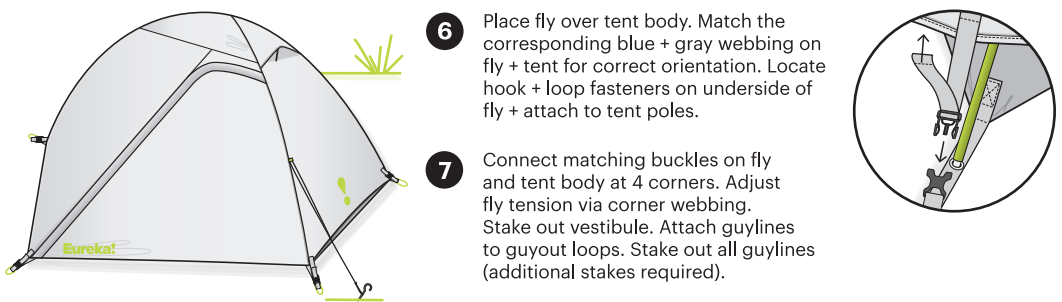

- 6** Place fly over tent body. Match the corresponding blue + gray webbing on fly + tent for correct orientation. Locate hook + loop fasteners on underside of fly + attach to tent poles.

- 7** Connect matching buckles on fly and tent body at 4 corners. Adjust fly tension via corner webbing. Stake out vestibule. Attach guylines to guyout loops. Stake out all guylines (additional stakes required).

TENT CONTENTS

Tent body
Tent fly
Poles (2)
Stakes (8)
Guylines (7)
Gear loft

TENT TIPS

- Always stake down tent, including all guyout points.
- Increase interior air flow by opening the fly vent.

TENT CARE

- Make sure the tent is completely dry, then store loosely rolled in a dry cool place.
- Clean your tent by setting it up and wiping it down with a mild soap and luke warm water. Never use laundry detergent, washing machines or dryers.

WARRANTY

- Your Eureka! tent is covered by a limited lifetime warranty.