

Eureka!

Gonzo Grill

Model: 2572190

Instructions for use

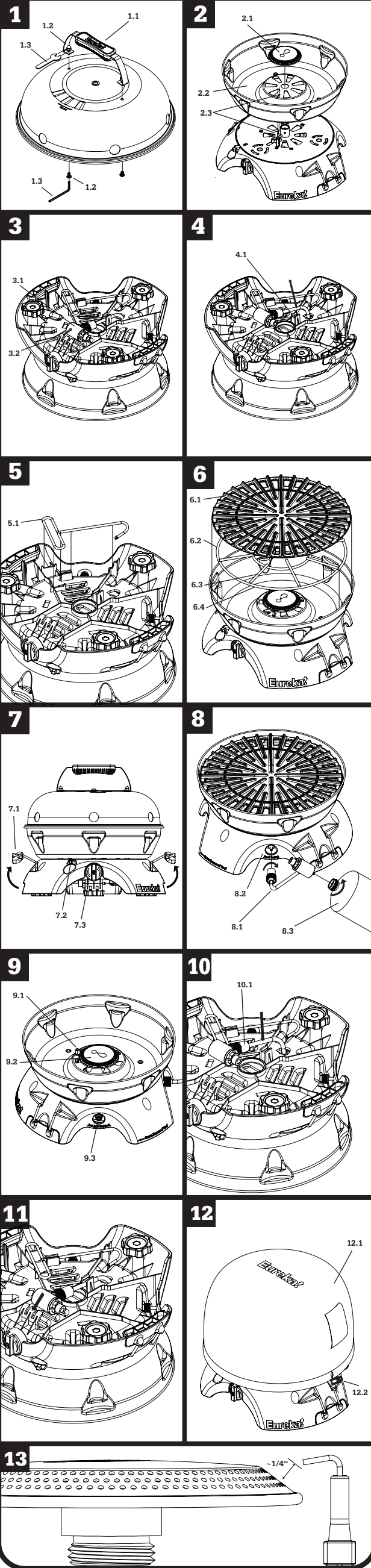

(EN) ENGLISH

Important: Read these warnings and instructions for use carefully to familiarize yourself with the appliance before connecting it to its gas container. Keep these instructions for future reference. **USE OUTDOORS ONLY**

FOR YOUR SAFETY

FOR YOUR SAFETY

If you smell gas:

1. Do not attempt to light appliance.
2. Extinguish any open flame.
3. Disconnect from fuel supply.

FOR YOUR SAFETY

Do not store or use gasoline or any other liquids with flammable vapors in the vicinity of this or any other appliance.

CARBON MONOXIDE HAZARD

⚠ DANGER



CARBON MONOXIDE HAZARD

This appliance can produce carbon monoxide, which has no odor. Using it in an enclosed space can kill you. Never use this appliance in an enclosed space such as a camper, tent, car, or home.

If there is a leak on your appliance (smell of gas), move it to a well-ventilated, flame-free location where the leak may be detected and stopped. Check for leaks on your appliance outside. Do not use a flame to detect leaks, use soapy water. **ONLY USE IN WELL VENTILATED AREA. Accessible parts may become very hot.** Keep young children away. Stove must be operated on a horizontal surface, at least 1m/3.3ft away from any combustible materials. Do not move, lift, or tilt stove with lit burner.

SPECIFICATIONS

Gas category: Propane under vapor pressure. This appliance should only be used with 16.4 oz disposable propane cylinders (sold separately). The LP-gas cylinder(s) used with this stove must be constructed and marked in accordance with the specifications for LP-gas cylinders of the U.S. Department of Transportation or Transport Canada, CAN/CSA B339. Refillable Bulk LP-Gas Tanks with a maximum capacity of 20 pounds may also be used with an optional bulk tank adapter hose (use Eureka! model 2572182 to connect to bulk tank). **Jet Size:** 0.28mm **Gas Consumption:** 6.2 MJ/hr (AU) || 120 g/hr (1.7 kW) (EU) || 6,000 BTU/hr (CA)

ASSEMBLY

Refer to the following diagrams shown on Page 1 when assembling and operating Gonzo Grill:

- | | |
|-----------------------------|----------------------------------|
| 1. Lid Handle Assembly | 8. Regulator/Fuel Assembly |
| 2. Drip Tray Assembly | 9. JetLink Output |
| 3. Regulator Removal | 10. Regulator Storage |
| 4. Regulator Removal cont'd | 11. Regulator Storage cont'd |
| 5. Grate Tool Removal | 12. Grill Cover |
| 6. Cooking Surfaces | 13. Proper Electrode Positioning |
| 7. Transport | |

Remove Packed Contents from Box. Attach Lid Handle (1.1) using provided hardware (1.2) and tools (1.3) as shown. Unthread Burner (2.1) from Grill Base to release Drip Tray (2.2) from its packed position. Flip Drip Tray upright as shown, and place on Grill Base ensuring that the Electrode (2.3) is aligned with the cut-out. Secure the Drip Tray by threading the Burner into the Burner Base. The Fuel Regulator (3.1) is stored under the Grill Base. To remove, first detach from the Large Regulator Clip (3.2), and then detach from the Small Regulator Clip (4.1). Similarly, the Grate Removal Tool (5.1) may be detached from the Grill Base by pulling free from its retaining clip. The Cast Iron Grilling Surface (6.1) and the Stove Grate (6.2) can be placed on the supports built into the Drip Tray. Optionally, the Cast Iron Grilling Surface can be flipped and used as a Griddle Surface as well. Ensure that the Stove Grate is installed such that the Radial Support Bars (6.3) are facing up and the Circular Rings (6.4) are facing down. To transport the assembled Grill, the Folding Handles (7.1) may be used. Securely screw Fuel Regulator (8.1) to the Fuel Input port (8.2) located on the back of the Left Stove. Securely screw Propane Cylinder (8.3) into Fuel Regulator, in the orientation shown in (8). *Never operate stove with Propane Cylinder in an inverted position.*

OPERATION WARNINGS

Do not leave grill/stove unattended while in use. Keep grill/stove area clear and free from combustible materials, gasoline, and other flammable vapors and liquids. Do not obstruct the flow of combustion and ventilation air to the stove. Check the seals before connecting a new gas container to the appliance. **The gas container/canister shall be changed in a well ventilated location, preferably outside, away from any sources of ignition, such as naked flames, pilots, electric fires, and away from other people.** If there is a leak on your appliance (smell of gas), take it outside immediately into a well ventilated, flame free location where the leak may be detected and stopped. If you wish to check for leaks on your appliance, do it outside. Do not try to detect leaks using a flame, use soapy water. Put some soapy water on the gas connection points between gas canister and the appliance, if bubbles are found, there is a gas leakage.

OPERATING INSTRUCTIONS

Ignite burner before placing cookware on Stove Grate and before placing Lid on Grill. Keep burner at arm's length, away from face, during ignition. Flame can erupt and flare during ignition. Never expose stove to flammable vapors or liquids while lighting the burner. **It can cause an explosion or fire.** The stove must not be exposed to flammable vapors or liquids during lighting.

Lighting the Burners: Test igniter (7.2) before opening valve. If a spark is not observed between Electrode (9.1) and Burner (9.2), refer to maintenance section. To light, open control valve (7.3) counterclockwise until fully opened and gas flow can be heard, then push igniter button (7.2) until flame is observed. Do not move, lift, or tilt burner while lit. Fuel can spray and cause flare-ups.

Cooking: Rotate control valve (7.3) clockwise to decrease flame setting. If using Cast Iron Cooksurface, use only low output settings to avoid overheating, as Cast Iron is an excellent retainer of heat.

Expanding your cooking system: This stove comes equipped with a Patent-Pending JetLink™ fuel output port (9.3), which provides regulated fuel to additional JetLink™-compatible stoves and accessories offered by Eureka! or Jetboil. The port is located on the side of the Right Stove. Refer to instructions accompanying JetLink™ accessories for their use. Do not attempt to use stoves or accessories that are not certified as JetLink™-compatible by Eureka! or Jetboil.

Cleaning: Allow grill/stove to cool before cleaning. Grate Removal Tool (5.1) may be used to remove Cooking Surfaces while hot and allow for quicker cooling. Un-thread Burner (9.2) by rotating counter-clockwise, taking caution not to bend the Electrode (9.1). Drip Tray (2.2) is now free to remove from the Grill base. The Drip Tray may be washed with soapy water or using a dishwasher. Do not use abrasive compounds to clean. See included Cast Iron Care manual for proper care & cleaning of the Cast Iron Cooking Surface.

STORAGE AFTER USE

Turn off control valve (7.3) (tighten clockwise) to extinguish flame to each burner. **EXPOSED METAL PARTS MAY BE HOT. ALWAYS CHECK THAT THE BURNER IS EXTINGUISHED BEFORE DISCONNECTING THE FUEL CYLINDER.** Disconnect Fuel Cylinder and Fuel Regulator. Fuel Regulator may be stored in the Grill Base by first snapping into Small Regulator Clip (10) and then the Large Regulator Clip (11). To ensure proper fit, the Regulator Collar (10.1) must be slid up the Regulator Line as shown. Allow grill/stove to cool, and place Transport Cover over the top (12.1), securing using attached Cordlock (12.2). **Always disconnect fuel cylinder from Regulator after use.** Fuel cylinders can explode. Store fuel cylinders outdoors in a dry, well-ventilated area, away from heat, and out of reach of children.

TROUBLESHOOTING AND MAINTENANCE

Do not modify this appliance. Modification of the product and/or using the product not in accordance with the instructions and recommended use may be hazardous and will void the warranty. This appliance must only be serviced by an authorized person. If an issue cannot be corrected using these instructions, see Limited Warranty below. Contact your local dealer, distributor, or Eureka! for parts and/or service. If stove is operating poorly, check mix tube to ensure that air holes are not blocked, and that the jet is not dirty or contaminated. Ensure that Fuel Input and JetLink™ Output ports are kept clean and debris-free at all times. If the stove flashes back to the burner tube or lifts, turn off stove, call supplier. **Flame does not extinguish:** Valve is damaged. Tighten valve as much as possible, blow out flame, and immediately detach fuel cartridge. Return to dealer.

Igniter fails to spark. If igniter will not spark, check positioning of electrode in relation to burner (13). If not positioned as shown in instructions, re-position the electrode accordingly. If igniter still fails to spark, use matches or a lighter. See your dealer or contact Eureka! for service. If stove is wet, igniter may fail to spark.

WARRANTY INFORMATION

USA: Eureka! Gonzo Grill has a 1-year limited warranty. Should this product not function properly under normal use within 1 year of purchase, contact the dealer or Eureka! for return process information. Eureka! alone will determine if the problem is covered by this warranty. If so, Eureka! will repair or replace the unit at its discretion and return it to you free of charge. This warranty does not cover any damage or malfunction arising from misuse, modification, improper maintenance, negligence, normal wear and tear, accident, or use other than as described in these instructions. This warranty applies only to the original purchaser. Proof of purchase is required. Except as provided herein, there are no other warranties, express or implied, including but not limited to the implied warranties of merchantability and fitness for a particular purpose. Eureka! shall not be liable for any consequential or incidental damages whatsoever. This warranty gives you specific legal rights. You may also have other rights that vary from state to state. Some states do not allow the exclusion or limitation of incidental or consequential damages, or limitation or exclusion of implied warranties, so the above exclusions or limitations may not apply to you.

JOHNSON
OUTDOORS
THE SEAL OF AUTHORITY