

Astro Pneumatic Tool Company

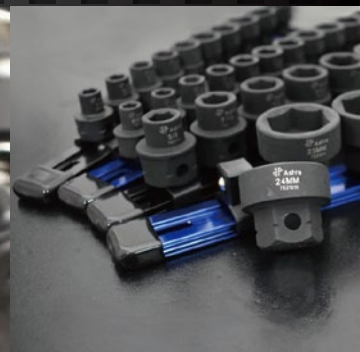

GRINDERS & DIE GRINDERS



MODEL NO. **218** **1/8" PENCIL TYPE DIE GRINDER - 56,000RPM**

- Designed for high speed porting and finishing of small parts
- Precision balance and remote exhaust



MODEL NO. **T20AH**
1/4" 90° ANGLE DIE GRINDER W/ SAFETY LEVER - FRONT EXHAUST - 20,000RPM

- Unmatched lifespan for high production settings
- Compact and lightweight



MODEL NO. **T210**
1/4" MEDIUM DIE GRINDER W/ SAFETY LEVER - REAR EXHAUST - JAPAN BEARINGS - 22,000RPM

- Lever throttle for feathering control
- Maximum durability 1/2HP motor

MODEL NO. **3006** **4" AIR ANGLE GRINDER WITH LEVER THROTTLE**

- Handles a variety of body shop work, auto and truck repair
- Widely applied for weld preparation, deburring, blending and smoothing applications





MODEL NO.

202

COMPOSITE BODY 1/4" MEDIUM DIE GRINDER - 22,000RPM - REAR EXHAUST

- Rear exhaust air flow system directs air away from work surface
- Compact and lightweight



MODEL NO.

204

COMPOSITE BODY 1/4" 90° ANGLE DIE GRINDER - 20,000RPM - REAR EXHAUST

- Rib textured handle provides a firm grip
- Throttle lever for feathering control

MODEL NO.

219

3PC. DIE GRINDER KIT W/ 1/4" 90° ANGLE AND STRAIGHT DIE GRINDER W/ 8PC. DOUBLE CUT CARBIDE ROTARY BURR SET

- Comfortable and durable die grinders
- Over-molded grip for comfort and insulation



MODEL NO.

2181B

2PC. DIE GRINDER KIT W/ 1/4" MEDIUM DIE GRINDER AND 8PCS. DOUBLE CUT CARBIDE ROTARY BURR SET

- Lever throttle for feathering control
- Positive grip - 1/4" capacity collet chuck



BURR KITS & AIR HAMMERS



MODEL NO.

2181

8PC. DOUBLE CUT CARBIDE ROTARY BURR SET 1/4" SHANK

- Solid Tungsten Carbide burrs for rapidly removing all ferrous materials including steel, stainless and cast iron



MODEL NO.

2185

5PC. LONG DOUBLE CUT CARBIDE BURR SET 4.5"

- Extra-long 4.5" double cut for hard to reach areas

MODEL NO.

4980

0.498" SHANK SUPER DUTY AIR HAMMER / RIVETER

- Maximum power air hammer for heavy duty, off-road, industrial and automotive applications
- Remove or install rivets in I-beam suspension and work site equipment, heavy duty servicing of truck bushings, springs, king pins and more



MODEL NO.

49801

QUICK CHANGE RETAINER CHUCK .498 SHANK

- For model 4980 and most .498 shank air hammers and bits



MODEL NO.

49803

3PC. CHISEL & HAMMER BIT SET .498 SHANK

- Includes heavy duty anti-turn chisel bit, 1.0" shouldered anvil and 1.25" rounded anvil bits



IMPACT WRENCHES

MODEL NO.

1832

1/2" NANO ANGLE IMPACT WRENCH - 415FT/LB

- Nearly the length of a credit card at 3.46" long
- Access confined bolts remotely with extended right angle design

MODEL NO.

1838

3/8" NANO ANGLE IMPACT WRENCH - 415FT/LB

- Industry leading 415 ft/lbs. of MAX torque

MODEL NO.

1822

1/2" NANO IMPACT WRENCH - 450FT/LB

- Extremely short profile, full length of less than 3 7/8"
- Incredibly light weight at 3.0lbs

MODEL NO.

1828

3/8" NANO IMPACT WRENCH - 450FT/LB

- Ideal for use in restricted spaces such as engine, transmission, and suspension work
- 3/8" model allows for the shortest profile possible when paired with 3/8" impact sockets

MODEL NO.

1812

1/2" SUPER DUTY IMPACT WRENCH - TWIN HAMMER

- Ideal for general automotive work, light truck, farm, body shop, tire shop and front-end work
- Two piece construction for easy maintenance



RATCHETS & DRILLS



MODEL NO.

1111A 1/4" PALM RATCHET WRENCH

- Compact design is ideal for confined work spaces like under dashboard work
- Needle Bearing Construction for smooth prolonged life



MODEL NO.

1119A 3/8" DRIVE MINI WOBBLE AIR RATCHET

- Wobble anvil design for increased angle access with sockets
- Compact design is ideal for confined work spaces like under dashboard work



MODEL NO.

1128 3/8" MINI IMPACT RATCHET WRENCH

- Sealed head design for increased tool life
- 50ft/lbs of working torque, 6.45" long



MODEL NO.

9012 1/8" STUBBY DOUBLE ENDED DRILL BITS - 12 PACK



MODEL NO.

525C 3/8" REVERSIBLE AIR DRILL - 1,800RPM

- Equipped with a built-in muffler for noise reduction
- Provides full power in forward and reverse



MODEL NO.

527C 1/2" EXTRA HEAVY DUTY REVERSIBLE AIR DRILL - 500RPM

- Side handle for greater operator control
- One hand reverse lever for reversible action

BELT SANDERS

MODEL NO. **3035 AIR BELT SANDER 3/4" X 20.5" W/ 2PC. BELTS (#80 & #100)**

Additional Belts Sold Separately (QTY10)

- **303540Z** - 40 Grit - 13/16" x 20.5"
- **303560Z** - 60 Grit - 13/16" x 20.5"
- **303580Z** - 80 Grit - 13/16" x 20.5"
- **3035100Z** - 100 Grit - 13/16" x 20.5"



MODEL NO. **3036 AIR BELT SANDER 3/8" X 13" W/ 3PC. BELTS (#40, #60 & #80)**

Additional Belts Sold Separately (QTY10)

- **303640Z** - 40 Grit - 3/8" x 13"
- **303660Z** - 60 Grit - 3/8" x 13"
- **303680Z** - 80 Grit - 3/8" x 13"
- **3036100Z** - 100 Grit - 3/8" x 13"

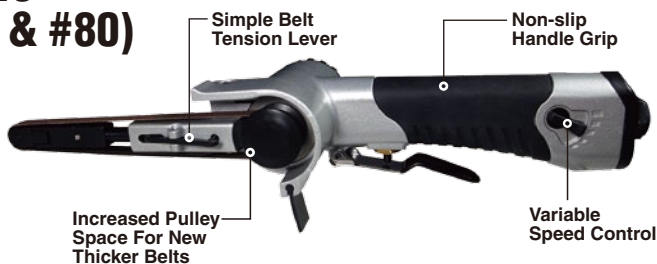

MODEL NO. **3037 AIR BELT SANDER 1/2" X 18" W/ 3PC. BELTS (#36, #40 & #60)**

- Great for Spot Weld Removal

Additional Belts Sold Separately (QTY10)

- **303736Z** - 36 Grit - 1/2" x 18"
- **303740Z** - 40 Grit - 1/2" x 18"
- **303760Z** - 60 Grit - 1/2" x 18"
- **303780Z** - 80 Grit - 1/2" x 18"
- **3037100Z** - 100 Grit - 1/2" x 18"
- **3037PAR** - Rubber Pulley Assembly
- **3037PAS** - Steel Pulley Assembly



**WORKS WITH
3M™ & NORTON
BELTS**



MICRO SANDERS

MODEL NO. **320 ONYX MICRO SANDER - 0.4HP**



MODEL NO. **321 ONYX MICRO RANDOM ORBIT SANDER**



- Ideal for spot sanding focused areas
- Includes 2" & 3" PU Hook & Loop backing pads

HOOK & LOOP SANDING DISCS



25 PER PACK

2" Sanding Discs	Model No.	2060P	2080P	2100P	2120P	2180P
		60 Grit	80 Grit	100 Grit	120 Grit	180 Grit
	Model No.	2220P	2320P	2400P	2600P	2800P
		220 Grit	320 Grit	400 Grit	600 Grit	800 Grit
3" Sanding Discs	Model No.	3320P	3400P	3600P	31000P	
		320 Grit	400 Grit	600 Grit	1000 Grit	

MODEL NO. **4606 6" PU HOOK & LOOP BACKING PAD**

- 5/16 inch-24 UNF thread
- Max. RPM: 10,000



WORKS WITH POPULAR BRAND SANDERS AND POLISHERS

MODEL NO. **4607 5" PU HOOK & LOOP BACKING PAD**

- 5/16 inch-24 UNF thread
- Max. RPM: 12,001

SMALLEST & MOST POWERFUL SANDERS IN THEIR CLASS

POLISHER & SANDER KITS

MODEL NO.

322P

6" FINISHING PALM SANDER W/ 6" PU PSA BACKING PAD - 3/16" STROKE

- Comes with Astro #4608 - 6" PSA Backing Pad
- High powered
- Sealed bearings for extended life



**ALSO AVAILABLE WITH
HOOK & LOOP**

MODEL NO.

322



MODEL NO.

330

3" FINISHING PALM SANDER W/ HOOK & LOOP BACKING PAD - 3/32" STROKE

- Composite lever, housing, and rotor for comfortable ease of operation
- 3/32" stroke that is optimal for fine finishing
- New muffler system reduces sound levels



MODEL NO.

888S SHORT STRAIGHT LINE SANDER

- Used on plastic fillers at any stage of hardening
- Feathers with ease and smoothness



MODEL NO.

3050 COMPLETE DUAL ACTION SANDING & POLISHING KIT



MODEL NO.

3055 3" MINI AIR POLISHING KIT

- Ideal for buffing small confined areas where larger tools cannot do the job



PINSTRIPE & DECAL REMOVERS

400E SMART ERASER® PAD ITEMS

MODEL NO.
400E
SMART ERASER® PAD
FOR PINSTRIPE REMOVAL TOOL



MADE IN THE USA

MODEL NO.
400E6
6 PACK - SMART ERASER® PAD



6 PACK

MODEL NO.
32
PINSTRIPE REMOVAL KIT
& 12 SMART ERASER® PADS



MODEL NO.
232
ONYX PINSTRIPE REMOVAL KIT W/
ONYX PINSTRIPE REMOVAL TOOL
& 12 SMART ERASER® PADS



CUTOFF & PUNCH & FLANGE TOOLS



MODEL NO.

209

IN-LINE 3" CUT-OFF TOOL

- Unique In-Line design provides greater control



MODEL NO.

409

QUICK CHANGE IN-LINE 4" CUT-OFF TOOL

- Large 3/4HP motor and quick change cutting wheel design
- Works with 3" or 4", 3/8" and 5/8" hole cut-off wheels

MODEL NO.

727

HEAVY DUTY AIR NIBBLER

- For professional grade applications
- Works on up to 17-gauge cold rolled steel



MODEL NO.

605PT

PISTOL GRIP PUNCH/ FLANGE TOOL W/ 5.5MM PUNCH

MODEL NO.

608PT

PISTOL GRIP PUNCH/ FLANGE TOOL W/ 8MM PUNCH

- Features a rotating head for convenient use



MODEL NO.

605ST

STRAIGHT TYPE PUNCH/ FLANGE TOOL W/ 5.5MM PUNCH

MODEL NO.

608ST

STRAIGHT TYPE PUNCH/ FLANGE TOOL W/ 8MM PUNCH

- Every pull of the lever delivers a single punch or a single flange crimp with precision control
- Forms an offset crimped edge on sheet metals for no-bump lap welds

MODEL NO.

WINDKO

ONYX AIR WINDSHIELD REMOVER W/ 3PC. BLADE SET - REAR EXHAUST (ASSORTED BLADES AVAILABLE SEPARATELY)

- Efficiently cleans & smoothes moldings after glass removal
- Sealant cutter that cuts around bonded and encapsulated glass



MODEL NO.

1770

DELUXE AIR WINDSHIELD REMOVER

- Heavier and thicker blades last much longer
- Tool is counter balanced for smooth operation which results in less fatigue

Replacement blades available :

- 17704 - 4" Serrated Blade
- 17705 - 6" Serrated Blade
- 17706 - 8" Serrated Blade

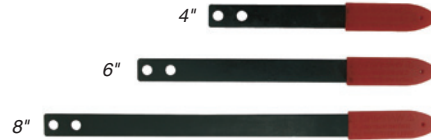

MODEL NO.

DS1000

PNEUMATIC DOOR SKINNING TOOL

- Save significant time and cost in skinning doors
- Faster than any other method
- Patent #6578404



MODEL NO.

DS2000

PNEUMATIC DOOR SKIN REMOVAL TOOL

- Design allows tool to maneuver around inner and outer curves as well as most body design features
- Patent #7661287



AIR BLOW GUNS

MODEL NO.

1715

DELUXE AIR BLOW GUN W/ 13" LONG ANGLED NOZZLE



MODEL NO.

1716

DELUXE AIR BLOW GUN W/ 20" LONG ANGLED NOZZLE



MODEL NO.

1717

DELUXE 4" AIR BLOW GUN - GREEN



MODEL NO.

1718

DELUXE 4" AIR BLOW GUN - ORANGE



New, improved design maximizes lifetime expectancy

MODEL NO.

1746

HIGH FLOW BLOW GUN W/ 5PC. QUICK DISCONNECT ATTACHMENTS

- Quick release knob unlocks to remove or install attachments in 6 different rotating positions allowing for 6 separate angles
- Full range trigger control, easily feather from 1-100%



SPRAY GUNS

AIR TOOLS



MODEL NO.

4008 SPRAY GUN W/ CUP - RED HANDLE

- 1.8 mm Nozzle

- All-purpose easy-to-clean paint spray gun
- Two-piece construction with gun featuring exclusive air valve design



MODEL NO.

PT2-4GH 2-1/4 GALLON PRESSURE TANK W/ SPRAY GUN & 12' HOSE - BLACK GUN

- 1.0 mm Nozzle

- Pressure spray gun equipped with pressure gauge and fluid pressure regulator for accurate settings
- 12 ft. twin set of hose permits easy movement and operation of spray gun



MODEL NO.

2PG7S 2 QUART PRESSURE POT W/ SPRAY GUN & HOSE

- 1.2 mm Nozzle

- Pressure spray gun with 2 quart (1893cc) pressure pot
- Equipped with pressure gauge and fluid pressure regulator for accurate settings

MODEL NO.

EUROHE103 / EUROHE105

1.3 mm Nozzle

1.5 mm Nozzle

EUROHE107 / EUROHE109

1.7 mm Nozzle

1.9 mm Nozzle

EUROPRO HIGH EFFICIENCY / HIGH TRANSFER SPRAY GUN

- HE technology for a wider pattern that layers paint thicker
- Less overlap on passes required

MODEL NO.

EUROHV103 / EUROHV105

1.3 mm Nozzle

1.5 mm Nozzle

EUROHV107 / EUROHV109

1.7 mm Nozzle

1.9 mm Nozzle

EUROPRO FORGED HVLP SPRAY GUN

- Industry leading transfer efficiency, spend less on paint
- Maximum atomization
- Minimal CFM requirement



AIR REGULATORS & FILTERS

MODEL NO.

AS7SP

SPRAY GUN W/ CUP - BLACK HANDLE - 1.8MM NOZZLE

- Designed for superior atomization and coverage compared to other all-purpose spray guns
- Two-piece construction with gun featuring exclusive air valve design



MODEL NO.

WS11

AIR REGULATOR W/ GAUGE

- Provides fine air control for spray guns and air tools
- Swivel top allows for easy installation
- Fits any spray gun or air tool



MODEL NO.

2618

AIR CONTROL UNIT - 120CFM CAPACITY

- Filter and regulator in one
- Easy to install for light to medium industrial and automotive applications



MODEL NO.

5706

BRASS AIR REGULATOR

- Increases or decreases air pressure as desired
- 1/4" NPT



MASKING



MODEL NO.

ASMS2 MASKING STATION - TREE TYPE

- Mobile yet stable
- Up to 18" paper rolls



MODEL NO.

MM18 18" MASKING MACHINE

- Allows for custom alignment of paper rolls and tape position



MODEL NO.

4577 MOBILE STEP MASKING MACHINE

- Unit can be used as a step stool
- Lightweight, easy to use and portable



MODEL NO.

4550A AIR OPERATED PAINT SHAKER

- New larger adjustable rubber clamps accommodate pints, quarts, gallons and large European cans



MODEL NO.

7300 SUPER STAND - UNIVERSAL ROTATING PARTS WORK STAND

- Handle any panel, fender, door, hood, or bumper to make repairs and refinishing easy
- Comes with 8 adjustable bars to fit almost any panel securely

MODEL NO.
557003
**500 LB. CAPACITY
PORTABLE WORK STAND**

- Great for working on doors, fenders, hoods and bumpers
- Adjustable height of 33" to 40" tall

**ALSO AVAILABLE IN
HEAVY-DUTY** MODEL NO.
557010



MODEL NO.
557100
**THE FENDER EXTENDER - 80" ADJUSTABLE
EXTENSION FOR PORTABLE WORK STAND**



- Extension designed for long/wide bumpers, hoods, and fenders that would normally be difficult to balance on a work stand
- 3 way adjustable from 77.5" to 80" in length, works on any tube design work stand

MODEL NO.
7306
**ADJUSTABLE 7 FOOT
PAINT HANGER**

- Adjustable frame that extends from 5ft to 8ft tall
- Six Hooks to hold parts for painting/drying

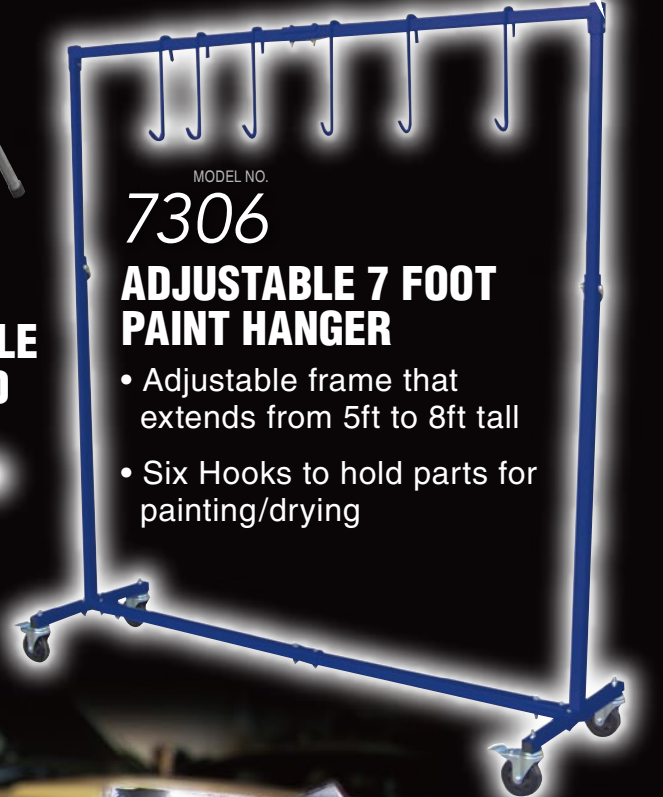

SPECIALTY



MODEL NO.
9004
**CANVAS WHEEL
COVERS
(WHEEL MASKERS)
4PC./SET**



MODEL NO.
101
MINI GREASE GUN
• Heavy duty, lightweight
and easy to handle



MODEL NO.
4526 - 4"
4528 - 6"
**YELLOW PLASTIC
SPREADERS -
100PC./BOX**



MODEL NO.
9448
100PC. SECURITY BIT SET
• Essential for car, machine tool,
household appliance and
electronics repairs, etc.



MODEL NO.
9020
20PC. WIRE BRUSH SET
• Set includes 1 piece brush each in
stainless steel, brass and nylon in the
following sizes: 1/4", 3/8", 1/2", 5/8",
3/4" and 1"



MODEL NO.
9425
**DUAL TEMPERATURE
HEAT GUN KIT**

- Unit has a switch which allows for two different heat settings
- Double insulation for extra safety



MODEL NO.
9426
**INDUSTRIAL
HEAVY-DUTY HEAT GUN**

- Variable temperature adjustment provides a maximum temperature of 1000-1100 Degrees F
- Powerful blower provides a high volume of air needed for industrial applications

MODEL NO.
4524
**11PC. AUTO FASTENER & MOLDING
REMOVAL TOOL SET**

- For use on internal and external vehicle molding and trim fasteners
- Nylon construction of tools prevents scratching and damage to vehicle paint, leather, chrome, etc



MODEL NO.
7600
**HOT STAPLE GUN KIT FOR
PLASTIC REPAIR**

- Designed for quick repair and reinforcing broken/ripped/damaged/ split plastic on autos, motorcycles, ATVs, boats, etc
- Unique Staple Gun heats special designed staples and sets staples into plastic



LIGHTING

SHOP EQUIPMENT

MODEL NO.
50SL SUNLIGHT

400 LUMEN RECHARGEABLE HANDHELD COLOR MATCH LIGHT - CRI 97



MODEL NO.
50SLMAX SUNLIGHT

**500 LUMEN RECHARGEABLE HANDHELD
DUAL TEMPERATURE COLOR MATCH LIGHT**



MODEL NO.
200SL SUNLIGHT

**200SLMAX
LIGHT W/
ROLL STAND**



MODEL NO.
200SLMAX SUNLIGHT

**2000 LUMEN
RECHARGEABLE
CORDLESS PROFESSIONAL
COLOR MATCH
FLOOD LIGHT - 96 CRI**



MODEL NO. **150SL** **1540 LUMEN LED RECHARGEABLE UNDERHOOD LIGHT W/ DETACHABLE HANDHELD LIGHT**

- Impact resistant design features an aluminum body with high impact plastic covers and lens
- Handheld light charges itself when clipped into underhood light

NO DOWN TIME

Can be used with 16.5ft cord or up to 6 ½ hours of battery powered run time

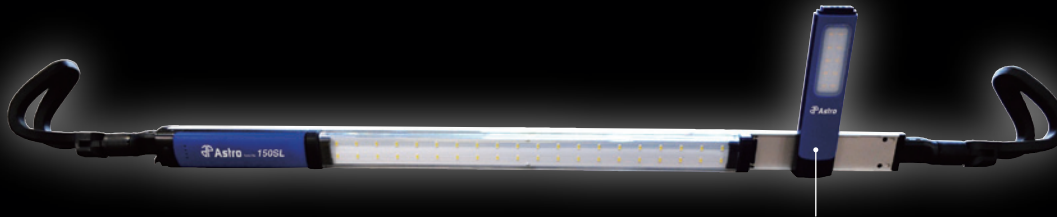

The Sidekick
250 lumen handheld light that unclips with the press of a button

MODEL NO. **65SL** **650 LUMEN RECHARGEABLE LED SLIM LIGHT W/ TOP FLASHLIGHT**



- 650 lumen COB LED light with independent 120 lumen top LED flashlight
- Lasts 2.5hrs on high, 7hrs at 50% with five green LEDs on side of light body indicating current charge level while light is in use

MODEL NO. **40SLMAX** **450 LUMEN RECHARGEABLE LED SLIM LIGHT W/ XL BATTERY**



- Features massive 3,350mAh lithium battery
- 13 hours work time at 50% power, or 3.5 hours at full power



MODEL NO.
70SL
700LM MICRO FLOOD LIGHT

- 700 lumen max output with rear charge level indicator
- Rotatable 20lb base magnet
- 2,600mAh battery, 2.5-10hrs of use

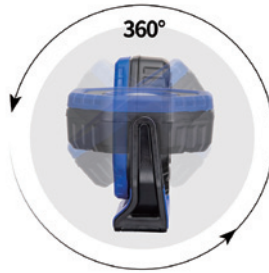

MODEL NO.
40HL
TOP FLASHLIGHT ○

400 LUMEN RECHARGEABLE HANDHELD LIGHT

- Unique new double COB LED array allows for 2X the light output and battery life in 1/2 the size compared to normal COB lights, for a smaller full power inspection light



MODEL NO.
40HUVL
UV FLASHLIGHT ●

MODEL NO.
12SL
ULTRA SLIM RECHARGEABLE LED INSPECTION LIGHT

- Improved model with **400 LUMEN** 400 lumens of output
- Includes new strong 20lb neodymium magnet and magnet bracket





***INDUSTRY LEADING
RIVETERS AND RIVET NUT TOOLS***

HAND RIVETERS



MODEL NO.
1422
PROFESSIONAL MICRO HAND RIVETER
3/16" CAPACITY

- At 8.5" long, is 20% shorter than standard 3/16" hand riveters
- Includes 3/32", 1/8", 5/32" and 3/16"



MODEL NO.
1423
1/4" HEAVY DUTY 13" HAND RIVETER

- Shorter profile yet requires less effort due to hinged torque multiplier design
- No need to adjust the tool when changing rivet diameters



MODEL NO.
1426
1/4" HEAVY DUTY HAND RIVETER

- Extra long handles provide excellent leverage
- Spent mandrels are collected in the plastic container for safety and easy disposal

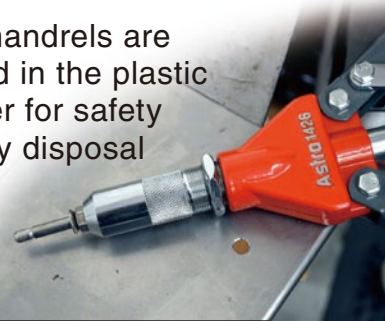

MODEL NO.
9456 RIVET NUT HOG - STEPPED INSTALLATION & REMOVAL BIT

- Designed to drill holes for and remove up to 30 different rivet nuts sizes and brands
- CNC machined M2 High Speed steel bit features chamfered steps designed to shave down set rivet nuts

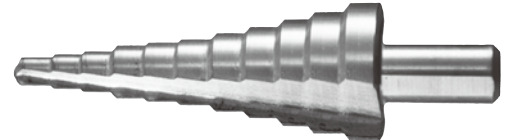

ACCESSORIES

LONG MANDREL



MODEL NO.	Size	MODEL NO.	Size
LM10-24	10-24	LM5M	M5
LM1/4-20	1/4-20	LM6M	M6
LM5/16-18	5/16-18	LM8M	M8
LM3/8-16	3/8-16	LM10M	M10
LM1/2-13	1/2-13	LM12M	M12

STANDARD MANDREL



MODEL NO.	Size	MODEL NO.	Size
1442-8/32	8/32	1442-10/32	10/32

100PCS RIVET NUTS

MODEL NO.	Size	MODEL NO.	Size
RN4M	M4	RN832	8-32
RN5M	M5	RN1024	10-24
RN6M	M6	RN14	1/4-20
RN8M	M8	RN516	5/16-18
		RN38	3/8-16
		RN120	40pcs 8-32
			40pcs 10-24
			20pcs 1/4-20
			10pcs 3/8-16
			10pcs 5/16-18





MODEL NO.

1451

10" MICRO HAND RIVET NUT SETTER KIT

- Compact 10" rivet nut setter with Toolless Quick-Change mandrel design
- Includes 10-24, 1/4-20, 5/16-18, M5, M6 and M8



MODEL NO.

1450

13" PLUSNUT & EXTRA-LONG RIVET NUT SETTER KIT - METRIC & SAE

- For setting bulbed PlusNut's, longer than standard rivet nuts and even standard rivet nuts
- Includes 10-32, 10-24, 1/4-20, 5/16-18, 3/8-16, M5, M6, M8 & M10



MODEL NO.

1442

13" HAND RIVET NUT SETTING KIT

- Tool-less Quick-Change Head design allows for easy changing of mandrels and nose pieces by hand
- Disassembly of tool never required, unique spring loaded inner hex



MODEL NO.

1452

XL NUT/THREAD SETTING HAND RIVETER KIT - 1/2" CAPACITY

- This XL models makes setting extra large rivet nuts like 1/2" and M12 a breeze

HAND RIVETERS

FASTENING

MODEL NO.

PR14

AIR RIVETER - 3/32", 1/8", 5/32", 3/16" AND 1/4" CAPACITY

- Provides quick, quiet and comfortable operation in high use settings

ALSO AVAILABLE WITH UP TO 3/16" CAPACITY

MODEL NO. PR36



MODEL NO.

PRN1

3/8" CAPACITY PNEUMATIC RIVET NUT SETTING KIT

- Instantly set rivet nuts with the pull of the trigger. Up to 3/8"(M10) in aluminum & steel
- Quickly un-thread set rivet nuts by operating free spinning rear wheel
- 2680lbs of instant air-hydraulic pulling force



MODEL NO.

PRN12

3/8" & 1/2" MANDRELS

PNEUMATIC RIVET NUT SETTING GUN

- Dial in regulator settings for specific rivet nut sizes and compositions

ALSO AVAILABLE WITH Metric

MODEL NO. PRN12M



MODEL NO.

PRN516

1/4" & 5/16" MANDRELS

PNEUMATIC RIVET NUT SETTING GUN W/ QUICK-CHANGE

- Quick-change mandrel system
- Adjustable power, dial in regulator setting for specific rivet nut sizes and compositions

ALSO AVAILABLE WITH Metric

MODEL NO. PRN8M

TIME TO ADAPT

MODEL NO.

ADR36

BLIND RIVET DRILL ADAPTER KIT

- ✓ CNC machined from solid billet aluminum and features Japanese bearings
- ✓ Includes nosepieces for 3/32", 1/8", 5/32" and 3/16" and works on stainless, steel, aluminum and copper rivets



MODEL NO.

ADR14

XL BLIND RIVET ADAPTER KIT - 1/4" CAPACITY

- ✓ Includes 6 nosepieces in SAE: 3/32", 1/8", 5/32", 3/16", 7/32", 1/4"



MODEL NO.

ADN14

RIVET NUT DRILL ADAPTER KIT

- ✓ Astro's EXCLUSIVE design withstands 4X the pulling force of other adapters, and features a CNC machined billet aluminum body and CR-MO mandrels
- ✓ Includes 8 mandrels and nosepieces in Metric: M3, M4, M5, M6 and in SAE: 8-32, 10-32, 10-24 and 1/4-20



MODEL NO.

ADN38

XL RIVET NUT DRILL ADAPTER KIT - 3/8" CAPACITY



- ✓ Includes 8 mandrels and 8 nosepieces in Metric: M5, M6, M8, M10 in SAE: 10-24, 1/4", 5/16", 3/8"



**EASILY CONVERT
CORDED & CORDLESS DRILLS
INTO POWER RIVET NUT
SETTERS & BLIND RIVETERS**

MODEL NO.

7897

BALL JOINT SERVICE TOOL AND MASTER ADAPTER SET

- C-frame press alone can be used to remove and replace universal joints
- Set includes all the receiver tubes and removing/installing adapters needed to work on press-fit upper and lower ball joints on most domestic and many 4WD and 2WD vehicles



MODEL NO.

7865

BALL JOINT SERVICE TOOL W/ 4-WHEEL DRIVE ADAPTERS

- Set contains C-frame press, 3 receiver tubes sizes: 2-3/4"x3", 2-1/4"x2-1/2" & 1-3/4"x2", installation and removing adapters
- This heavy duty tool set is excellent for removal and installation of press-fit parts such as ball joints, universal joints and truck brake anchor pins



MODEL NO.

7868

MASTER BALL JOINT ADAPTER SET

- Includes all the receiving tubes and removing/installing adapters needed to work on most GM, Ford and Dodge 2-wheel and 4-wheel drive pick-ups, vans and sport utility vehicles through 1997
- Work on press-fit upper and lower ball joints



MODEL NO.

78911

UNIVERSAL BALL JOINT SEPARATOR



MODEL NO.

78100

GOLIATH BALL JOINT XL C-FRAME PRESS



- Large ball joint press for max clearance and easier use of tall and stacked adapters



MODEL NO.

78620 SUBARU BALL JOINT PULLER

- Designed for easy use with vehicle on jack stands using a deep 24mm socket and impact or hand wrench
- Or use included 5/8-18 thread adapter with any common slide hammer



MODEL NO.

78830 HEAVY DUTY HUB DRUM AND ROTOR PULLER KIT

- Use with impact wrench to remove hubs, drums and brake rotors
- Use with 1-1/4" or 32mm socket and wrench



MODEL NO.

78825 MASTER FRONT WHEEL DRIVE BEARING ADAPTER KIT

- Includes heavy duty Grade 8 drive bolt for twice the durability of the industry standard



MODEL NO.

78822 GM HEAVY DUTY TORSION BAR UNLOADING TOOL

- Forged alloy design with 1" hex drive bolt
- Needed to service torsion arm and front suspension on many 2010 and older GM vehicles including GMC and Oldsmobile



ALSO AVAILABLE WITH LATE GM MODEL

MODEL NO.

78823



FUEL SYSTEM & COOLING



MODEL NO.

78585

UNIVERSAL RADIATOR PRESSURE TESTER & VACUUM TYPE COOLING SYSTEM KIT

- Allows easy testing for leakage in radiator system and quick change of coolant
- Unit is suitable for domestic and import vehicles



MODEL NO.

78835

EXHAUST PIPE STRETCHER KIT

- Impact driven Heavy-Duty expander allows for fitting smaller exhaust piping and making exhaust seals
- The drive size 28mm and collet sets expand pipes from 1-5/8" to 4-1/4"

MODEL NO.
7856
AIR COOLING TESTER



- Regulates shop air pressure to test and locate cooling system leaks, test caps, or speed up the coolant draining process
- Quick connector works on nearly all brands of cooling system testing caps and adapters



MODEL NO.

7824

BEARING RACE AND SEAL DRIVER MASTER SET

- Makes it easier to insert wheel bearing race and seals without damage to race and axle housing



MODEL NO.

78930

16PC. MASTER DISCONNECT KIT

- A complete Fuel & Transmission Line Disconnect Set in a handy blow-molded case
- Separate fittings on fuel lines, fuel filters & fuel tank return lines

MODEL NO.
78618
18PC. BRAKE CALIPER WIND BACK TOOL SET

- Designed for push back and wind back brake pistons
- Left and right-handed thrust bolts for a wide range of applications



MODEL NO.
78868
8PC. 12-POINT AXLE NUT SOCKET SET

- Designed for an exact fit on both 6pt and 12pt axle nuts
- Extra deep precision broached and forged from CR-MO with lasting finish



MODEL NO.
7848
8PC. PROFESSIONAL BRAKE TOOL SET

- Master Drum Brake set for nearly all vehicle applications with drum brake designs
- Different sized spring compressors for small to large sized drum brake applications



MODEL NO.
78810
10PC. TORQUE LIMITING EXTENSION SET

- Accurately torque wheel nuts to recommended torque
- Save time securing wheel to vehicle, finish with torque wrench



MODEL NO.
78818
8PC. TORQUE LIMITING EXTENSION AND PROTECTIVE IMPACT SOCKET COMBO SET

- Lug Nut sockets feature protective sleeves and inserts to prevent wheel damage
- Color coded for quick reference

JACKS & HYDRAULIC PRESS

HYDRAULIC



MODEL NO.
AJ22FE2A
22 TON CAPACITY
AIR OVER JACK
W/ QUICK SPRINGS
(2PC HANDLE)

MODEL NO.
5302A
20 TON AIR/MANUAL
BOTTLE JACK



MODEL NO.
5304A
20 TON LOW PROFILE
AIR/MANUAL BOTTLE JACK



MODEL NO.
5820
ENGINE
TRANSVERSE BAR
W/ SUPPORT ARM



MODEL NO.
500HWA
1/2 TON CAPACITY
TELESCOPING
TRANSMISSION JACK



MODEL NO.
1102
2 TON UNDER HOIST
TRIPOD STAND



MODEL NO.
1175
3/4 TON UNDER
HOIST STAND



BEST WHEN USED IN CONJUNCTION WITH

MODEL NO. **1822**
Astro
1/2" Nano Impact Wrench

MODEL NO. **1838**
3/8" Nano Right Angle Impact

1/2" DRIVE NANO IMPACT SOCKETS

MODEL NO. **78211** **11** SAE
PIECE



MODEL NO. **78215** **15** METRIC
PIECE



3/8" DRIVE NANO IMPACT SOCKETS

MODEL NO. **78310** **10** SAE
PIECE



MODEL NO. **78314** **14** METRIC
PIECE



- ✔ **OUTSIDE HEX**
 All sockets feature an outside hex for increased access when used with a wrench.
- ✔ **FORGED CR-MO**
 With superior material thickness between socket body and drive compared to competitors' sets.
- ✔ **SHORTER THAN ANYTHING ELSE ON THE MARKET**
 Sockets are 37% shorter than shallow impact sockets and 15% shorter than other stubby impact sockets.



MODEL NO. **94410T** **10** **3/8" DRIVE NANO**
PIECE **IMPACT TORX BIT SOCKETS**

- Includes sizes ranging from small brake disc locating screws to large truck bed bolts: T25, T27, T30, T40, T45, T47, T50, T55, T60 and T70
- Low profile design is 26% shorter allowing for more direct transfer of impacts and increased durability, or add an extension for longer reach



MODEL NO. **94418H** **18** **3/8" DRIVE NANO**
PIECE **IMPACT HEX DRIVER SOCKETS**
SAE & METRIC

- Includes Metric: 6, 7, 8, 10, 12, 14, 17, 18, 19mm and SAE: 1/4", 5/16", 3/8", 7/16", 1/2", 9/16", 5/8", 11/16" and 3/4"
- Low profile design for more direct transfer of impacts, tighter spaces and increased durability, or add an extension for longer reach



**FORGED S2
TOOL STEEL**

MODEL NO. **78340** **8** **3/8" DRIVE NANO PINLESS**
PIECE **UNIVERSAL IMPACT SOCKETS - SAE**

- Includes pinless universal impact sockets in the following sizes: 5/16", 3/8", 7/16", 1/2", 9/16", 5/8", 11/16", 3/4"



MODEL NO. **78344** **10** **3/8" DRIVE NANO PINLESS**
PIECE **UNIVERSAL IMPACT SOCKETS - METRIC**

- Includes pinless universal impact sockets in the following sizes: 10mm, 11mm, 12mm, 13mm, 14mm, 15mm, 16mm, 17mm, 18mm, 19mm



✔ Pinless design allows a full 360° of freedom for the universal head to angle and rotate

✔ Astro's Nano form factor, up to 11% shorter than standard low-profile universal impact sockets

FLANK BITE TECHNOLOGY

TRADITIONAL

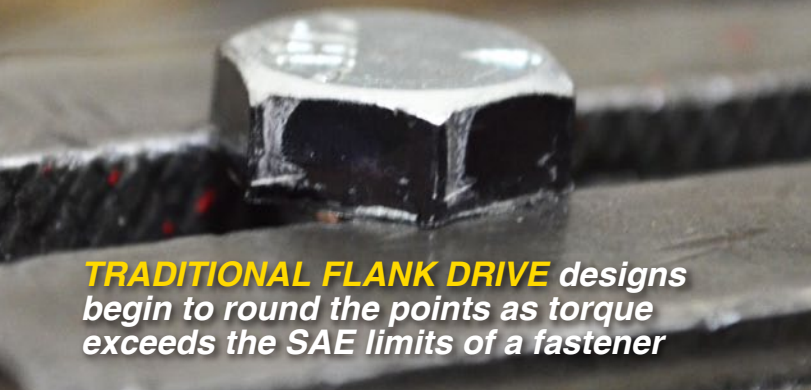

TRADITIONAL FLANK DRIVE designs begin to round the points as torque exceeds the SAE limits of a fastener

FLANK BITE



FLANK BITE does not depend on the points of a fastener. The more torque is applied, the more it bites into only the sides

- New, Patented Flank Bite Design works on up to an industry leading 90% stripped bolt heads and rounded lug nuts
- All products made in Taiwan from forged CRO-MO
- Safe for forward tightening of fasteners without damage

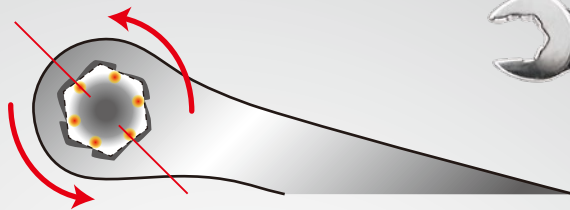

MODEL NO.
7181XL

8PC. EXTRA LONG DAMAGED FASTENER FLANK BITE COMBINATION WRENCH SET - METRIC



ALSO AVAILABLE IN SAE
MODEL NO. 7180XL

MODEL NO. **7404** **FLANK BITE DAMAGED LUG NUT SOCKET SET W/ SPINNING PROTECTIVE SLEEVES**



★ PATENTED ★ NO.USD570169S

MODEL NO. **7411** **11PC. 1/2" DR FLANK BITE DAMAGED FASTENER IMPACT SOCKETS - SAE**



ALSO AVAILABLE IN METRIC
MODEL NO. 7411M

★ PATENTED ★ NO.USD570169S

SOCKETS & CHISEL SETS



3/8" DRIVE FLEX SOCKET SET 6 POINT



MODEL NO.

74307

SAE (7 PCS)

- Includes sizes:
3/8", 7/16", 1/2", 9/16",
5/8", 11/16", 3/4"



MODEL NO.

74310

METRIC (10 PCS)

- Includes sizes:
10, 11, 12, 13, 14, 15,
16, 17, 18, 19mm

1/4" DRIVE FLEX SOCKET SET 6 POINT

MODEL NO.

7407

SAE (7 PCS)

- Includes sizes:
3/16", 1/4", 5/16", 3/8",
7/16", 1/2" and 9/16"

MODEL NO.

7412

METRIC (12 PCS)

- Includes sizes:
5, 5.5, 6, 7, 8, 9, 10,
11, 12, 13, 14, 15mm



MODEL NO.

1600 16PC. PUNCH AND
CHISEL SET

- 16 of the most popular cold chisels and taper, pin and center punches
- Product material: CR-V



MODEL NO.

1612 12PC. LARGE COLD
CHISEL AND PUNCH SET

- High Rockwell hardness, but low enough to prevent chipping and cracking from heavy hammering

7" 4PC. INTERNAL/EXTERNAL CR-V SNAP RING PLIERS



MODEL NO.

94220 - .050"

MODEL NO.

94221 - .067"

- Black & Polished Finish with Dipped Handles
- Internal and External straight and 90 degree bent pliers

MODEL NO.

94222

13" 4PC. INTERNAL/EXTERNAL SNAP RING PLIERS

- Includes Internal and External straight and 90 degree bent pliers with a 0.90" (2.3 mm) tip size
- Made from hardened Chrome Vanadium with black and polished finish and dipped non-slip handles



MODEL NO.

9401

10PC. SNAP RING PLIERS SET

- Operates both internal and external snap rings
- Heat treated Chrome-Vanadium

MODEL NO.

9507

WHEEL WEIGHT HAMMER PLIERS

- 10-inch 7-in-1 Design
- Hidden Spring Mechanism
- Made From Precision Forged CR-V



PLIERS & HOSE REMOVAL



MODEL NO. **9409A HOSE CLAMP PLIERS**

- New cable adjuster and multiple gear lock provide accurate and secure locking for any clamp position between minimum and maximum range

MODEL NO. **94093 MULTI-CABLE HOSE CLAMP PLIERS**

- Featuring 3 cables and 4 different jaw types and sizes for use on most automotive tension hose clamps



- Includes the standard jaws from Astro's 9409A, extra large and small jaws, and Clic-R clamp jaws

MODEL NO. **78515 ADJUSTABLE ANGLE OIL FILTER PLIERS**

- Jaws are adjustable angle allowing use of the wrench pliers from multiple points of access
- Indents every 30° for 180° of total adjustment



MODEL NO. **9502 2PC. HOSE REMOVAL HOOK SET**

- Two hook designs to fit between various fittings and hoses
- Works great when paired with Astro's 9409A Hose Clamp Pliers



MODEL NO.

3018

3.5" DIGITAL TIRE INFLATOR WITH HOSE

- **New** 21" Stainless braided hose for increased durability
- New dual AAA battery powered design. 4X the battery life and simplified battery installation



BEND GUARD

MODEL NO.

7445 45PC. TIRE REPAIR TOOL KIT



MODEL NO.

3081 DIAL GAUGE TIRE INFLATOR

- Aluminum die-casting unit covered with rubber sleeve for extra comfort and durability



Takes up to 200 psi from the compressor, reads up to 65 psi from the tire

MODEL NO.

3082 TPMS DIAL TIRE W/ STAINLESS HOSE 0-65 PSI

- Extreme accuracy. Up to 260% more accurate than the ANSI standard



MODEL NO.

3083 2.5" DIAL TIRE INFLATOR W/ LOCKING & DUAL CHUCKS

- Gauge is up to 2X the accuracy of the B40.1 ANSI standard with larger 2.5" diameter face for finer resolution and easier to see readings

MODEL NO.

7760

CORDLESS CIRCUIT TESTER

- Does not require ground wire or clip and is safe with ECMs, Sensors, Transducers, Airbags, etc.
- Special designed V-Tip needle allows safe piercing and prevents side-slipping when piercing wire's insulation. V-Tip can be removed to test hard to reach places



MODEL NO.

7767

DIGITAL LCD WIDE RANGE POSITIVE AND GROUND CIRCUIT TESTER



- Large back-lit digital display for clear accurate readings
- Extra wide 4-60V range, 0.1V resolution

MODEL NO.

8330

HEAVY DUTY PLASTIC 2 SHELF UTILITY CART - BLACK COLOR

- Trays are 3 1/2" deep and can hold up to 300lbs
- For shop, office, warehouse or medical facility use



MODEL NO.

7661

DUAL VOLUME CONTROL ELECTRONIC SAFETY EARMUFFS



- Each side has independent power and volume control
- No exposed wiring for increased durability and ideal for easy storage

MODEL NO.

7449

20" TIRE IRON SPOON LEVER

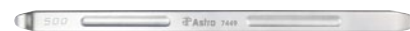

- Popular 20" (500mm) length with forged long lasting construction
- A must have for any tire repair or service center



MODEL NO. **9477** **7PC. PROFESSIONAL QUICK INTERCHANGEABLE RATCHET CRIMPING TOOL SET**

- Quick changing jaw design does not require any other tool to change the jaws
- Ergonomically designed steel frame handles with contoured rubber grips

MODEL NO. **9479** **6PC. PROFESSIONAL DEUTSCH RATCHETING CRIMPING TOOL SET**

- Includes jaws for 10~20 AWG Deutsch connectors including: Size 12 (DTP), Size 16 (DT) and Size 20 (DTM)
- Crimps terminal and insulation in one step



MODEL NO. **9475** **450PC. AUTOMOTIVE WIRE CONNECTOR KIT**

- Includes 450pcs of the most common insulated and non-insulated terminals and connectors used on automotive and general wiring applications



MODEL NO. **9476** **209PC. WEATHER PACK SEALED CONNECTOR WIRING KIT**

- Includes 208 weatherpack pieces and 1 Terminal Release Tool for building 1, 2, 3 & 4 pin Delphi Weatherpack terminals



MODEL NO. **9478** **220PC. WEATHER PACK INTERCHANGEABLE RATCHETING CRIMPING TOOL & ACCESSORY SET**

- Includes two different jaws sets for a wide range of Delphi Packard style connectors
- Wide range of accessories for repairing or building your own weatherpack connectors

MODEL NO. **78410** **ADJUSTABLE BLIND INNER BEARING
SLIDE HAMMER PULLER**

- For bearings and bushings with 0.75 - 2.3" inside diameter or up to 2.0" when pulling from outside diameter
- 2.5 lbs sliding hammer, 5.9 lbs total weight



MODEL NO. **78415** **LOCKING PLIERS
SLIDE HAMMER PULLER**

- Universal puller for locking onto and hammering to remove everything from cotter pins to old seals and bushings
- Quick detachable swivel end allows for adjusting and locking pliers on subject then attaching sliding hammer for removal



MODEL NO. **45027**
27PC. SCRAPER SET

- Includes 7 different types and sizes of razor and non-marring scrapers for nearly all light to heavy-duty applications



MODEL NO. **45080**
**8PC. DOOR PANEL &
TRIM REMOVAL
TOOL SET**

- Includes 8 different types of pry and trim tools for nearly all clips, trim panels and fasteners



MODEL NO. **45070**
**7PC. WINDSHIELD
MOLDING REMOVAL
TOOL SET**

- Includes all of the specialized tools required to safely and quickly remove windshields for a large variety of vehicles

MODEL NO. **78610 BRAKE CALIPER SPREADER PRESS**



- Gearless design includes FWD/REV switch and does not require ratcheting
- Suitable for 1, 2 and 4 piston calipers

MODEL NO. **78935 UNIVERSAL FUEL TANK LOCK WRENCH**



- Needed to remove fuel tank locking rings on fuel senders for many 2004 and newer vehicles
- Applications include GM/Chrysler/Dodge, Ford, BMW, Hyundai, Jaguar, Mercedes, Nissan, Subaru, Saab, Volvo and more



MODEL NO. **9472 162PC. BUTANE MICRO PENCIL HEAT-SHRINK TORCH KIT**

- 2-in-1 gas powered pencil heat gun and soldering iron
- Use with tip to solder, or remove tip for heating



MODEL NO. **9473 8PC. BUTANE MICRO PENCIL SOLDERING KIT**

- 3-in-1 soldering iron/torch/hot blower with 5 accessories (chisel tip, anvil tip, flat tip, solder and cleansing sponge)
- 30W-70W equivalent electrical power



**PENCIL TORCH
ALSO AVAILABLE
INDIVIDUALLY**

MODEL NO. **9471**